

**B-SERIES MINI EXCAVATORS
CX15B | CX18B**

CASE
CONSTRUCTION



**EFFICIENT.
POWERFUL. MINI.**

www.casece.com

**EXPERTS FOR THE REAL WORLD
SINCE 1842**

B-SERIES MINI EXCAVATORS



EXPERTS FOR THE REAL WORLD SINCE 1842

- 1842** Jerome Increase founded Racine Threshing Machine Works in Racine, Wisconsin, USA.
- 1912** Case manufactures road building equipment.
- 1969** Case begins skid steer loader production.
- 1988** Case recognized by Fortune magazine: listed by Fortune magazine among the "100 Products America Makes Best."
- 1995** Case expands attachment offering: co-branding and supply agreements with several key attachment suppliers.

HERITAGE

A TRADITION OF INDUSTRY FIRSTS



- 1997** *Start of Case mini assembly in Manchester.*
- 2005** *Increased production capacity in larger CNH plant (Imola).*
- 2008** *Renewal of models below 2ton (both conventional and SR).*
- 2011** *Case leads Tier 4 solutions. Long Enters Hall of Fame: Case engineer, “father of the loader/backhoe”, is inducted into the Construction Equipment Hall of Fame.*
- 2015** *Case extends its European product line-up with the new grader range.*

B-SERIES MINI EXCAVATORS



PRECISION AND CONTROLLABILITY

with the responsive hydraulic system

- CX15B features two highly efficient variable displacement piston pumps that deliver power on demand, reducing fuel consumption and increasing performance.
- CX18B has an additional gear pump for the swing and rotation circuits. When these functions are not used, the flow is automatically re-routed to boost digging.
- Both models excel in smoothness and precision at work.

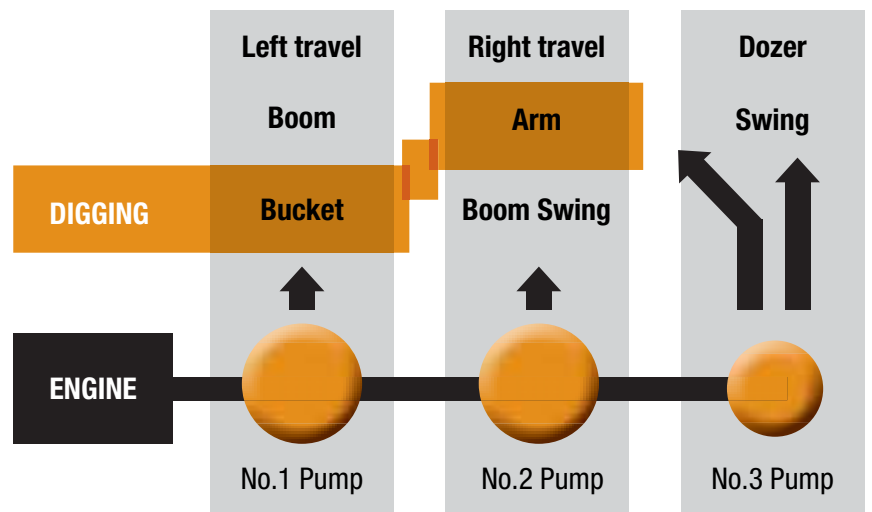

HIGH RELIABILITY

Superior strength

- The X-frame undercarriage provides superior strength and excellent stability.
- The cast iron boom foot is designed to withstand hard working conditions and deliver consistently excellent boom performance over time.
- The boom lift cylinder is well protected.

X-Frame design

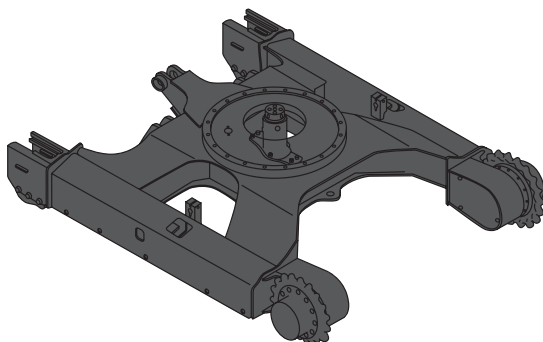

Boom cylinder protection

Cast iron boom foot



POWER ON DEMAND TO WORK IN ALL CONDITIONS



EXCELLENT WORKING RANGE

with customizable long and short arms

- Ample boom swing angles (left 80°, right 45°) make side ditch digging easy and safe.
- Long and short dippersticks available:
 - Dig deeper and farther with the long arm.
 - Maximise digging force and machine stability with the short arm.

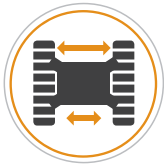

VARIABLE TRACK GAUGE

to access narrowest spaces

The tracks on the CX18B are easy to retract, enabling access through very narrow passages, and then extend again to increase stability allowing to work in comfort and safety.



Retracted tracks to access confined spaces



Extended tracks to increase stability while working



B-SERIES MINI EXCAVATORS



OUTSTANDING STABILITY

with the centered boom design

The center swing boom design ensures maximum machine balance while assuring outstanding robustness and reliability.



HIGH VISIBILITY

Cab design focused on operators line of sight

- The 3-pillar design of canopy versions maximises cab accessibility and all round visibility.
- On cab versions the huge glazed area provides superior visibility to front, side and rear.

POWER ON DEMAND TO WORK SAFELY



SAFE AND EASY MAINTENANCE

Grouped service points under the hood

The fully removable side panels together with the resistant «telene» rear hood provide easy and quick access to battery, hydraulic valves and all regular service components.

MAIN REASONS TO CHOOSE THE B-SERIES



EXCELLENT WORKING RANGE

- Long and short dipper sticks available
- Ample boom swing angles



PRECISION AND CONTROLLABILITY

- Integrated flow pump system
- Ergonomic and smooth pilot controls



HIGH VERSATILITY

- Standard auxiliary hydraulics
- Mono or bi-directional hydraulic oil flow
- 300 to 500 mm buckets
- Easy to transport



ROLL-AWAY BLADE

- Unique «roll-away» blade
- Blade foldable without wrenches



OUTSTANDING STABILITY

- Center swing boom for better machine balance



HIGH VISIBILITY

- 3-post canopy design
- Fully glazed cab option



COMFORTABLE AND SAFE CAB

- Unique tilt-adjustable arm rests
- Suspension seat option



SAFE AND EASY MAINTENANCE

- Fully removable side panels
- Easy access to battery, hydraulic valves and all regular service components



HIGH RELIABILITY

- X-frame undercarriage
- Lift cylinder protection
- Cast iron boom foot

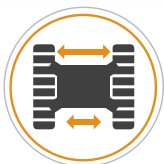

VARIABLE TRACK GAUGE

- Hydraulically retractable tracks (on CX18B)



B-SERIES MINI EXCAVATORS



HIGH VERSATILITY

Wide range of attachments

- Standard auxiliary hydraulics to feed hammers, augers or other hydraulic attachments.
- Single and dual directional auxiliary hydraulics can be supplied with quick connect fittings on the dipper arm.
- 300 to 500 mm buckets available from factory
- Easy to transport: CASE minis feature lifting points and tie-down rings to facilitate transportation.



ROLL-AWAY BLADE

Efficient back-filling

Unique «roll-away» blade for quick and efficient trench back-filling.

Convenient blade folding

On CX18B when the tracks are extended the blade is folded out; when they are retracted tracks, the blade can easily be folded in without the need of any wrenches.



COMFORTABLE AND SAFE CAB

Spacious cab with suspended seat

- CASE minis feature unique tilt-adjustable arm rests that increase operator comfort while reducing operator fatigue.
- The suspension seat option is available on both models.

**POWER ON DEMAND
TO WORK CONVENIENTLY**



B-SERIES **MINI EXCAVATORS**





B-SERIES MINI EXCAVATORS

SPECIFICATIONS

ENGINE

Model _____	CX15B CX18B
Displacement (cm ³) _____	MITSUBISHI L3E-31KBSA
Power (hp) _____	952
Power (kW) _____	15
Max torque (Nm) _____	11
Emissions level _____	53.5
	Not regulated in EU (Tier IV interim in USA)

HYDRAULIC SYSTEM

Variable displacement pumps type _____	Axial piston
Flow delivery (l/min) _____	2 x 15.5
Maximum operating pressure (bar) _____	206 216
Gear pump delivery (l/min) _____	- 10.9
1 st Auxiliary Flow (l/min) _____	31 26.4
2 nd Auxiliary Flow (l/min) _____	N.A.

SLEWING & TRAVEL SPEED

Slewing speed (rpm) _____	CX15B CX18B
Boom slewing angle (left/right) _____	9.5 9.0
Travel Speed - Low (1st) (km/h) _____	80° - 45°
Travel Speed - High (2nd) (km/h) _____	2.0
	3.5

SERVICE CAPACITIES

Fuel tank (l) _____	19.5
Cooling system (l) _____	3.5
Engine oil (l) _____	3
Hydraulic oil tank (l) _____	12.3

CAB PROTECTION

FOPS (Falling Objects Protection Structure) _____	Standard
TOPS (Tipping Over Protection Structure) _____	Standard

OPERATING WEIGHT

with: - operator
- full fuel tank
- bucket

DIPPER	mm	CX15B	CX18B
		1020 (Standard)	
Cab	ton	1.70	1.78
Canopy	ton	1.58	1.66

LIFTING CAPACITY

Lifting capacity at 1.5 meters
from swing center

			CX15B	CX15B	CX18B	CX18B
			Canopy	Cab	Canopy	Cab
Ground level	1020 mm	ton	0.45	0.52	0.49	0.56
	1220 mm	ton	0.45	0.52	0.48	0.55
2 m below ground	1020 mm	ton	0.37	0.37	0.40	0.40
	1220 mm	ton	0.45	0.49	0.49	0.49

Values refer to a machine outfit including 0.044 m³ bucket

TRANSPORT FEATURE

with: - full fuel tank

DIPPER	mm	CX15B	CX18B
		1020 (Standard)	
Weight (Cab)	ton	1.59	1.67
Weight (Canopy)	ton	1.47	1.55
Max width	mm	990	990 - 1330
Max length	mm	3605	3605
Max height	mm	2350	2350

SPECIFICATIONS

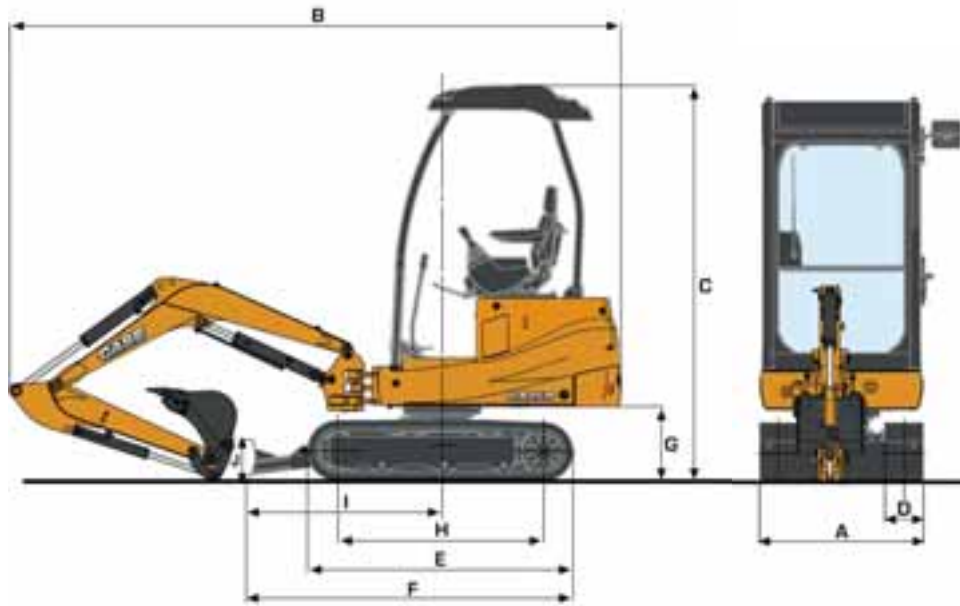

GENERAL DIMENSIONS

with Canopy Or Cab

DIPPER	mm	CX15B	CX18B
		1020 / 1220	1020 / 1220
Rear end swing radius	mm	1065	1065
A Max width	mm	990	990 - 1330
B Max length	mm	3605 / 3620	3605 / 3620
C Max height	mm	2350	2350
D Track width	mm	230	230
E Undercarriage length	mm	1566	1566
F Undercarriage length with blade	mm	1928	1928
G Height to uppercarriage	mm	444	444
H Center distance of tumblers	mm	1215	1215
I Blade radius on ground	mm	1155	1155
J Blade height	mm	245	245

DIGGING PERFORMANCES

with Canopy Or Cab

DIPPER	mm	CX15B	CX18B
		1020 / 1220	1020 / 1220
Bucket thickness	mm	450	450
Dipperstick Breakout force	kN	8.4	8.7
Bucket Breakout force	kN	13.3	14.0
K Max digging depth	mm	2200 / 2400	2200 / 2400
L Min front slew radius (Cab/Canopy)	mm	1530 / 1560	1530 / 1560
M Max reach	mm	3800 / 3990	3800 / 3990
N Max dump height (Cab/Canopy)	mm	2470 / 2600	2470 / 2600
O Max digging height (Cab/Canopy)	mm	3550 / 3675	3550 / 3675
P Blade max lifting	mm	210	210
Q Blade max lowering	mm	310	310

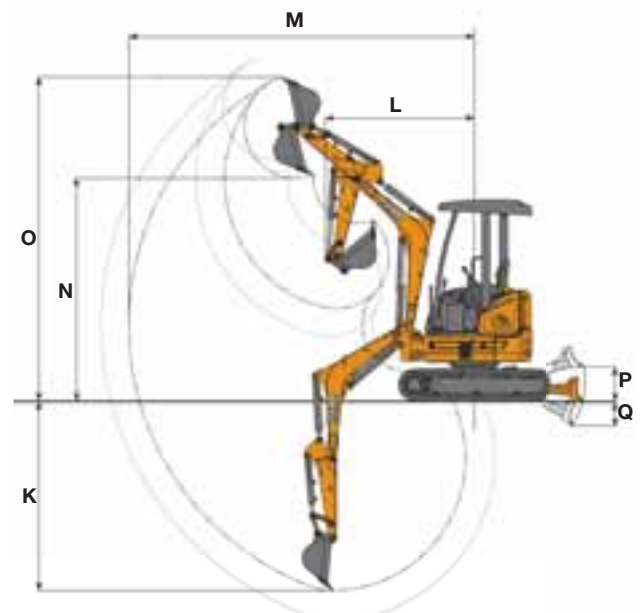

www.casece.com
EXPERTS FOR THE REAL WORLD
SINCE 1842

CASE
CONSTRUCTION



Form No. 20089GB - Printed in Italy - MediaCross Firenze - 12/15

**CNH INDUSTRIAL
DEUTSCHLAND GMBH**
Case Baumaschinen
Benzstr. 1-3 - D-74076 Heilbronn
DEUTSCHLAND

CNH INDUSTRIAL FRANCE, S.A.
16-18 Rue des Rochettes
91150 Morigny-Champigny
FRANCE

CNH INDUSTRIAL - UK
First Floor, Barclay Court 2,
Heavens Walk,
Doncaster - DN4 5HZ
UNITED KINGDOM

CNH INDUSTRIAL - SOUTH AFRICA
Waterfall Business Park
Bekker Street, Howick Close
1685 Midrand - Johannesburg
REPUBLIC OF SOUTH AFRICA

**CNH INDUSTRIAL
MAQUINARIA SPAIN, S.A.**
Avda. José Gárate, 11
28823 Coslada (Madrid)
ESPAÑA

CNH INDUSTRIAL ITALIA SPA
Strada di Settimo, 323
10099 San Mauro Torinese (TO)
ITALIA

**CASE CUSTOMER CENTRE
PARIS**
RN 330 - Penchard
77122 - Monthyon
FRANCE

CNH INDUSTRIAL - MIDDLE EAST
DAFZA - Dubai Airport Free Zone
West Wing 4 B, Office 642
P.O. Box 54588, Dubai,
UNITED ARAB EMIRATES

NOTE: Standard and optional fittings can vary according to the demands and specific regulations of each country. The illustrations may include optional rather than standard fittings - consult your Case dealer. Furthermore, CNH Industrial reserves the right to modify machine specifications without incurring any obligation relating to such changes.

Conforms to directive 2006/42/EC

CASE Customer Assistance
00800-2273-7373

The call is free from a land line.
Check in advance with your Mobile Operator if you will be charged. Toll free number not available from all calling areas.

