

# SKID STEER LOADER

# CASE

CONSTRUCTION

SINCE 1842.

## SR150B

### ENGINE

Brand	Perkins
Model	404D-22T
Type	4-stroke, turbocharged, Tier 3/MAR-1 certified
Cylinders	4
Bore x Stroke	84 mm x 100 mm (3.31" x 3.94")
Displacement	2,216 cm <sup>3</sup> (135.23 in <sup>3</sup> )
Fuel injection	Indirect
Fuel	Diesel
Fuel filter	In-line filter
Air inlet	Turbocharged with internal EGR
Cooling system	Liquid
Speed (rpm)	
High - no load	3,140 ± 40
Rated - full load	2,900
Low - no load	1,200 ± 30
Power at 2,900 rpm	
Gross SAE J1349	60 hp (44.7 kW)
Net SAE J1349	57 hp (42.4 kW)
Maximum torque at 1,800 rpm	171 N.m (126.12 lbf.ft)

### ENGINE COOLING SYSTEM

Radiator	
Core type	Fully aluminum
Core area	0.257 m <sup>2</sup>
Row of tubes	43
Pressure on the lid	1.1 ± 0.1 bar (16 ± 2 psi)
Fan	
Diameter	450 mm (17.7")
Ratio	0.89:1
Water pump	
Type	Centrifuge
Flow	57.7 l/min (15.2 gpm)

Engine lubrication	
Pump Operational Angles	
Side by side	35°
Raised bucket	35°
Lowered bucket	35°
Oil filtration	Full flow cartridge, disposable

### POWERTRAIN

Drive Pump - Mechanical	
Pump / motor ratio	1:1
Displacement	35 cm <sup>3</sup> (2.14 in <sup>3</sup> )
Pump flow rate with motor at rated rotation	98 l/min (25.9 gpm)
Flow	Integral
Charging pressure	24.5 ± 0.5 bar (360 ± 10 psi)
System relief pressure	345 + 17.3 bar (5000 + 250 psi)
Control	Mechanical
Drive pump	Electro-Hydraulic
Pump/motor ratio	1:1
Displacement	35 cm <sup>3</sup> (2.14 in <sup>3</sup> )
Pump flow rate with motor at rated rotation	95 l/min (25.1 gpm)
Integral Flow	
Charging pressure	24.5 ± 1 bar (362 ± 15 psi)
System relief pressure	360 ± 10 bar (5220 ± 145 psi)
Control	Electro-hydraulic
Traction engines	Fixed displacement with radial pistons
Maximum displacement	325 cm <sup>3</sup> (19.83 in <sup>3</sup> )
Speed at rated motor rotation	313 rpm
Torque at full flow	1783 Nm (1315 lbf pie)
Displacement speed	12.7 km/h (7.9 mph)
Final reduction	Hydrostatic with chain-to-wheel final drive
Drive chain	
Size	ASA #80
Tensile strength	93.4 kN (21,000 lbf)

Axles	
One-piece carbon steel forged and subjected to induction hardening treatment	
Maximum torque at full flow and relief pressure	5,940 N.m (4,381 lbf.ft)
Diameter	50.8 mm (2")
Length	346 mm (13.2")

Parking break	
Type	Multiple Discs - Spring Application, Hydraulic Release

Actuation	Application of the parking brakes by actuating the brake knob on the hand control or on the instrument panel, by raising the safety bar of the operator's seat, when the operator rises from the seat or by switching off the engine
-----------	--

### HYDRAULIC SYSTEM

Standard pump	
Type	Gear pump
Displacement	20.4 cm <sup>3</sup> (1.24 in <sup>3</sup> )
Pump flow at rated motor rotation	59 l/min (15.6 gpm)
Skid Steer control valve	
3 spools / Open Center / In-line	
Relief pressure	210 ± 5 bar (3046 ± 72.5 psi)
Relief pressures	
Arm lift	225 +10/-5 bar (3263 +145/-73 psi)
Bucket discharge	260 +10/-5 bar (3770 +145/-73 psi)
Bucket retraction	80 +10/-5 bar (1160 +145/-73 psi)
Hydraulic oil cooler	
Flaps numbers	3.94 per centimeter
Number of tubes	9
Area	880 cm <sup>2</sup> (136.5 in <sup>2</sup> )

## INSTRUMENT PANEL

### Indicators

Text indicators Hour meter, engine rotation, engine cooling fluid temperature, or hydraulic oil temperature  
 LCD bar chart for hydraulic oil temperature, engine cooler temperature, and fuel level in fuel tank

### Warning lights with alarms

Immediate stop  
 Motor malfunction  
 Hydraulic system malfunction  
 Malfunction of the electronic system

### Indicator lights

Warning to lower the security bar  
 Parking brake indicator activated  
 Engine preheating light

## ELECTRIC SYSTEM

Alternator	120 A
Starting motor	2.0 kW
Battery	12 V, 950 CCA for cold cranking at -18 °C (0 °F)

## OPERATOR ENVIRONMENT

ROPS / FOPS cab with side screens

Controls locking system

Tilting ROPS / FOPS frame

Rear window with emergency exit

Instrument panel

Retractable seat belt

Manual and foot throttle

Alarm package

Cabin roof lining

Solar roof

Cup holder

Power outlet

Foot rest

Storage tray

Ergonomic low effort manual controls

Padded safety bar with integrated armrest

Loader controls locking system

Electric parking brake control

Rubber mat for floor protection / cleaning

## CYLINDERS

### Lift cylinder

Cylinder diameter	57.2 mm (2.25")
Stem diameter	34.9 mm (1.375")
Stroke	645 mm (25.4")
Closed length	989 mm (38.9")

### Bucket cylinders

Cylinder diameter	57.2 mm (2.25")
Stem diameter	31.7 mm (1.25")
Stroke	370 mm (14.57")
Closed length	594 mm (23.38")

## OPERATIONAL WEIGHTS

### Operational weight

2,430 kg (5,370 lb)

### Transport weight

2,300 kg (5,070 lb)

### Cabin side windows

21.3 kg (47 lb)

### Lexan®Door

34 kg (75 lb)

### Glass door with windshield wiper

34 kg (75 lb)

### Suspension seat

10 kg (22 lb)

## SERVICE CAPACITIES

### Fuel tank

60.5 l (16 gal)

### Engine oil (with filter)

7.1 l (7.5 gal qt)

### Hydraulic system

#### Storage

15.1 l (4 gal)

### Storage for chains

(on each side)

6.25 l (6.6 qt)

## TIRE SELECTION

	Size	Overall width
Galaxy XD 2002 (10x16.5 Heavy Duty (59 OTW))	10x16.5	1,625 mm (64")
TWEEL All Terrain (10X16.5 TWEEL 64 OTW )	10x16.5	1,625 mm (64")

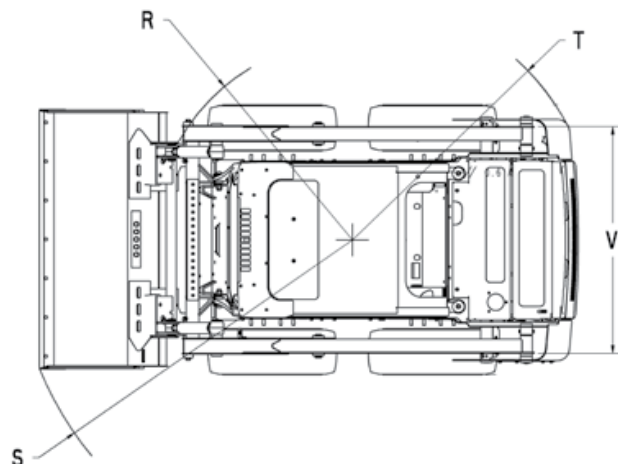
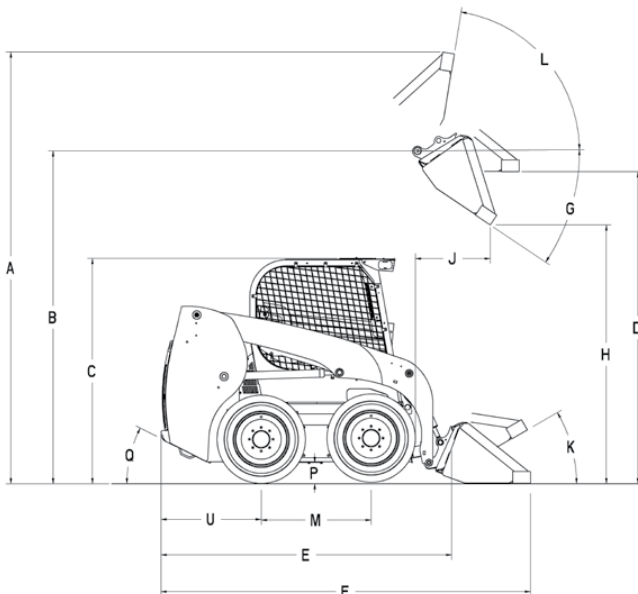

## DIMENSIONS

<b>A.</b> Total operational height:	
With foundry / excavation bucket	3.59 m (141.4")
With low profile extended bucket	3.86 m (152")
Height up to:	
<b>B.</b> Bucket hinge pin	2.85 m (112")
<b>C.</b> Cabin top	1.92 m (75.5")
<b>D.</b> Leveled bucket bottom with fully raised loader arm	2.68 m (105.6")
Total length:	
<b>E.</b> Without accessories, with coupling device	2.44 m (95.9")
<b>F.</b> With foundry / excavation bucket at ground level	3.03 m (119.2")
With low-profile extended bucket at ground level	3.30 m (129.8")
<b>G.</b> Dump angle at maximum height	40.2°
<b>H.</b> Dump height - fully raised loader arm	
With foundry / excavation bucket	2.25 m (88.4")
With low profile extended bucket	2.07 m (81.6")
<b>J.</b> Reach - fully raised loader arm with low-profile extended bucket	0.47 m (18.5")
Attachment maximum retraction angle:	
<b>K.</b> Bucket at ground level	26.1°
<b>L.</b> Bucket at maximum height	95.2°
<b>M.</b> Wheelbase	0.94 m (37")
<b>P.</b> Ground clearance (bottom of protection plate)	0.18 m (7")
<b>Q.</b> Output angle	22°
Front turning radius:	
<b>R.</b> Without the bucket	1.24 m (48.8")
<b>S.</b> With foundry / excavation bucket at ground level	1.86 m (73.3")
With low-profile extended bucket at ground level	2.11 m (83.1")
<b>T.</b> Rear turning radius	1.43 m (56.4")
<b>U.</b> Rear axle to bumper	0.86 m (33.8")
<b>V.</b> Machine gauge, measure between the wheel centers	1.25 m (49.2")

## SPECIFICATIONS

Operational load	680 kg (1,500 lb)
Dump load	1,361 kg (3,000 lb)
Tear force	
Lifting arm	14.1 kN (3,160 lbf)
Bucket	18.6 kN (4,180 lbf)
Cycle times (in seconds)	
To raise arms	3.5
To lower arms	2.2
To unload attachment	2.0
To retract attachment	1.4

## OPTIONAL BUCKETS

Type	Width m (in)	Weight kg (lb)	Heaped capacity m <sup>3</sup> (yd <sup>3</sup> )
Foundry / excavation	1,83 (72)	190 (420)	0,46 (0,60)
	1,49 (58)	178 (392)	0,40 (0,52)
Extended low profile	1,68 (66)	214 (470)	0,45 (0,59)
	1,83 (72)	232 (510)	0,50 (0,65)
Heavy Duty	1,83 (72)	230 (510)	0,40 (0,52)

## STANDARD EQUIPMENT

### Operator environment

ROPS / FOPS cab with side screens  
Controls locking system  
Tilting ROPS / FOPS frame  
Rear window with emergency exit  
Instrument panel  
Retractable seat belt  
Manual throttle  
Alarm package  
Cabin roof lining  
Cup holder  
Power outlet  
Foot rest  
Storage tray  
Ergonomic low effort manual controls  
Padded safety bar with integrated armrest  
Controls locking system of the loader  
Electric parking brake control  
Rubber mat for floor protection / cleaning

### Loader

Loader arm radial design  
Mechanical device of attachment coupling  
Lift arm support beam of the loader

### Engine

Perkins 404D-22T  
Integrated oil cooling system of the engine  
Fuel filter with water separator  
Dual element air filter.  
120 A alternator  
12V 950 CCA battery  
Glow plug  
Overlapped oil heat exchanger and radiator  
Spark-arresting silencers

### Power train

Hydrostatic four-wheel drive  
Servo controls  
ASA #80HS Drive chain  
SAHR parking disc brakes

### Hydraulic system

210 bar hydraulic system (3,046 psi)  
59 l/min (15.6 gpm)  
Hydraulic circuit pedal lock  
ISO flat face couplers mounted on loader arm  
Cancellation of auxiliary functions  
Operational blocking system of the loader  
Loader lift neutralizer  
Loader 3-spool control valve  
Oil exchanger for severe applications  
Loader arm fluctuation position

### Others

Lockable maintenance access hood  
Single point daily maintenance  
Halogen lights, 2 frontal, 2 lateral, 2 rear  
Rear lights  
Harnesses for options  
Remote oil drain

## OPTIONAL EQUIPMENT

### Operator environment

Suspension seat *Deluxe* coated with special fabric, with lumbar support and heating system  
76mm retractable seat belt (3")  
Internal mirror  
Bluetooth radio  
Air conditioning and heating  
Door for demolition purposes  
Front auxiliary electric control  
Front glass door with windshield wiper and washer  
Sliding side windows

### Loader



*Ride Control*  
Attachment coupling hydraulic device  
One-way hydraulic self-leveling (climb)  
Crankcase drain pipe fittings

### Engine

Engine block heater

### Others

*Deluxe* Dashboard  
Headlights for highway traffic  
Giroflex  
Lifting hooks  
Special paint  
Stickers  
Factory installed tires – refer to page 2  
Buckets – refer to page 3  
Bolt-on bucket cutting blades  
Forks to 1.22 m (48")  
Additional counterweights

  Fleet management and monitoring system by satellite or cell phone tracking.

CASE Corporation reserves the right to make design improvements or feature changes at any time without obligation to install them on previously sold units. Features, descriptions, and illustrative materials included in this document, accurately reflect known data until the date of publication, although they are subject to changes without notice. Illustrations may include optional equipment and accessories and may not include all standard equipment.

CCEIO149 - 12/2022 - Printed in Brazil

**CaseCE.com**

**CNI** | CAPITAL  
INDUSTRIAL

### Sales Offices

ARGENTINA  
Ávalos 2829 Edif. 1 Piso 4º,  
Complejo Urbana  
Vicente López (1605) Bs. As., Argentina.  
Phone: 54 (11) 2034 1400

### Manufacturing plants

BRAZIL  
Contagem – Minas Gerais – Brazil  
Av. General David Sarnoff, 2.237  
Inconfidentes – C.P. 32210-900  
Phone: +55 31 2104-3392  
Sorocaba – São Paulo – Brazil  
Av. Jerome Case, 1.801  
Éden – C.P. 18087-220  
Phone: +55 15 3334-1700