

# SKID STEER LOADER

# CASE

CONSTRUCTION

SINCE 1842.

## SR150B

### ENGINE

Brand	Perkins
Model	404D-22T
Type	4-stroke, turbocharged, Tier 3/MAR-1 certified
Cylinders	4
Bore x Stroke	84 mm x 100 mm (3.31" x 3.94")
Displacement	2,216 cm <sup>3</sup> (135.23 in <sup>3</sup> )
Fuel injection	Indirect
Fuel	Diesel
Fuel filter	In-line filter
Air inlet	Turbocharged with internal EGR
Cooling system	Liquid
Speed (rpm)	
High - no load	3,140 ± 40
Rated - full load	2,900
Low - no load	1,200 ± 30
Power at 2,800 rpm	
Gross SAE J1995	60 hp (44.7 kW)
Net SAE J1349	57 hp (42.4 kW)
Maximum torque at 1,800 rpm	171 N.m (126.12 lbf.ft)

### ENGINE COOLING SYSTEM

Radiator	
Core type	Fully aluminum
Core area	0.257 m <sup>2</sup>
Row of tubes	43
Pressure on the lid	1.1 ± 0.1 bar (16 ± 2 psi)
Fan	
Diameter	450 mm (17.7")
Ratio	0.89:1
Water pump	
Type	Centrifuge
Flow	57.7 l/min (15.2 gpm)

Engine lubrication	
Pump Operational Angles	
Side by side	35°
Raised bucket	35°
Lowered bucket	35°
Oil filtration	Full flow cartridge, disposable

### POWERTRAIN

Drive Pump - Mechanical	
Pump / motor ratio	1:1
Displacement	35 cm <sup>3</sup> (2.14 in <sup>3</sup> )
Pump flow rate with motor at rated rotation	98 l/min (25.9 gpm)
Flow	Bidirectional
Charging pressure	25 bar (363 psi)
System relief pressure	345 bar (5,000 psi)
Control	Mechanical
Traction engines	Fixed displacement with radial pistons
Maximum displacement	325 cm <sup>3</sup> (19.83 in <sup>3</sup> )
Speed at rated motor rotation	313 rpm
Torque at full flow and relief pressure	1,784 N.m (1,316 lbf.ft)
Displacement speed	12.7 km/h (7.9 mph)
Final reduction	Chain drive with single reduction
Drive chain	
Size	ASA #80
Tensile strength	93.4 kN (21,000 lbf)

Axles	
One-piece carbon steel forged and subjected to induction hardening treatment	
Maximum torque at full flow and relief pressure	5,940 N.m (4,381 lbf.ft)
Diameter	50.8 mm (2")
Length	346 mm (13.2")

Parking break	
Type	Spring applied, hydraulic disc release
Actuation	Application of the parking brakes by actuating the brake knob on the hand control or on the instrument panel, by raising the safety bar of the operator's seat, when the operator rises from the seat or by switching off the engine

### HYDRAULIC SYSTEM

Standard pump	
Type	Gear pump
Displacement	20.4 cm <sup>3</sup> (1.24 in <sup>3</sup> )
Pump flow at rated motor rotation	59 l/min (15.6 gpm)
Skid Steer control valve	
3 spools / Open Center / In-line	
Relief pressure	210 bar (3,046 psi)
Relief pressures	
Arm lift	225 bar (3,263 psi)
Bucket discharge	260 bar (3,770 psi)
Bucket retraction	80 bar (1,160 psi)
Hydraulic oil cooler	
Flaps numbers	3.94 per centimeter
Number of tubes	9
Area	880 cm <sup>2</sup> (136.5 in <sup>2</sup> )
Hydraulic filter	6 microns / Threaded

## INSTRUMENT PANEL

Indicators	
Digital hour meter;	
LCD fuel level bar graph with low level alarm	
Warning lights with alarms	
High engine coolant temperature	
Low engine oil pressure	
Engine malfunction.	
Low hydraulic charging pressure	
Hydraulic oil filter restriction	
High hydraulic oil temperature	
Alert alarms	
Low battery voltage (including indicator light)	
Indicator lights	
Engine pre-heating	
Parking break	
Notice to place the safety bar	

## ELECTRIC SYSTEM

Alternator	120 A
Starting motor	2.0 kW
Battery	12 V, low maintenance, 925 CCA for cold cranking at -18 °C (0 °F)

## OPERATOR ENVIRONMENT

ROPS / FOPS cab with side screens
Controls locking system
Tilting ROPS / FOPS frame
Rear window with emergency exit
Instrument panel
51 mm retractable seat belt (2")
Manual and foot throttle
Alarm package
Cabin roof lining
Solar roof
Cup holder
Power outlet
Foot rest
Storage tray
Ergonomic low effort manual controls
Padded safety bar with integrated armrest
Loader controls locking system
Electric parking brake control
Rubber mat for floor protection / cleaning

## CYLINDERS

Lift cylinder	
Cylinder diameter	57.2 mm (2.25")
Stem diameter	34.9 mm (1.375")
Stroke	645 mm (25.4")
Closed length	989 mm (38.9")
Bucket cylinders	
Cylinder diameter	57.2 mm (2.25")
Stem diameter	31.8 mm (1.25")
Stroke	370 mm (14.6")
Closed length	594 mm (23.4")

## OPERATIONAL WEIGHTS

Operational weight	2,430 kg (5,370 lb)
Transport weight	2,300 kg (5,070.63 lb)
Cabin side windows	21.3 kg (47 lb)
Lexan® Door	34 kg (75 lb)
Glass door with windshield wiper	34 kg (75 lb)
Suspension seat	10 kg (22 lb)

## SERVICE CAPACITIES

Fuel tank	60.5 l (16 gal)
Engine oil (with filter)	7.1 l (7.5 gal qt)
Hydraulic system	
Storage	15.13 l (4 gal)
Storage for chains (on each side)	6.25 l (6.6 qt)

## TIRE SELECTION

	Size	Overall width
Galaxy XD 2002 (10x16.5 Heavy Duty (59 OTW))	10x16.5	1,627 mm (5' 4")
TWEEL All Terrain (10X16.5 TWEEL 64 OTW )	10x16.5	1,627 mm (5' 4")

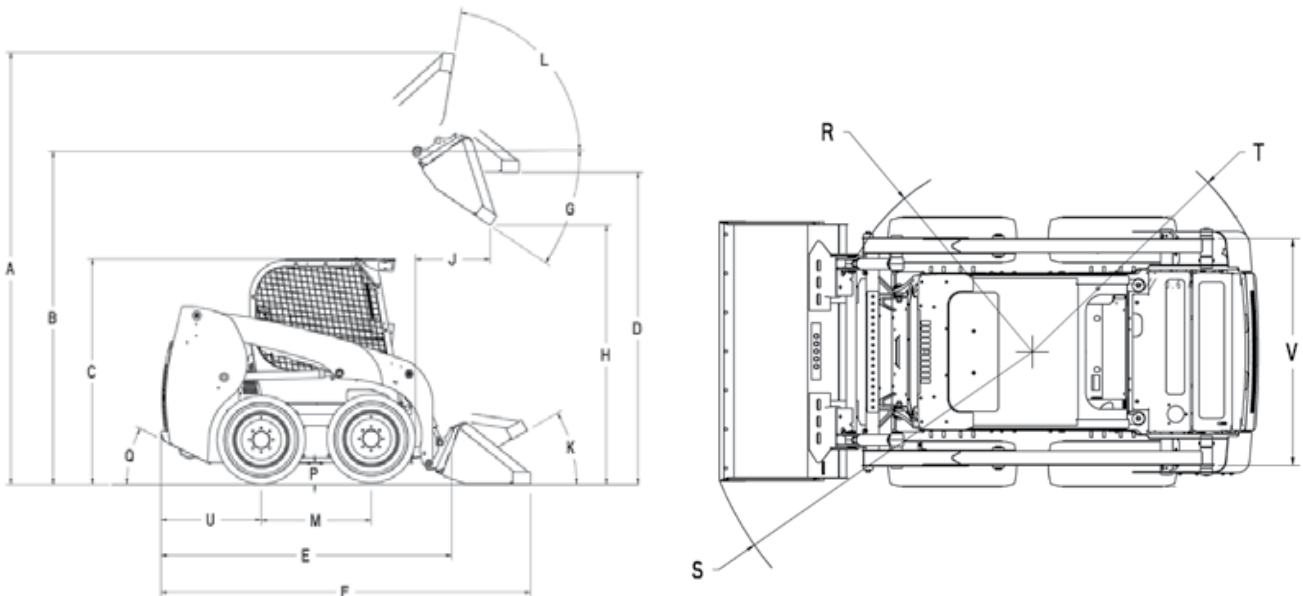

## DIMENSIONS

<b>A. Total operational height:</b>	
With foundry / excavation bucket	3.59 m (141.4")
With low profile extended bucket	3.86 m (152")
Height up to:	
<b>B. Bucket hinge pin</b>	2.85 m (112")
<b>C. Cabin top</b>	1.92 m (75.5")
<b>D. Leveled bucket bottom with fully raised loader arm</b>	2.68 m (105.6")
Total length:	
<b>E. Without accessories, with coupling device</b>	2.44 m (95.9")
<b>F. With foundry / excavation bucket at ground level</b>	3.03 m (119.2")
With low-profile extended bucket at ground level	3.30 m (129.8")
<b>G. Dump angle at maximum height</b>	40.2°
<b>H. Dump height - fully raised loader arm</b>	
With foundry / excavation bucket	2.25 m (88.4")
With low profile extended bucket	2.07 m (81.6")
<b>J. Reach - fully raised loader arm with low-profile extended bucket</b>	0.47 m (18.5")
Attachment maximum retraction angle:	
<b>K. Bucket at ground level</b>	26.1°
<b>L. Bucket at maximum height</b>	95.2°
<b>M. Wheelbase</b>	0.94 m (37")
<b>P. Ground clearance (bottom of protection plate)</b>	0.18 m (7")
<b>Q. Output angle</b>	22°
Front turning radius:	
<b>R. Without the bucket</b>	1.24 m (48.8")
<b>S. With foundry / excavation bucket at ground level</b>	1.86 m (73.3")
With low-profile extended bucket at ground level	2.11 m (83.1")
<b>T. Rear turning radius</b>	1.43 m (56.4")
<b>U. Rear axle to bumper</b>	0.86 m (33.8")
<b>V. Machine gauge, measure between the wheel centers</b>	1.25 m (49.2")

## SPECIFICATIONS

Operational load	680 kg (1,500 lb)
with optional counterweight	726 kg (1,600 lb)
Dump load	1,361 kg (3,000 lb)
with optional counterweight	1,451 kg (3,200 lb)
Tear force	
Lifting arm	14.1 kN (3,160 lbf)
Bucket	18.6 kN (4,180 lbf)
Cycle times (in seconds)	
To raise arms	3.5
To lower arms	2.2
To unload attachment	2.0
To retract attachment	1.4

## OPTIONAL BUCKETS

Type	Width m (in)	Weight kg (lb)	Heaped capacity m <sup>3</sup> (yd <sup>3</sup> )
Foundry / excavation	1,83 (72)	190 (420)	0,46 (0,60)
Extended low profile	1,68 (66)	214 (470)	0,45 (0,59)
	1,83 (72)	232 (510)	0,50 (0,65)
Heavy Duty	1,83 (72)	230 (510)	0,40 (0,52)

## STANDARD EQUIPMENT

### Operator environment

ROPS / FOPS cab with side screens  
Controls locking system  
Tilting ROPS / FOPS frame  
Rear window with emergency exit  
Instrument panel  
51 mm retractable seat belt (2")  
Manual and foot throttle  
Alarm package  
Cabin roof lining  
Solar roof  
Cup holder  
Power outlet  
Foot rest  
Storage tray  
Ergonomic low effort manual controls  
Padded safety bar with integrated armrest  
Controls locking system of the loader  
Electric parking brake control  
Rubber mat for floor protection / cleaning

### Loader

Loader arm radial design  
Mechanical device of attachment coupling  
Lift arm support beam of the loader

### Engine

Perkins 404D-22T  
Integrated oil cooling system of the engine  
Fuel filter with water separator  
Dual element air filter.  
120 A alternator  
12V 925 CCA battery  
Glow plug  
Overlapped oil heat exchanger and radiator  
Spark-arresting silencers

### Power train

Hydrostatic four-wheel drive  
Servo controls  
ASA #80HS Drive chain  
SAHR parking disc brakes

### Hydraulic system

210 bar auxiliary hydraulic system (3,046 psi)  
59 l/min (15.6 gpm)  
Hydraulic circuit pedal lock  
ISO flat face couplers mounted on loader arm  
Cancellation of auxiliary functions  
Operational blocking system of the loader  
Loader lift neutralizer  
Loader 3-spool control valve  
Oil exchanger for severe applications  
Loader arm fluctuation position

### Others

Lockable maintenance access hood  
Single point daily maintenance  
Halogen lights, 2 frontal, 2 lateral, 2 rear  
Rear lights  
Harnesses for options  
Remote oil drain

## OPTIONAL EQUIPMENT

### Operator environment

Suspension seat *Deluxe* coated with special fabric, with lumbar support and heating system  
76mm retractable seat belt (3")  
Internal mirror  
Bluetooth radio  
Air conditioning and heating  
Door for demolition purposes  
Front auxiliary electric control  
Front glass door with windshield wiper and washer  
Sliding side windows

### Loader

*Ride Control*  
Attachment coupling hydraulic device  
One-way hydraulic self-leveling (climb)  
Crankcase drain pipe fittings

### Engine

Engine block heater

### Others

*Deluxe* Dashboard  
Headlights for highway traffic  
Giroflex  
Lifting hooks  
Special paint  
Stickers  
Factory installed tires – refer to page 2  
Buckets – refer to page 3  
Bolt-on bucket cutting blades  
Forks to 1.07 m (42") and 1.22 m (48") 1,22 m (48")  
Battery disconnect key  
Steel tracked  
Additional counterweights



**SiteWatch™**

Fleet management and monitoring system by satellite or cell phone tracking.

CASE Corporation reserves the right to make design improvements or feature changes at any time without obligation to install them on previously sold units. Features, descriptions, and illustrative materials included in this document, accurately reflect known data until the date of publication, although they are subject to changes without notice. Illustrations may include optional equipment and accessories and may not include all standard equipment.

CCEI0068 - 03/2021 - Printed in Brazil

**CaseCE.com**

**CNI** | CAPITAL  
INDUSTRIAL

### Sales Offices

ARGENTINA  
Ávalos 2829 Edif. 1 Piso 4º,  
Complejo Urbana  
Vicente López (1605) Bs. As., Argentina.  
Phone: 54 (11) 2034 1400

### Manufacturing plants

BRAZIL  
Contagem – Minas Gerais – Brazil  
Av. General David Sarnoff, 2.237  
Inconfidentes – C.P. 32210-900  
Phone: +55 31 2104-3392  
Sorocaba – São Paulo – Brazil  
Av. Jerome Case, 1.801  
Éden – C.P. 18087-220  
Phone: +55 15 3334-1700