

SKID STEER LOADER

CASE

CONSTRUCTION

SINCE 1842.

SV300B

ENGINE

Brand	FPT
Model	ISM N844LT / M3
Type	4-stroke, turbocharged with Tier 3 certified
Cylinders	4
Bore x Stroke	99 x 104 mm (3.9 x 4.1")
Displacement	3,195 cm ³ (195 in ³)
Fuel injection	Diesel
Fuel	Diesel
Fuel filter	In-line filter
Air inlet	Turbocharged with internal EGR
Cooling system	Liquid
Motor speed (rpm)	
High - no load	2,675 ± 75
Rated - full load	2,500
Low - no load	1,070 ± 75
Power at 2,500 rpm	
Gross SAE J1995	90 hp (67 kW)
Net SAE J1349	84 hp (63 kW)
Maximum torque at 1,400 rpm	340 N.m (251 lbf.ft)

ENGINE COOLING SYSTEM

Radiator	
Core type	Fully aluminum
Core area	0.266 m ²
Row of tubes	44
Pressure on the lid	1.1 ± 0.1 bar (16 ± 2 psi)
Fan	
Diameter	518 mm (20.4")
Ratio	0.96:1
Water pump	
Type	Centrifuge
Flow	110 l/min (29 gpm)
Engine lubrication	
Pump Operational Angles	
Side by side	45°
Raised bucket	35°
Lowered bucket	45°
Oil filter	Full flow cartridge

POWERTRAIN

Drive Pump - Mechanical	
Pump / motor ratio	1:1
Displacement	46 cm ³ (2.81 in ³)
Pump flow rate with rated motor rotation	111 l/min (29.4 gpm)
Charging pressure	24.5 bar (360 psi)
System relief pressure	360 bar (5,220 psi)
Control	Mechanical
Drive pump - Electrohydraulic (EH)	
Pump / motor ratio	1:1
Displacement	45 cm ³ (2.75 in ³)
Pump flow rate with rated motor rotation	109 l/min (28.8 gpm)
Charging pressure	25 bar (363 psi)
System relief pressure	360 bar (5,220 psi)
Control	Electrohydraulic
Traction engines	
Maximum displacement	470 cm ³ (28.68 in ³)
Speed at rated motor rotation	241 rpm
High speed - optional	355 rpm
Torque at full flow and relief pressure	2,694 N.m (1,987 lbf.ft)
Displacement speed	
Low	11.3 km/h (7.0 mph)
High (optional)	16.9 km/h (10.5 mph)
Final reduction	Chain drive with single reduction
Drive chain	
Size	ASA #100 HS
Tensile strength	133.4 kN (30,000 lbf)

Axles

Maximum torque at full flow and relief pressure	8,975 N.m (6,620 lbf.ft)
Diameter	62 mm (2.44")
Length	396 mm (15.6")

Parking break

Type	Spring applied, hydraulic disc release
Actuation	Application of the parking brakes by actuating the brake knob on the hand control or on the instrument panel, by raising the safety bar of the operator's seat, when the operator rises from the seat or by switching off the engine

HYDRAULIC SYSTEM

Standard pump	
Type	Gear pump
Displacement	
Standard	34.1 cm ³ (2.08 in ³)
Optional High Flow	18.3 cm ³ (1.1 pulg ³)
Pump flow at rated motor rotation	85 l/min (22.5 gpm)
Flow with optional High Flow at rated motor rotation	131 l/min (34.6 gpm)
Skid Steer control valve	
Type	3 spools / Open Center / In-line
Relief pressure	210 bar (3,046 psi)
Relief pressures	
Arm lift	225 bar (3,263 psi)
Bucket discharge	260 bar (3,770 psi)
Bucket retraction	80 bar (1,160 psi)
Hydraulic oil cooler	
Flaps numbers	3.94 per centimeter
Number of tubes	11
Area	843 cm ² (130.7 in ²)

INSTRUMENT PANEL

Indicators

Text indicators Hour meter, engine rotation, engine cooling fluid temperature, or hydraulic oil temperature

LCD bar chart for hydraulic oil temperature, engine cooler temperature, and fuel level in fuel tank

Warning lights with alarms

Immediate stop
Motor malfunction
Hydraulic system malfunction
Malfunction of the electronic system

Indicator lights

Warning to lower the security bar
Parking brake indicator activated
Engine preheating light

ELECTRIC SYSTEM

Alternator	120 A
Starting motor	3.2 kW
Battery	12 V, low maintenance, 950 CCA for cold cranking at -18 °C (0 °F)

OPERATOR ENVIRONMENT

ROPS / FOPS cab with side screens
Tilting ROPS / FOPS frame
Rear window with emergency exit
Instrument panel
Retractable seat belt
Manual throttle
Alarm package
Cabin roof lining
Solar roof
Cup holder
Power outlet
Foot rest
Storage tray
Ergonomic low effort manual controls
Padded safety bar with integrated armrest
Loader controls locking system
Electric parking brake control
Rubber mat for floor protection / cleaning
Suspension vinyl seat

CYLINDERS

Lift cylinder	
Cylinder diameter	69.9 mm (2.75")
Stem diameter	44.5 mm (1.75")
Stroke	847.9 mm (33.4")
Closed length	1196 mm (47.1")
Bucket cylinders	
Cylinder diameter	76.2 mm (3")
Stem diameter	38.1 mm (1.5")
Stroke	410 mm (1' 4.1")
Closed length	610 mm (2')

OPERATIONAL WEIGHTS

Operational weight	3,765 kg (8,300 lb)
Transport weight	3,610 kg (7,959 lb)
Cab side windows	21.3 kg (46.9 lb)
Lexan®Door	34.0 kg (75 lb)
Glass door with windshield wiper	34.0 kg (75 lb)
Suspension seat	10 kg (22 lb)

SERVICE CAPACITIES

Fuel tank	96.5 l (25.5 gal)
Engine oil (with filter)	9.5 l (10.0 gal qt)
Hydraulic system	
Storage	22.7 l (6 gal)
Storage for chains (on each side)	22.2 l (23.5 qt)

TIRE SELECTION

	Size	Overall width
Galaxy XD 2002 (12x16.5 Heavy Duty (70 OTW))	12x16.5	1,778 mm (5' 10")
TWEEL All Terrain (12X16.5 TWEEL 70 OTW)	12x16.5	1,778 mm (5' 10")
Galaxy Beef Baby III (14x17.5 Premium (76 OTW))	14x17.5	1,930 mm (6' 4")

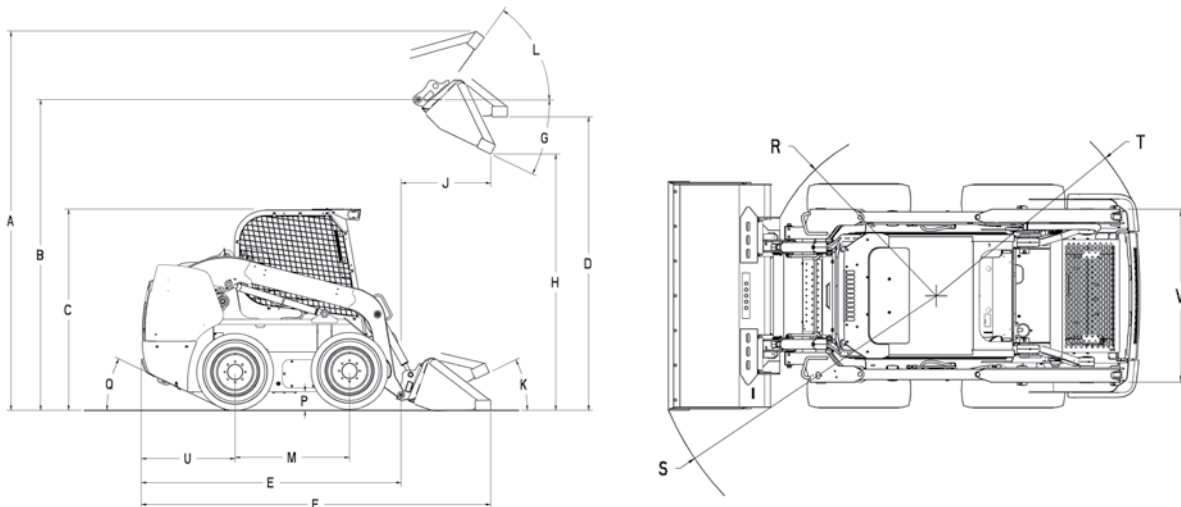

DIMENSIONS

A.	Total operational height:	
	With foundry bucket	4.07 m (13' 4")
	With low profile extended bucket	4.30 m (14' 1")
	Height up to:	
B.	Bucket hinge pin	3.30 m (10' 10")
C.	Cabin top	2.00 m (6' 6.7")
D.	Leveled bucket bottom with fully raised loader arm	3.04 m (10' 0")
	Total length:	
E.	Without accessories, with coupling device	2.99 m (9' 10")
F.	With foundry bucket at ground level	3.60 m (11' 9.7")
	With low-profile extended bucket at ground level	3.84 m (12' 7")
G.	Dump angle at maximum height	53.5°
H.	Dump height - fully raised loader arm	
	With foundry bucket	2.63 m (8' 7.5")
	With low profile extended bucket	2.47 m (8' 1")
J.	Reach - fully raised loader arm	0.84 m (2' 9")
	Attachment maximum retraction angle:	
K.	Bucket at ground level	35°
L.	Bucket at maximum height	86°
M.	Wheelbase	1.32 m (4' 4")
P.	Ground clearance (bottom of protection plate)	0.20 m (7.8")
Q.	Output angle	23.5°
	Front turning radius:	
R.	Without the bucket	1.42 m (4' 8")
S.	With foundry / excavation bucket at ground level	2.14 m (7' 0")
	With low-profile extended bucket at ground level	2.35 m (7' 8.5")
T.	Rear turning radius	1.79 m (5' 10.5")
U.	Rear axle to bumper	1.03 m (3' 4.5")
V.	Machine gauge, measure between the wheel centers	1.45 m (4' 9")

SPECIFICATIONS

Operational load	1,364 kg (3,000 lb)
Dump load	2,727 kg (6,000 lb)
Tear force	
Lifting arm	25.5 kN (5,730 lbf)
Bucket	33.7 kN (7,570 lbf)
Cycle times (in seconds)	
To raise arms	4.6
To lower arms	2.7
To unload attachment	2.7
To retract attachment	2.0

OPTIONAL BUCKETS

Type	Width m (in)	Weight kg (lb)	Heaped capacity m ³ (yd ³)
Foundry / excavation	1,83 (72)	190 (420)	0,46 (0,60)
	1,83 (72)	232 (510)	0,50 (0,65)
Extended low profile	1,98 (78)	245 (540)	0,54 (0,71)
	2,13 (84)	262 (575)	0,58 (0,76)
Heavy Duty	1,83 (72)	230 (507)	0,40 (0,52)

STANDARD EQUIPMENT

Operator Environment

ROPS / FOPS cabin with side screens
Tilting ROPS / FOPS frame
Rear window with emergency exit
Instrument panel
Suspension vinyl seat
Retractable seat belt
Manual and foot throttle
Alarm package
Cabin roof lining
Solar roof
Cup holder
Power outlet
Foot rest
Storage tray
Ergonomic low effort manual controls
Padded safety bar with integrated armrest
Loader controls locking system
Electric parking brake control
Rubber mat for protection / cleaning of the floor

Loader

Loader arm vertical design
Mechanical device of attachment coupling
Lift arm support beam of the loader

Engine

FPT F5CE5454C*A003 diesel
Integrated oil cooling system of the engine
Fuel filter with water separator
Dual element air filter
95 A alternator
12V 950 CCA battery
Glow plug
Overlapped oil heat exchanger and radiator
Spark-arresting silencers
Maintenance free chain

Power train

Hydrostatic four-wheel drive
Servo controls
ASA #100HS Drive chain
SAHR parking disc brakes

Hydraulic system

210 bar hydraulic system (3,046 psi)
85 l/min (22.5 gpm)
Hydraulic circuit pedal lock
ISO flat face couplers mounted on loader arm
Cancellation of auxiliary functions
Operational blocking system of the loader
Loader lift neutralizer
Loader 3-spool control valve
Oil exchanger for severe applications
Loader arm fluctuation position

Others

Lockable maintenance access hood
Single point daily maintenance
Halogen lights, 2 frontal, 2 lateral, 2 rear
Rear lights
Remote oil drain
2 speed drive
Heavy Duty rear door

OPTIONAL EQUIPMENT

Operator environment

Suspension seat *Deluxe* coated with special fabric, with lumbar support and heating system
retractable seat belt
Internal mirror
Radio
Air conditioning and heating
Door for demolition purposes
Front auxiliary electric control
Front glass door with windshield wiper and washer
Sliding side windows

Loader

Ride Control
Attachment coupling hydraulic device
One-way hydraulic self-leveling (climb)
Electrohydraulic controls (EH)

Hydraulic system

High flow hydraulic system (*High Flow*) of 210 bar (3,046 psi) 131 l/min (34.6 gpm)
Crankcase drain pipe fittings

Engine

Engine block heater
Battery disconnect key

Others

Deluxe Dashboard
Headlights for highway traffic
Giroflex
Lifting hooks
Special paint
Stickers
Factory installed tires – refer to page 2
Buckets – refer to page 3
Bolt-on bucket cutting blades
Forks to 1.22 m (48") pallets



Fleet management and monitoring system by satellite or cell phone tracking.

CASE Corporation reserves the right to make design improvements or feature changes at any time without obligation to install them on previously sold units. Features, descriptions, and illustrative materials included in this document, accurately reflect known data until the date of publication, although they are subject to changes without notice. Illustrations may include optional equipment and accessories and may not include all standard equipment.

CCEIO156 - 12/2022 – Printed in Brazil

CaseCE.com



Manufacturing plants

Contagem – Minas Gerais – Brazil
Av. General David Sarnoff, 2237
Inconfidentes – C. P. 32210-900
Phone.: +55 31 2104-3392

Sorocaba – São Paulo – Brasil
Av. Jerome Case, 1801
Éden – C. P. 18087-220
Phone: +55 15 3334-1700