

## OPERATING WEIGHT

Open Cab	2,646 lb (1 200 kg)
Enclosed Cab	N/A

## OVERALL DIMENSIONS

Overall Height	81.1 in (2 060 mm)
Overall Length: Without Bucket	89.2 in (2 265 mm)
Machine Width	36.2 in (920 mm)

## LOADER PERFORMANCE SPECS

Lifting Height	111.0 in (2 820 mm)
Tipping load (ISO) – Straight	See Graph Pg. 2
Lifting Capacity	See Graph Pg. 2

## ELECTRICAL

System Voltage	12 Volts
Alternator	40 amp
Battery	52 AHR 520 cold-cranking amps

## STANDARD EQUIPMENT

### OPERATOR ENVIRONMENT

ROPS/FOPS safety roof  
Safety entry bar  
Key start  
Non-suspension vinyl seat  
Armrests  
Retractable seat belt  
Exterior mirrors

### ENGINE

Glow plug starting aid  
Engine block heater  
Locking fuel cap

## OPTIONAL EQUIPMENT

### ENGINE

Hand throttle

### DRIVETRAIN

Hand inching creep control

## ENGINE

Model	Kubota D902
Emissions Certification	Tier 4 Final/Stage V
Cylinders	3
Displacement	54.8 in <sup>3</sup> (0.898 L)
Fuel	Diesel
Exhaust aftertreatment	N/A
Engine speeds Rated – full load	RPM 3600
Horsepower @ 3600 RPM – SAE J1349: Gross	25 hp (18.5 kW)
Peak torque @ 2600 RPM	41.4 lb-ft (56.1 N·m)

## DRIVETRAIN

Transmission Type	Hydrostatic
Differential Type	Hydraulic controlled
Parking brake: Type	Hydraulic multidisk brake
Max. Travel speed	9.3 mph (15 kph)

## DRIVETRAIN

Hydrostatic 4-wheel drive  
FNR control on joystick  
Electro-hydraulic controlled, manually  
activated differential  
Hydraulic parking brake

## HYDRAULICS

Extension/retraction of lift arm controlled  
by lever or joystick  
3-spool main control valve  
1x dual acting auxiliary hydraulics  
Attachment case drain return  
Loader arm float  
Hydraulic self-level function  
Oil cooler

## LOADER

Telescopic reach loader arm  
Loader lift arm support strut  
CII mechanical attachment coupler  
Additional counterweights

## HYDRAULICS

2x dual acting auxiliary hydraulics  
Auxiliary hydraulic hold function  
Continuous flow auxiliary hydraulics  
Hydraulic boom suspension (ride control)

## HYDRAULICS

Control Valve Type	Open Center
Pump Type	Fixed Gear
Driving Hydraulics: Flow Rate Operating Pressure	17.2 gpm (65 L/min) 5,100 psi (350 bar)
Working Hydraulics: Total Flow Rate Operating Pressure	7.4 gpm (28 L/min) 2,200 psi (150 bar)
Auxiliary 1: Max. Flow Rate Pressure	7.4 gpm (28 L/min) 2,200 psi (150 bar)
Auxiliary 2 – optional: Max. Flow Rate Pressure	7.4 gpm (28 L/min) 2,200 psi (150 bar)
Continuous Flow – optional: Max. Flow Rate Pressure	10.3 gpm (39 L/min) 2,200 psi (150 bar)

## SERVICE CAPACITIES

Fuel Tank	12.2 gal (46 L)
Engine oil w/ filter	2.6 qt (2.5 L)
Hydraulic system	12.7 gal (48 L)
Engine Coolant	1.1 gal (4.35 L)

## ELECTRICAL

12 volt system  
52 AHR, 520 CCA battery  
40 A alternator  
2 front cab work lights  
Remote jumpstart provision

## OTHER STANDARD FEATURES

Recovery Hook  
Lifting eyes  
Backup alarm  
Horn

## WARRANTY

Base warranty coverage: 2-Year / 1,000-Hour  
Full Machine Limited Warranty

## ELECTRICAL

1 boom worklight  
2 cab rear work lights  
3-pin electrical auxiliary connection  
Rotating beacon light

## OTHER

English, Spanish, or French Operator Manual  
Groundskeeper tool carrying kit

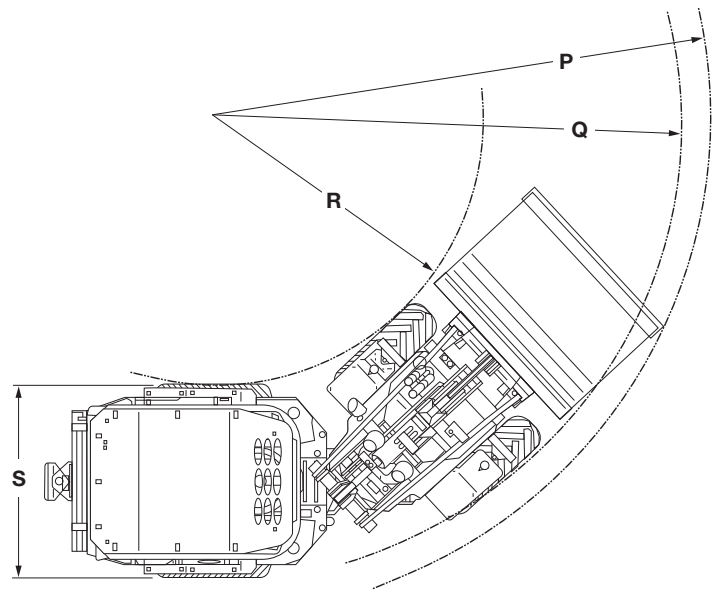
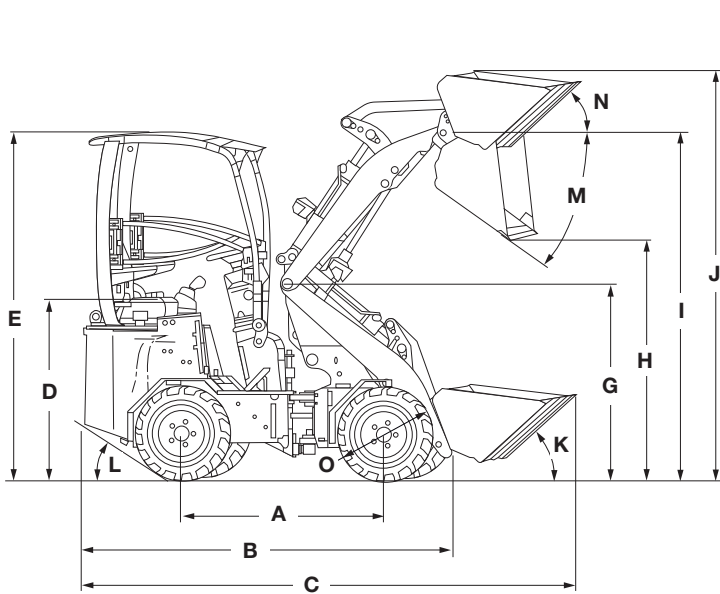

Line drawings are for illustrative purpose only and may not be exact representation of unit.

### DIMENSIONS

A. Wheelbase	49.1 in (1 247 mm)
B. Total length	89.2 in (2 265 mm)
C. Length with bucket	115.2 in (2 927 mm)
D. Seat height	40.2 in (1 020 mm)
E. Max. height with safety roof	81.1 in (2 060 mm)
F. Max. height with cabin	—
G. Height front frame	51.6 in (1 310 mm)
H. Max. dumping height	81.1 in (2 060 mm)
I. Lifting height	107.9 in (2 740 mm)
J. Height with bucket	129.9 in (3 300 mm)
K. Rollback angle on the ground	43°
L. Rollback angle at max. lift height	50°
M. Max. dumping angle	40°
N. Max. loading angle	34°
O. Outer size of tires	22.4 in (570 mm)
P. Maximum radius external	87.6 in (2 225 mm)
Q. Turning radius on outer edge	77.4 in (1 967 mm)
R. Inner turning radius	38.5 in (978 mm)
S. Width on standard tires	36.2 in (920 mm)

### TIPPING LOAD PATHS

T.	440 lb (200 kg)
U.	1,010 lb (460 kg)
V.	1,650 lb (750 kg)

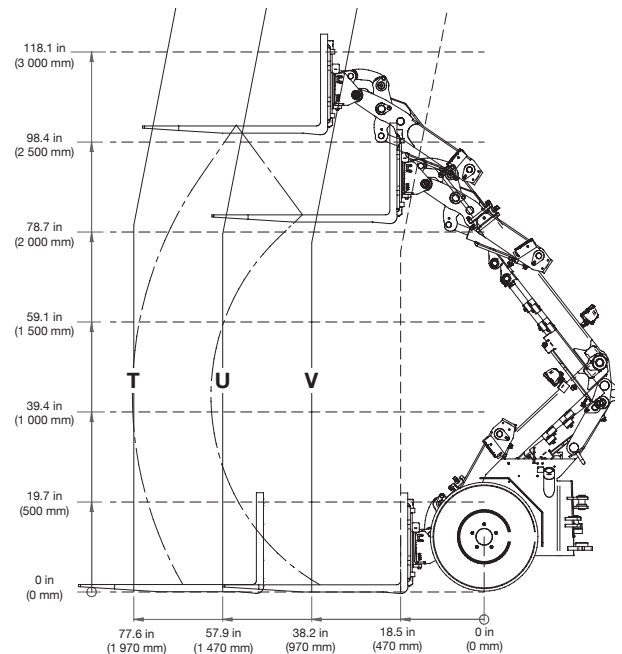

## CaseCE.com

©2023 CNH Industrial America LLC. All rights reserved. CASE is a trademark registered in the United States and many other countries, owned by or licensed to CNH Industrial N.V., its subsidiaries or affiliates. CNH Industrial Capital is a trademark in the United States and many other countries, owned by or licensed to CNH Industrial N.V., its subsidiaries or affiliates.

IMPORTANT: CASE Construction Equipment Inc. reserves the right to change these specifications without notice and without incurring any obligation relating to such change. Availability of some models and equipment builds vary according to the country in which the equipment is used. The illustrations and text may include optional equipment and accessories and may not include all standard equipment. Your CASE dealer/distributor will be able to give you details of the products and their specifications available in your area.



CASE Construction Equipment is biodiesel-friendly. NOTE: All engines meet current EPA emissions regulations. All specifications are stated in accordance with SAE Standards or Recommended Practices, where applicable.



Always read the Operator's Manual before operating any equipment. Inspect equipment before using it, and be sure it is operating properly. Follow the product safety signs and use any safety features provided.

Form No. CCE202310SL12TR  
Replaces Form No. CCE202307SL12TR

SL12 TR

2 of 2