

ENGINE

Model	Case 432T/M3 diesel*, Tier IV compliant
Type	4-stroke, turbocharged
Cylinders	4
Bore/Stroke	3.9 in x 4.1 in (99 mm x 104 mm)
Displacement	195 in ³ (3.2 L)
Fuel injection	Direct
Fuel	#2 Diesel
Fuel filter	In-line strainer
Air intake	Cross-flow
Cooling	Liquid
Engine speeds (rpm)	
High idle – no load	2675±75
Rated – full load	2500
Low idle	1075±75
Horsepower per SAE J1349	
Gross	74 (55 kw) @ 2500 rpm
Net	69 (52 kw) @ 2500 rpm
Peak torque	
@ 1400 rpm	203 lb-ft (275 N·m)

ENGINE COOLING

Radiator	
Core type	Square wave serpentine
Core size area	377 in ² (.243 m ²)
Rows of tubes	4
Cap pressure	14 psi (97 kPa)
Fan	
Diameter	18.9 in (480 mm)
Ratio	1.1:1
Water pump	
Style	Centrifugal
Flow	29 gpm (110 L/min)
Engine lubrication	
Pump	Deep sump with plate cooler and pressurized under-piston nozzles
Pump operating angle ratings	
Side-to-side	Rated 35°
Fore and aft	Rated 35°
Oil filtration	Replaceable, full-flow cartridge

POWERTRAIN

Drive pump	Tandem, axial piston hydrostatic transmission with integral charge pump driven directly off engine flywheel
Pump to engine ratio	1:1
Displacement	0 to 2.62 in ³ (42.9 cc)
Pump flow @ high idle engine rpm	30.3 gpm (115 L/min)
Flow	Bi-directional
Charge pressure	360 psi (24.8 bar)
System relief	4350 psi (300 bar)
Controls	Pilot
Drive motors	Fixed displacement radial piston
Maximum displacement	3.1 in ³ (50.8 cc)
Speed @ high idle engine rpm @ max displacement	2261 rpm
Torque @ max displacement and relief pressure	179 lb-ft (242 N·m)
Travel speed – mph (km/h)	
Low range	5.8 (9.3)
High range	8.4 (13.5)
Final drive	Double-reduction planetary
Undercarriage	
Torque @ max displacement and relief pressure	2640 lb-ft (3579 N·m)
Track adjustment	Hydraulic
Frame	Rigid
Length of track on ground	56.6 in (1438 mm)
Track rollers per side	3
Front idler diameter	13.7 in (350 mm)
Rear idler diameter	11.4 in (290 mm)
Bottom Rollers	
Outer flange diameter	7.8 in (200 mm)
Center flange diameter	8.4 in (214 mm)
Sprocket Teeth	
Number	17
Width	1.8 in (46 mm)
Track rollers and idlers sealed with duo cone face seals and permanently lubricated bushings	
Parking brakes	Spring applied, hydraulic release disc
Engagement	Depress on/off brake button on handle or instrument panel, raise seat bar, get off seat, or stop engine

HYDRAULIC SYSTEM

Standard equipment pump	
Type	Gear pump
Displacement	2.2 in ³ /rev (36 cc)
Pump flow @ rated engine rpm	
Total	23.8 gpm (90 L/min)
Optional high flow @ rated engine rpm	
Total	33.2 gpm (126 L/min)
Loader control valve	3-spool open-center series with power beyond port
Relief pressure	3050 psi (210 bar)
Port relief pressures	
Loader Raise	3120 psi (215 bar)
Bucket Dump	3800 psi (260 bar)
Bucket Curl	3350 psi (230 bar)
Hydraulic lines	
Tubing	37° JIC Flare
Loop hoses	SAE 100 R12
Hydraulic oil cooler	
Core type	Four row in-line
Hydraulic filter	6 micron spin on replaceable element on the return line with warning indicator

*Manufactured for Case by Iveco.

INSTRUMENTATION

Indicators	
Digital Hourmeter	
Fuel level LCD bar graph with alarm	
Warning lights with alarms	
Engine coolant temperature	
Engine oil pressure	
Engine Malfunction	
Hydraulic charge pressure	
Hydraulic filter restriction	
Hydraulic oil temperature	
Warning alarms	
Battery voltage (plus display)	
Indicator light	
Engine preheat	
Parking brake	
Seat bar reminder	

ELECTRICAL SYSTEM

Alternator	95 amp
Starter	2.7 kW
Battery	
12-volt low-maintenance 1125 cold-cranking amps @ 0° F (-18° C)	

OPERATOR ENVIRONMENT

ROPS/FOPS level 1 canopy w/side screens
Tilt ROPS/FOPS
Rear window w/ emergency escape
Instrument panels
Suspension vinyl seat
2 in (51 mm) retractable seat belt
Hand throttle
Foot throttle
Alarm package
Headliner
Top window
Cup holder
Power plug socket
Foot rest
Storage tray
Low effort ergonomic hand controls
Padded seat bar w/integral armrests
Loader control lockout system
Electric parking brake control
Floor cleanout panel

CYLINDERS

Lift cylinder	
Bore diameter	2.5 in (63.5 mm)
Rod diameter	1.5 in (38.1 mm)
Stroke	35.8 in (910 mm)
Closed length	46.8 in (1190 mm)
Bucket cylinder	
Bore diameter	2.75 in (69.9 mm)
Rod diameter	1.37 in (34.9 mm)
Stroke	14.6 in (370 mm)
Closed length	26.9 in (683 mm)

OPERATING WEIGHTS

Unit equipped with 12.6 in (320 mm) track, 66 in (1.67 m) foundry/excavating bucket, mechanical attachment coupler, full fuel tank and 165 lb (75 kg) operator	
	8340 lb (3783 kg)
Shipping weight	7690 lb (3488 kg)
Add-on weights	
Side cab glass	+70 lb (32 kg)
Glass door with wiper	+77 lb (35 kg)
Suspension seat	+10 lb (4.5 kg)

SERVICE CAPACITIES

Fuel tank	22.0 gal (83.3 L)
Engine oil w/filter	9 qt (8.5 L)
Engine cooling system	12 qt (11.4 L)
Hydraulic system	
Reservoir	7.1 gal (26.8 L)
Total	13.2 gal (50 L)

TRACK SELECTION

	Area in ² (cm ²)	Ground Pressure psi (kPa)	Width to Outside of Track in (mm)
12.6 in (320 mm)	1,424 (9187)	5.8 (40)	65 (1651)

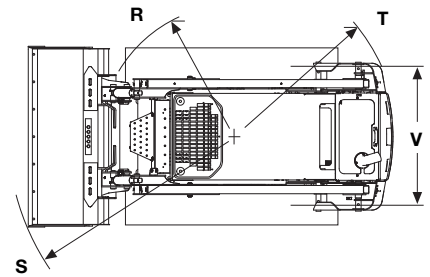
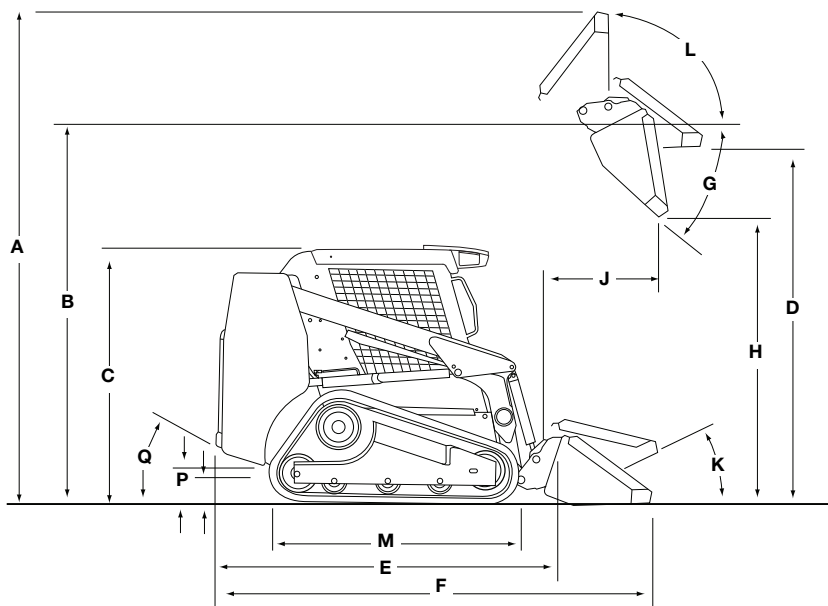

DIMENSIONS*

A. Overall operating height	
w/foundry/excavating bucket – short lip	153.2 in (3.89 m)
w/low profile bucket – standard lip	158.8 in (4.03 m)
w/low profile extended bucket – long lip	163.8 in (4.16 m)
Height to	
B. Bucket hinge pin	120.8 in (3.07 m)
C. Top of rollover protective structure	79.7 in (2.02 m)
D. Bottom of level bucket, loader arm fully raised	113.4 in (2.88 m)
Overall length	
E. w/o attachment w/coupler	102.5 in (2.60 m)
F. w/foundry/excavating bucket on ground	129.4 in (3.29 m)
F. w/low profile bucket on ground	132.9 in (3.38 m)
F. w/low profile extended bucket on ground	137.9 in (3.50 m)
G. Dump angle at maximum height	39°
H. Dump height – loader arm fully raised*	
w/foundry/excavating bucket	95.1 in (2.42 m)
w/low profile bucket	91.6 in (2.33 m)
w/low profile extended bucket	88.4 in (2.24 m)
J. Dump reach – loader arm fully raised	
w/foundry/excavating bucket	24.6 in (0.63 m)
w/low profile bucket	29.1 in (0.74 m)
w/low profile extended bucket	32.9 in (0.84 m)
Maximum attachment rollback	
K. Bucket on ground	29°
L. Bucket at full height	96°
M. Length of track on ground	56.6 in (1.40 m)
Ground clearance*	
P. Bottom of belly pan	8.4 in (213 mm)
Q. Angle of departure*	32°
Clearance circle front*	
R. Less bucket	53.6 in (1.36 m)
S. w/66 in (1.68 m) foundry/excavating bucket on ground	80.7 in (2.05 m)
S. w/66 in (1.68 m) low profile bucket on ground	84.4 in (2.14 m)
S. w/66 in (1.68 m) low profile extended bucket on ground	89.0 in (2.26 m)
T. Clearance circle rear	57 in (1.45 m)
V. Track gauge, centerline to centerline	52.5 in (1.33 m)

NOTE: *Equipped with 12.6 in (320 mm) track

PERFORMANCE SPECS

Operating load @ 35%	2,000 lb (907 kg)
Operating load @ 50%	2,860 lb (1297 kg)
Tipping load	5,715 lb (2592 kg)
Breakout force	
Lift cylinder	5,675 lb (25,244 N)
Bucket cylinder	5,503 lb (24,479 N)
Dig depth	
w/bucket flat	0 in (0 mm)
Cycle time	
Raise	3.6 seconds
Lower	2.6 seconds
Dump	1.3 seconds
Rollback	1.6 seconds

NOTE: SAE rated lift capacities. Breakout force and cycle time measured with rated load in F/E bucket.

OPTIONAL BUCKETS

Type	Width inch (m)	Weight lb (kg)	Heaped Capacity ft ³ (m ³)
Foundry/ Excavating	66 (1.6)	370 (168)	15.2 (0.43)
	72 (1.8)	390 (177)	16.7 (0.47)
	78 (2.0)	527 (239)	15.9 (0.45)
Low Profile	66 (1.6)	400 (181)	13.2 (0.37)
	72 (1.8)	425 (193)	14.5 (0.41)
	Low Profile Extended	66 (1.6)	434 (197)
72 (1.8)		477 (216)	17.1 (0.48)
Utility/Light Material		72 (1.8)	434 (197)
	84 (2.1)	497 (225)	27.9 (0.79)
	Heavy Duty Dirt	66 (1.5)	474 (215)
72 (1.8)		501 (227)	14.6 (0.41)
78 (2.0)		527 (239)	15.9 (0.45)

STANDARD EQUIPMENT

OPERATOR'S COMPARTMENT

ROPS/FOPS level 1 canopy w/side screens
Tilt ROPS/FOPS
Rear window w/emergency escape
Instrument panels
Suspension vinyl seat
2 in (51 mm) retractable seat belt
Hand throttle
Foot throttle
Alarm package
Headliner
Top window
Cup holder
Power plug socket
Foot rest
Storage tray
Low effort ergonomic hand controls
Padded seat bar w/integral armrests
Loader control lockout system
Electric parking brake control
Floor cleanout panel

LOADER

Radial loader arm design
Mechanical attachment coupler
Loader lift arm support strut

ENGINE

Case/Iveco 432T/M3 diesel
Tier IV compliant
No maintenance belt
Battery disconnect switch w/jumpstart terminals
Side-by-side radiator and oil cooler
Grid heater
Integral engine oil cooling
Fuel filter w/water trap
Dual element air cleaner
95 amp alternator
1125 CCA 12-volt battery

POWERTRAIN

Pilot controls
SAHR disc parking brakes
2 speed ground drive

HYDRAULICS

Auxiliary hydraulics 3050 psi
(210 bar) – 23.8 gpm (90 L/min)
Hydraulic circuit pedal lock
Loader arm-mounted ISO flat face connectors
Auxiliary function lockout override
Loader function lockout system
Loader lift lockout override
3-spool loader control valve
Heavy-duty oil cooler
Loader arm float position

OTHER

Integral bumper counterweight
Lockable service access hood
Single-point daily servicing
Halogen lights, 2-front, 2 side, 1-rear (halogen)
Rear tail lights
Remote oil drain
Lift cylinder guards

OPTIONAL EQUIPMENT

OPERATOR'S COMPARTMENT

Deluxe cloth suspension seat w/heater and lumbar support
Interior mirror
Electric auxiliary hydraulic control
Glass front door w/wiper & washer
Sliding side windows
3 inch retractable seat belt
Heater (deluxe)
Heater and AC
Radio
Demolition door

LOADER

Auxiliary front electric control
Ride control
Hydraulic attachment coupler
Hydraulic one-way self-leveling

HYDRAULICS

High-flow auxiliary hydraulics
3050 psi (210 bar) – 33.2 gpm (126 L/min)
Second auxiliary hydraulics
Attachment case drain plumbing

ENGINE

Coolant block heater

OTHER

Deluxe instrument panel
Road lights
Rotating beacon
Lift hooks
Special paint
Language decals
Buckets – see page 3
Bolt-on bucket cutting edges
42 in (1.07 m) and 48 in (1.22 m) pallet forks

NOTE: All specifications are stated in accordance with SAE Standards or Recommended Practices, where applicable.

NOTE: All engines meet current EPA emissions requirements.

IMPORTANT: Case Construction Equipment Inc. reserves the right to change these specifications without notice and without incurring any obligation relating to such change. Case Construction Equipment Inc. does not warrant the safety or reliability of attachments from other manufacturers.

Case is a registered trademark of CNH America LLC. Any trademarks referred to herein, in association with goods and/or services of companies other than CNH America LLC, are the property of those respective companies.



www.casece.com

