



ENGINE

Model..... Case Family III
445T/M2 diesel, Tier II certified
Type 4-stroke, turbocharged
Cylinders..... 4
Bore/Stroke 4.1" x 5.2"
(104 x 132 mm)
Displacement 274 in³ (4.5 L)
Fuel injection..... Direct
Fuel #2 Diesel
Fuel filter..... In-line strainer
Air intake Cross-flow
Cooling Liquid
Engine speeds (rpm)
High idle – no load..... 2480±50
Rated – full load 2300
Low idle..... 1050
Horsepower per SAE J1349
Gross..... 89 (66 kW) @ 2300 rpm
Net 82 (61.1 kW) @ 2300 rpm
Peak torque
@ 1400 rpm 263 lb-ft (357 N·m)

ENGINE COOLING

Radiator
Core type Square wave
serpentine
Core size area..... 450 in² (.290 m²)
Rows of tubes 3
Cap pressure 13.0 psi (89.6 kPa)
Fan
Diameter 17.7" (450 mm)
Ratio 1.1:1
Water pump
Style Integral
Flow 48 gpm (182 L/min)
Engine lubrication
Pump Deep sump with plate
cooler and pressurized
under-piston nozzles
Pump operating angle ratings
Side-to-side..... Rated 35°
Fore and aft Rated 35°
Oil filtration Replaceable,
full-flow cartridge

POWERTRAIN

Drive pump Tandem, axial piston
hydrostatic transmission
w/integral charge pump driven
directly off engine flywheel
Pump to engine ratio 1:1
Displacement ... 0 to 2.81 in³ (46 cc)
Pump flow @ rated rpm... 29.8 gpm
(113 L/min)
Flow Bi-directional
Charge pressure... 360 psi (24.8 bar)
System relief 4350 psi
(300 bar)
Controls Servo
Drive motors Fixed displacement
radial piston
Maximum displacement.... 28.7 in³
(470 cc)
Speed @ rated engine rpm
@ max displacement..... 238 rpm
Optional high speed 397 rpm
Torque @ max displacement
and relief pressure..... 5,920 lb-ft
(8027 N·m)
Travel speed mph (km/h)
Low range 7.3 (11.8)
High range (optional) ... 11.9 (19.2)
Final drive..... Single-reduction
chain drive
Drive chain
Size ASA #100HV
Tensile strength 30,000 lb
(133 447 N)
Axles..... One-piece, forged
induction-hardened
high carbon steel
Torque @ rated rpm 4,633 lb-ft
(6014 N·m)
Diameter 2.0" (51 mm)
Length 14.61" (371 mm)
Parking brakes Spring applied,
hydraulic release disc
Engagement..... Depress on/off
brake button, raise seat bar,
get off seat, or stop engine

HYDRAULIC SYSTEM

Standard equipment
Pump Gear pump
Displacement 2.2 in³/rev (36 cc)
Pump flow @ rated engine rpm
Total 21.0 gpm (79.4 L/min)
Optional high flow@
rated engine rpm
..... 31 gpm (117 L/min)
Loader control valve..... 3-spool
open-center series with
power beyond port
Relief pressure .. 3000 psi (207 bar)
Port relief pressures
#1B Raise..... 3350 psi (230 bar)
Hydraulic lines
Tubing 37° JIC Flare
Loop hoses SAE 100 R12
Hydraulic oil cooler
Core type Two row in-line
Hydraulic filter 6 micron spin-on
replaceable element
on the return line with
warning indicator

INSTRUMENTATION

Battery voltage
 LCD hourmeter
 Fuel level LCD bar graph
 Warning lights
 Fuel level
 Engine preheat
 Engine coolant temperature
 Engine oil pressure
 Air cleaner restriction
 Hydraulic charge pressure
 Hydraulic filter restriction
 Hydraulic oil temperature
 Parking brake
 Seat belt reminder
 Warning alarms
 Engine coolant temperature
 Engine oil pressure
 Hydraulic oil temperature
 Hydraulic charge pressure
 Seat belt reminder

ELECTRICAL SYSTEM

Alternator..... 95 amp
 Starter 2.7 kW
 Battery 12-volt low-maintenance
 850 cold-cranking amps
 @ 0° F (-18° C)

OPERATOR ENVIRONMENT

Tilt ROPS/FOPS canopy
 w/side screens
 Water-shedding vinyl seat
 Seat presence switch
 2" (51 mm) retractable seat belt
 Seat bar w/integral armrests
 Two servo-assist, adjustable,
 hands-only control levers
 Hand throttle
 Loader control lockout system
 Front and rear halogen floodlights
 Floor cleanout access

CYLINDERS

Lift cylinder
 Bore diameter..... 2.5" (63.5 mm)
 Rod diameter 1.5" (38.1 mm)
 Stroke 35.8" (910 mm)
 Closed length 46.8" (1190 mm)
 Bucket cylinder
 Bore diameter..... 3.0" (76.2 mm)
 Rod diameter 1.5" (38.1 mm)
 Stroke 14.6" (370 mm)
 Closed length 26.9" (683 mm)

OPERATING WEIGHTS

Unit equipped with 12.00 x 16.5
 Solideal Hauler SKS tires, 66 "
 (1.6 m) short lip bucket,
 mechanical attachment coupler,
 full fuel and 165 lb (75 kg)
 operator 6,980 lb (3167 kg)
 Shipping weight... 6,312 lb (2864 kg)
 Add-on weights
 Side cab glass..... +70 lb (32 kg)
 Lexan® door..... +50 lb (22.6 kg)
 Glass door w/wiper.... +77 lb (35 kg)
 Floor heater +20 lb (9.1 kg)
 Suspension seat +10 lb (4.5 kg)

SERVICE CAPACITIES

Fuel tank..... 22.0 gal (83.3 L)
 Engine oil w/filter 12.7 qt (12 L)
 Engine cooling system 18 qt (17 L)
 Hydraulic system
 Reservoir 7.1 gal (32.4 L)
 Total 13.3 gal (50.2 L)
 Chain tanks (per side) 6 qt (5.7 L)

TIRE SELECTION

	Size	Ply Rating	Tread Depth	Tire Width	Width Over Tires	Tire Weight*	Max Travel Speed
Solideal Hauler SKS.....	12.00 x 16.5.....	10.....	0.75" (19 mm)	13.1" (333 mm)	64" (1.63 m)	51 lb (23.1 kg)	7.0 mph (11.3 km/h)
Solideal Hauler SKS (offset wheel)	12.00 x 16.5.....	10.....	0.75" (19 mm)	13.1" (333 mm)	71" (1.80 m)	51 lb (23.1 kg)	7.0 mph (11.3 km/h)
Galaxy Beefy Baby II	12.00 x 16.5.....	10.....	0.81" (21 mm)	12.4" (315 mm)	64" (1.63 m)	81 lb (36.7 kg)	7.0 mph (11.3 km/h)
Galaxy Beefy Baby (offset wheel) II.....	12.00 x 16.5.....	10.....	0.81" (21 mm)	12.4" (315 mm)	71" (1.80 m)	81 lb (36.7 kg)	7.0 mph (11.3 km/h)
Galaxy Hulk.....	12.00 x 16.5.....	12.....	1.37" (35 mm)	12.0" (304 mm)	64" (1.63 m)	100 lb (45.4 kg)	7.0 mph (11.3 km/h)
Galaxy Bulky Hulk.....	33/15.50 x 16.5.....	14.....	1.37" (35 mm)	15.1" (384 mm)	70" (1.78 m)	124 lb (56.2 kg)	7.0 mph (11.3 km/h)
Galaxy Hippo.....	33/15.50 x 16.5.....	12.....	0.81" (21 mm)	15.2" (386 mm)	70" (1.78 m)	96 lb (43.6 kg)	7.0 mph (11.3 km/h)

NOTE: *Tire weight does not include wheel weight.

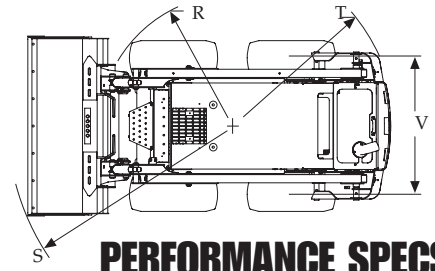
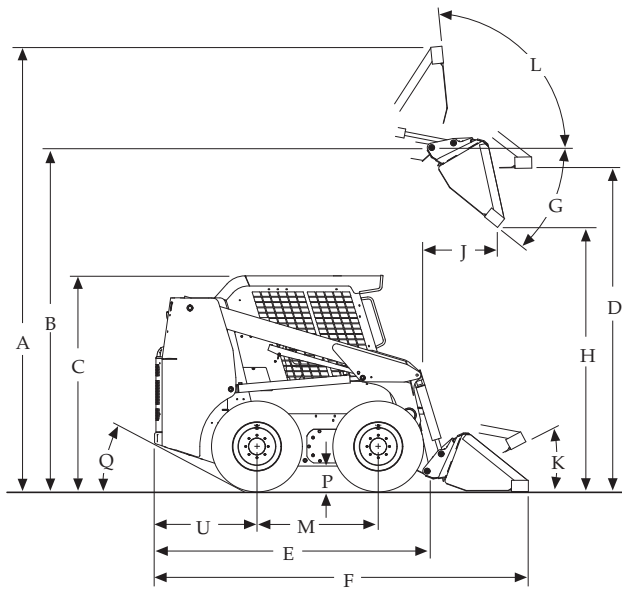

DIMENSIONS

- A.** Overall operating height
w/foundry/excavating bucket – short lip 152.4" (3.87 m)
w/low profile bucket – standard lip 158.0" (4.01 m)
w/low profile extended bucket – long lip 163.0" (4.14 m)
- Height to*
- B.** Bucket hinge pin 121.5" (3.09 m)
- C.** Top of rollover protective structure 76.7" (1.95 m)
- D.** Bottom of level bucket, loader arm fully raised 114.2" (2.90 m)
- Overall length
- E.** w/o attachment w/coupler 103.9" (2.64 m)
- F.** w/foundry/excavating bucket on ground 127.2" (3.23 m)
- F.** w/low profile bucket on ground 132.9" (3.38 m)
- F.** w/low profile extended bucket on ground 137.9" (3.50 m)
- G.** Dump angle at maximum height 39°
- H.** Dump height – loader arm fully raised
w/foundry/excavating bucket 96.6" (2.45 m)
w/low profile bucket 93.1" (2.37 m)
w/low profile extended bucket 90.0" (2.29 m)
- J.** Reach – loader arm fully raised
w/foundry/excavating bucket 21.3" (0.54 m)
w/low profile bucket 25.9" (0.66 m)
w/low profile extended bucket 29.7" (0.75 m)
- Maximum attachment rollback
- K.** Bucket on ground 32°
- L.** Bucket at full height 84°
- M.** Wheelbase 43.1" (1.10 m)
- Ground clearance
- P.** Bottom of belly pan 9" (229 mm)
- Q.** Angle of departure 28°
- Clearance circle front
- R.** less bucket 50.3" (1.28 m)
- S.** w/66" (1.68 m) foundry/excavating bucket on ground 76.7" (1.95 m)
- S.** w/66" (1.68 m) low profile bucket on ground 81.9" (2.08 m)
- S.** w/66" (1.68 m) low profile extended bucket on ground... 83.1" (2.20 m)
- T.** Clearance circle rear 59.1" (1.50 m)
- U.** Rear axle to bumper 36.6" (0.93 m)
- V.** Tread width, centerline to centerline 52.6" (1.34 m)

NOTE: *Equipped with 12.00 x 16.5 Solideal Hauler SKS tires.

PERFORMANCE SPECS

- Operating load 2,200 lb (998 kg)
Tipping load 4,400 lb (1996 kg)
Breakout force
Lift cylinder 4,664 lbf
(20 747 N)
Bucket cylinder 5,885 lbf
(26 178 N)
- Dig depth
w/bucket flat 0" (0 mm)
- Cycle time
Raise 4.1 seconds
Lower 3.2 seconds
Dump 2.4 seconds
Rollback 1.9 seconds

NOTE: SAE rated lift capacities. Breakout force and cycle time measured with rated load in F/E bucket.

OPTIONAL BUCKETS

Type	Width inch (m)	Weight lb (kg)	Heaped
			Capacity ft ³ (m ³)
Foundry/			
Excavating ...	66	370	15.2
	(1.6)	(168)	(0.43)
	72	390	16.7
	(1.8)	(177)	(0.47)
	78	495	18.4
	(2.0)	(225)	(0.52)
Low Profile ...	66	400	13.2
	(1.6)	(181)	(0.37)
	72	425	14.5
	(1.8)	(193)	(0.41)
Low Profile			
Extended	66	434	15.5
	(1.6)	(197)	(0.44)
	72	477	17.1
	(1.8)	(216)	(0.48)
	78	502	18.6
	(2.0)	(228)	(0.53)
Utility/Light			
Material	72	434	23.7
	(1.8)	(197)	(0.67)
	84	497	27.9
	(2.1)	(225)	(0.79)
Manure/			
Slurry	72	465	19.1
	(1.8)	(211)	(0.54)

STANDARD EQUIPMENT

OPERATOR'S COMPARTMENT

ROPS/FOPS canopy w/side screens
Tilt ROPS/FOPS
Instrument panels
Water-shedding vinyl seat
2" (51 mm) retractable seat belt
Hand throttle
Ergonomic hand controls
Seat bar w/integral armrests
Loader control lockout system
Electric brake control
Floor cleanout panel

LOADER

Radial loader arm design
Mechanical attachment coupler

ENGINE

Case Family III 445T/M2
diesel (turbo)
Tier II certified
Integral engine oil cooling
Fuel filter w/water trap
Dual element air cleaner
95 amp alternator
850 CCA 12-volt battery
Heavy-duty radiator

POWERTRAIN

Hydrostatic four wheel drive
Servo controls
ASA #100HS drive chain
SAHR disc parking brakes

HYDRAULICS

Auxiliary hydraulics 3000 psi
(207 bar) – 21.0 gpm (79.4 L/min)
Hydraulic circuit pedal lock
Loader arm-mounted ISO flat face
connectors
Auxiliary function lockout override
Loader function lockout system
Loader lift lockout override
3-spool loader control valve
Heavy-duty oil cooler
Loader arm float position

OTHER

Integral bumper counterweight
Lockable service access hood
Single-point daily servicing
Halogen lights, 2-front, 1-rear
Rear tail lights
Options harness

OPTIONAL EQUIPMENT

OPERATOR'S COMPARTMENT

Vinyl suspension seat w/2"
(51 mm) retractable seat belt
Vinyl suspension seat w/3"
(76 mm) retractable seat belt
Electric auxiliary hydraulic control
Glass front door w/wiper & washer
Sliding side windows
Air conditioning
Heater (deluxe)
Rear window w/emergency escape
feature
Foot throttle
Accessory power outlet

LOADER

Auxiliary front electric control
Ride control
Hydraulic attachment coupler
Hydraulic one-way self-leveling

HYDRAULICS

High-flow auxiliary hydraulics
3000 psi (207 bar)
31 gpm (117 L/min)
Second auxiliary hydraulics
Attachment case drain plumbing

ENGINE

Coolant block heater
Grid heater

OTHER

2 speed ground drive
Backup alarm/horn package
Rotating beacon
Lift hooks
Special paint
Language decals
Factory-installed tires – see page 2
Buckets – see page 3
Bolt-on bucket cutting edges
42" (1.07 m) and
48" (1.22 m) pallet forks
Battery disconnect switch/
jump start terminals
Steel tracks

NOTE: All specifications are stated in accordance with SAE Standards or Recommended Practices, where applicable.

NOTE: All engines meet current EPA emissions requirements.

IMPORTANT: CNH America LLC reserves the right to change these specifications without notice and without incurring any obligation relating to such change. CNH America LLC does not warrant the safety or reliability of attachments from other manufacturers.

Case is a registered trademark of CNH America LLC. Any trademarks referred to herein, in association with goods and/or services of companies other than CNH America LLC, are the property of those respective companies.



www.casece.com



CASE IS A BRAND OF CNH, A GLOBAL LEADER FOR CONSTRUCTION EQUIPMENT, AGRICULTURAL EQUIPMENT AND FINANCIAL SERVICES.