



ENGINE

Model..... Case Family III
445T/M2 diesel, Tier II certified
Type 4-stroke, turbocharged
Cylinders..... 4
Bore/Stroke 4.1" x 5.2"
(104 x 132 mm)
Displacement..... 274 in³ (4.5 L)
Fuel injection..... Direct
Fuel #2 Diesel
Fuel filter..... In-line strainer
Air intake Cross-flow
Cooling Liquid
Engine speeds (rpm)
High idle - no load 2480±50
Rated - full load..... 2300
Low idle 1050±50
Horsepower per SAE J1349
Gross..... 88 (65.7 kW) @ 2300 rpm
Net 82 (61.2 kW) @ 2300 rpm
Peak torque
@ 1400 rpm 263 lb·ft (356 N·m)

ENGINE COOLING

Radiator
Core type Square wave
serpentine
Core size area..... 449 in² (.29 m²)
Rows of tubes 5
Cap pressure 13 psi (89.6 kPa)
Fan
Diameter 18.9" (480 mm)
Ratio 1.1:1
Water pump
Style Integral
Flow 48 gpm (182 L/min)
Engine lubrication
Pump Deep sump with plate
cooler and pressurized
under-piston nozzles
Pump operating angle ratings
Side-to-side..... Rated 35°
Fore and aft Rated 35°
Oil filtration Replaceable,
full-flow cartridge

POWERTRAIN

Drive pump Tandem, axial piston
hydrostatic transmission
with integral charge pump
driven directly off
engine flywheel
Pump to engine ratio 1.2:1
Displacement... 0 to 2.81 in³ (46 cc)
Pump flow @ rated rpm... 33.6 gpm
(127 L/min)
Flow Bi-directional
Charge pressure.... 360 psi (24 bar)
System relief..... 5000 psi (345 bar)
Controls Servo
Drive motors Fixed displacement
radial piston
Maximum displacement.... 45.8 in³
(750 cc)
Speed @ rated engine rpm
@ max displacement..... 180 rpm
Torque @ max displacement
and relief pressure..... 2,733 lb·ft
(3,705 N·m)
Travel High/low
trigger-button control
Low speed 0 - 6.7 mph
(10.7 km/h)
High speed (optional) .. 0 - 12.3 mph
(19.8 km/h)
Final drive..... Single-reduction
chain drive
Drive chain
Size ASA #120HS
Tensile strength 41,000 lb
(182,384 N)
Axles..... One-piece, forged
induction-hardened
high carbon steel
Max torque @ rated rpm.. 6,681 lb·ft
(9,058 N·m)
Diameter 2.5" (63.5 mm)
Length 14.76" (375 mm)
Parking brakes Spring-applied,
hydraulic release
Capacity 3,969 lb·ft (5,378 N·m)
(at the axle shaft)
Engagement Depress on/off
brake button,
raise seat bar, get off seat,
or stop engine

HYDRAULIC SYSTEM

Standard equipment
pump.....Gear pump
Displacement .. 1.94 in³/rev (32 cc)
Pump flow @ rated engine rpm
Total 22.1 gpm (83.9 L/min)
Optional high flow @ rated
engine rpm
Total 37.2 gpm (140.6 L/min)
Loader control valve 3-spool
open-center series with
power beyond port
Relief pressure .. 3000 psi (207 bar)
Port relief pressures
#1A Lower 3800 psi (262 bar)
#1B Raise..... 3800 psi (262 bar)
#2A Rollback 3800 psi (262 bar)
#2B Dump..... 3100 psi (214 bar)
Hydraulic lines
Tubing 37° JIC Flare
Loop hoses SAE 100 R12
Hydraulic oil cooler
Core type Two row in-line
Hydraulic filter..... 6-micron
spin-on replaceable element
on the return line with
warning indicator

INSTRUMENTATION

Battery Voltage
 LCD hourmeter
 Fuel level LED bar graph
 Warning lights
 Fuel level
 Engine preheat
 Engine coolant temperature
 Engine oil pressure
 Air cleaner restriction
 Hydraulic charge pressure
 Hydraulic filter restriction
 Hydraulic oil temperature
 Parking brake
 Seat belt reminder
 Warning alarms
 Engine coolant temperature
 Engine oil pressure
 Hydraulic oil temperature
 Hydraulic charge pressure
 Seat belt reminder

ELECTRICAL SYSTEM

Alternator 95 amp
 Starter 2.7 kW
 Battery 12-volt low-maintenance
 850 cold-cranking amps
 @ 0° F (-18 C)

OPERATOR ENVIRONMENT

No-tool tilt ROPS/FOPS canopy
 w/side screens
 Water-shedding vinyl seat
 Seat presence switch
 2" (51 mm) retractable seat belt
 Restraint bar w/integral armrests
 Two adjustable, hands-only
 control levers
 Hand and foot throttles
 Loader control lockout system
 Rear window w/escape provision
 Front and rear halogen floodlights
 Floor cleanout panel

CYLINDERS

Lift cylinder
 Bore diameter..... 2.25" (57 mm)
 Rod diameter 1.75" (44.4 mm)
 Stroke 38.2" (970 mm)
 Closed length..... 52.0" (1.32 m)
 Bucket cylinder
 Bore diameter..... 2.5" (63.5 mm)
 Rod diameter 1.5" (38.1 mm)
 Stroke 20.9" (530 mm)
 Closed length..... 47.4" (1.2 m)

OPERATING WEIGHTS

Unit equipped with 12 x 16.5 tires,
 84" (2.08 m) dirt bucket,
 mechanical attachment
 coupler, full fuel ... 8,950 lb (4060 kg)

Add-on weights
 Side cab glass +70 lb (32 kg)
 Lexan® door +70 lb (32 kg)
 Glass door w/wiper.. +77 lb (935 kg)
 Heater +60 lb (27 kg)
 Suspension seat..... +10 lb (4.5 kg)
 High flow auxiliary
 hydraulics 269 lb (122 kg)
 Hydraulic attachment
 coupler +38 lb (17 kg)
 Counterweight +875 lb (387 kg)

SERVICE CAPACITIES

Fuel tank..... 20.7 gal (78.3 L)
 Engine oil w/filter 3.2 gal (12 L)
 Engine cooling system..... 18 qt (17 L)
 Flywheel/splitter gearbox... 2.1 qt (2 L)
 Hydraulic system
 Reservoir 6.5 gal (24.5 L)
 Total 17.0 gal (64.3 L)
 Chain tanks (per side) 8 qt (7.6 L)

TIRE SELECTION

	Size	Ply Rating	Tread Depth	Tire Width	Width Over Tires	Tire Weight*	Max Travel Speed
Solideal Hauler SKS.....	12.00 x 16.5	10	0.75" (19 mm)	13.1" (333 mm)	72" (1.83 m)	51 lb (23.1 kg)	11.1 mph (17.9 km/h)
Galaxy Beefy Baby II.....	12.00 x 16.5	10	0.75" (19 mm)	12.3" (312 mm)	72" (1.83 m)	81 lb (36.7 kg)	11.1 mph (17.9 km/h)
Galaxy Hulk.....	12.00 x 16.5	12	0.81" (21 mm)	12.3" (312 mm)	72" (1.83 m)	100 lb (45.3 kg)	11.1 mph (17.9 km/h)
Galaxy King Kong.....	12.00 x 16.5	10	1.25" (32 mm)	10.2" (259 mm)	72" (1.83 m)	96 lb (43.5 kg)	11.2 mph (18.0 km/h)
Galaxy Bulky Hulk.....	33/15.50 x 16.5	14	0.81" (21 mm)	16.7" (424 mm)	80" (2.03 m)	124 lb (56.2 kg)	11.1 mph (17.9 km/h)
Case Steel Tracks	12.00 x 16.5...	NA	1.4"† (36 mm)	14.7"∅ (373 mm)	78" (1.98 m)	959 lb (435.0 kg)	11.8 mph (18.9 km/h)

NOTE: *Tire weight does not include wheel weight. †Equals grouser depth. ∅Equals track width.

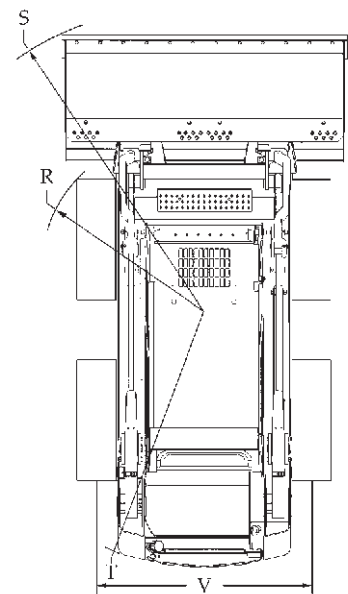
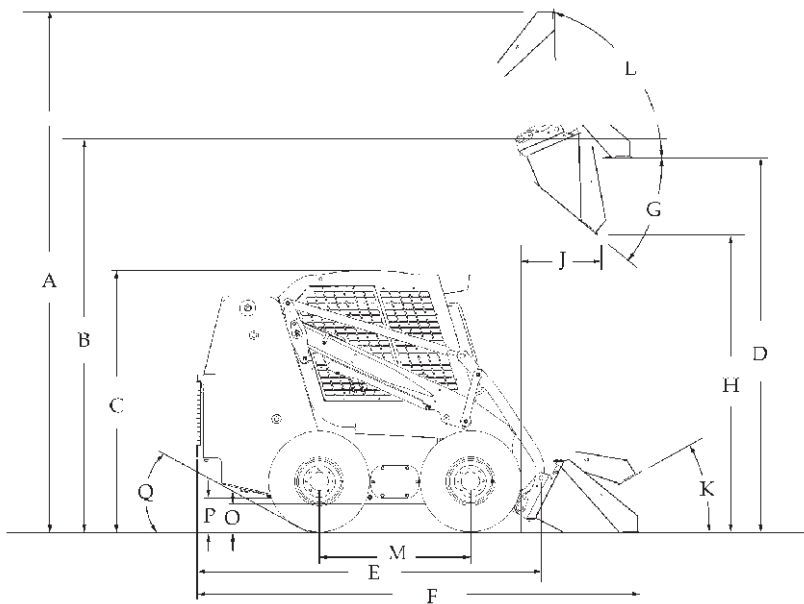

DIMENSIONS

- A.** Overall operating height
 Dirt bucket 150.3" (3.82 m)
 Light material bucket 158.9" (4.04 m)
- Height to*
- B.** Bucket hinge pin 124.5" (3.16 m)
- C.** Top of rollover protective structure 80" (2.03 m)
- D.** Bottom of level bucket, loader arm fully raised 116.5" (2.96 m)
- Overall length
- E.** w/o attachment w/coupler 108.7" (2.77 m)
- F.** w/dirt bucket on ground 140.8" (3.59 m)
- F.** w/light material bucket on ground 148.5" (3.79 m)
- G.** Dump angle at maximum height
 Dirt bucket 40°
 Light material bucket 35°
- H.** Dump height – loader arm fully raised
 Dirt bucket 94.5" (2.40 m)
 Light material bucket 93.0" (2.36 m)
- J.** Reach – loader arm fully raised
 Dirt bucket 26.7" (678 mm)
 Light material bucket 35.3" (896 mm)
- Maximum attachment rollback
- K.** Bucket on ground 30°
- L.** Bucket at full height 55°
- M.** Wheelbase 46.06" (1.17 m)
- Ground clearance
- O.** Bottom of chain case 9.1" (231 mm)
- P.** Bottom of belly pan 11" (279 mm)
- P.** Bottom of optional counterweight 9.1" (231 mm)
- Q.** Angle of departure 28°
- Clearance circle front
- R.** less bucket 54.5" (1.38 m)
- S.** w/73" (1.85 m) dirt bucket on ground 84.3" (2.14 m)
- S.** w/84" (2.08 m) dirt bucket on ground 86.3" (2.19 m)
- S.** w/84" (2.08 m) light material bucket on ground 93.3" (2.37 m)
- T.** Clearance circle rear 62.2" (1.58 m)
- V.** Tread width, centerline to centerline 64.5" (1.64 m)

NOTE: *Equipped with 12 x 16.5 tires.

PERFORMANCE SPECS

- Operating load 2,450 lb (1111 kg)
 w/counterweight 2,910 lb (1320 kg)
- Tipping load 4,900 lb (2223 kg)
 w/counterweight 5,820 lb (2640 kg)
- Breakout force
 Lift 5,290 lbf
 (23 531 N)
- Bucket 6,200 lbf
 (27 578 N)
- Dig depth
 w/bucket flat 0.24" (6 mm)
- Cycle time
 Raise 3.14 seconds
 Lower 2.44 seconds
 Dump 1.14 seconds
 Rollback99 seconds

NOTE: SAE rated lift capacities. Cycle time measured with rated load in bucket.

OPTIONAL BUCKETS

Type	Width inch (m)	Weight lb (kg)	Heaped Capacity ft³ (m³)
Dirt	73 (1.9)	553 (251)	16.8 (.48)
	84 (2.1)	593 (269)	19 (.54)
HD Dirt	73 (1.9)	621 (282)	16.8 (.48)
	84 (2.1)	676 (307)	19 (.54)
Utility	73 (1.9)	628 (285)	22.4 (.63)
	84 (2.1)	674 (306)	25.3 (.72)
HD Utility	73 (1.9)	696 (316)	22.4 (.63)
	84 (2.1)	758 (344)	25.3 (.72)
Light Material	82 (2.1)	584 (265)	32.5 (.92)

STANDARD EQUIPMENT

OPERATOR'S COMPARTMENT

ROPS/FOPS canopy w/side screens
No-tools tilt ROPS/FOPS
Instrument panels
Water-shedding vinyl seat
2" (51 mm) retractable seat belt
Hand & foot throttles
Ergonomic hand controls
Seat bar w/integral arm rests
Loader control lockout system
Electric brake control
Rear window w/emergency escape feature
Floor cleanout panel

LOADER

Radial lift linkage
Mechanical two-way self-leveling linkage
Power Cycle bucket linkage
Mechanical attachment coupler

ENGINE

Case Family III 445T/M2 diesel
Tier II Certified
Integral engine oil cooling
Fuel filter w/water trap
Dual element air cleaner
95 amp alternator
850 CCA 12-volt battery
Heavy-duty radiator

POWERTRAIN

Hydrostatic four wheel drive
Servo controls
ASA #120HS drive chain
SAHR disc parking brakes

HYDRAULICS

Auxiliary hydraulics 3000 psi (207 bar) - 22.1 gpm (83.9 L/min),
Auxiliary interlock system
Loader arm mounted ISO flat face hydraulic quick connectors
Loader function lockout system
Loader lift lockout override
3-spool loader control valve
Heavy-duty oil cooler
Loader arm float position

OTHER

Integral bumper counterweight
Lockable service access hood
Single-point daily servicing
Halogen lights, 2-front, 1-rear
Rear tail lights
Options harness

OPTIONAL EQUIPMENT

OPERATOR'S COMPARTMENT

Vinyl suspension seat w/ 2" (51 mm) retractable seat belt
Vinyl suspension seat w/ 3" (76 mm) retractable seat belt
Electric auxiliary hydraulic control
Glass front door w/wiper & washer
Sliding side windows
Air conditioning
Heater (deluxe)
Accessory power outlet
Floor mat w/footrests
Headliner

LOADER

Auxiliary front electric control
Ride Control
Hydraulic attachment coupler

HYDRAULICS

Auxiliary high-flow 3000 psi (207 bar) - 37.2 gpm (140.6 L/min)
Attachment case drain plumbing
Electronically controlled auxiliary hydraulics
Second auxiliary hydraulics

ENGINE

Coolant block heater
Grid heater

OTHER

2-speed ground drive
Backup alarm and horn package
Rotating beacon
875 lb (397 kg) counterweight
Lift hooks
Drawbar
Heavy-duty rear door
Special paint
Language decals
Factory-installed tires - see page 2
Buckets - see page 3
Bolt-on spill guards
Bolt-on cutting edges
42" (1.07 m)/48" (1.22 m) pallet forks
Jump start terminals/battery disconnect switch
Steel tracks

NOTE: All specifications are stated in accordance with SAE Standards or Recommended Practices, where applicable.

NOTE: All engines meet current EPA emissions requirements.

IMPORTANT: CNH America LLC reserves the right to change these specifications without notice and without incurring any obligation relating to such change. CNH America LLC does not warrant the safety or reliability of attachments from other manufacturers.

Case is a registered trademark of CNH America LLC. Any trademarks referred to herein, in association with goods and/or services of companies other than CNH America LLC, are the property of those respective companies.

www.casece.com



CASE IS A BRAND OF CNH, A GLOBAL LEADER FOR CONSTRUCTION EQUIPMENT, AGRICULTURAL EQUIPMENT AND FINANCIAL SERVICES.