



# 60XT Skid Steer

## ENGINE

Model ..... Case 4-390 diesel  
Type..... 4-stroke, naturally aspirated  
Cylinders..... 4  
Bore/Stroke ..... 4.02" x 4.72"  
(102 x 120 mm)  
Displacement ..... 239 in<sup>3</sup> (3.9 L)  
Fuel injection..... Direct  
Fuel ..... #2 Diesel  
Fuel filter..... In-line strainer  
Air intake ..... Cross-flow  
Cooling ..... Liquid  
Engine speeds (rpm)  
High idle – no load..... 2450±50  
Rated – full load ..... 2200  
Low idle..... 950  
Horsepower per SAE J1349  
Gross..... 75 (55.9 kW) @ 2200 rpm  
Net ..... 69 (51 kW) @ 2200 rpm  
Peak torque  
@ 1200 rpm ..... 193 lb-ft (262 N·m)

## ENGINE COOLING

Radiator  
Core type ..... Square wave  
serpentine  
Core size area.... 165.9 in<sup>2</sup> (.107 m<sup>2</sup>)  
Rows of tubes ..... 5  
Cap pressure ..... 14.9 psi (103 kPa)  
Fan  
Diameter ..... 20.4" (518 mm)  
Ratio ..... 1.1:1  
Water pump  
Style ..... Integral  
Flow..... 45 gpm (170 L/min)  
Engine lubrication  
Pump..... Deep sump plate cooler  
with pressurized  
under-piston nozzles  
Pump operating angle ratings  
Side-to-side..... Rated 45°  
Fore and aft ..... Rated 45°  
Oil filtration ..... Replaceable,  
full-flow cartridge

## POWERTRAIN

Drive pump .... Tandem, axial piston  
hydrostatic transmission  
w/integral charge pump driven  
directly off engine flywheel  
Pump to engine ratio..... 1:1  
Displacement ... 0 to 2.81 in<sup>3</sup> (46 cc)  
Pump flow @ rated rpm... 26.7 gpm  
(101 L/min)  
Flow ..... Bi-directional  
Charge pressure ... 400 psi (27.6 bar)  
System relief ..... 5004 psi  
(345 bar)  
Controls ..... Servo  
Drive motors .... Fixed displacement  
high torque, low-speed gerotor  
motor with shuttle valve  
Maximum displacement.... 30.7 in<sup>3</sup>  
(503 cc)  
Speed @ rated engine rpm  
@ max displacement..... 183 rpm  
Torque @ max displacement  
and relief pressure..... 1,752 lb-ft  
(2383 N·m)  
Travel speed ..... 7.0 mph  
(11.3 km/h)  
Final drive..... Single-reduction  
chain drive  
Drive chain  
Size ..... ASA #100HS  
Tensile strength ..... 30,000 lb  
(133 447 N)  
Axles..... One-piece, forged  
induction-hardened  
high carbon steel  
Torque @ rated rpm ..... 4,906 lb-ft  
(6651 N·m)  
Diameter ..... 2.0" (51 mm)  
Length ..... 14.61" (371 mm)  
Parking brakes ..... Pin lock  
Engagement ..... Raise seat bar

## HYDRAULIC SYSTEM

Standard equipment  
Pump ..... Gear pump  
Displacement ... 2.32 in<sup>3</sup>/rev (38 cc)  
Pump flow @ rated engine rpm  
Total ..... 21.0 gpm (79.4 L/min)  
Loader control valve..... 2-spool  
open-center series with  
power beyond port  
Relief pressure.... 3000 psi (207 bar)  
Port relief pressures  
#1A Lower ..... 3800 psi (262 bar)  
#1B Raise..... 3100 psi (214 bar)  
#2A Rollback .... 3800 psi (262 bar)  
#2B Dump..... 3100 psi (214 bar)  
#3A & B Auxiliary ..... None  
Hydraulic lines  
Tubing ..... 37° JIC Flare  
Loop hoses..... SAE 100 R12  
Swing-out hydraulic oil cooler  
Core type ..... Four row in-line  
Hydraulic filters ..... 6-micron,  
spin-on replaceable element  
for the return line with  
warning indicator  
Filter capacity  
Return line filter ..... 0.2 oz (27 g)

## INSTRUMENTATION

Digital hourmeter  
 Fuel level LED bar graph  
 Warning lights  
   Fuel level  
   Voltage  
   Engine coolant temperature  
   Engine oil pressure  
   Air cleaner restriction  
   Hydraulic filter restriction  
   Hydraulic oil temperature  
   Systems normal  
   Seat belt reminder  
 Warning alarms  
   Engine coolant temperature  
   Engine oil pressure  
   Hydraulic oil temperature  
   Seat belt reminder

## ELECTRICAL SYSTEM

Alternator..... 65 amp  
 Starter ..... 2.5 kW  
 Battery ..... 12-volt low-maintenance  
                   610 cold-cranking amps  
                   @ 0° F (-18° C)

## OPERATOR ENVIRONMENT

Tilt ROPS/FOPS canopy  
   w/side screens  
 Water-shedding vinyl seat  
 Seat presence switch  
 2" (51 mm) retractable seat belt  
 Seat bar w/integral armrests  
 Two servo-assist, adjustable,  
   hands-only control levers  
 Hand throttle  
 Loader control lockout system  
 Front and rear halogen floodlights  
 Floor cleanout access

## CYLINDERS

Lift cylinder  
   Bore diameter..... 2.50" (63.5 mm)  
   Rod diameter ..... 1.50" (38.1 mm)  
   Stroke ..... 35.83" (2066 mm)  
   Closed length ... 46.85" (1190 mm)  
 Bucket cylinder  
   Bore diameter..... 2.75" (69.9 mm)  
   Rod diameter .... 1.375" (34.9 mm)  
   Stroke ..... 14.5" (369 mm)  
   Closed length..... 26.9" (683 mm)

## OPERATING WEIGHTS

Unit equipped with 12.00 x 16.5  
 Solideal Hauler SKS tires,  
 66" (1.6 m) short lip bucket,  
 mechanical attachment coupler,  
 full fuel and 165 lb (75 kg)  
 operator ..... 6,562 lb (2977 kg)  
 Shipping weight... 5,894 lb (2673 kg)

### Add-on weights

Side cab glass..... +70 lb (32 kg)  
 Lexan® door..... +50 lb (22.6 kg)  
 Glass door w/wiper... +77 lb (35 kg)  
 Floor heater ..... +20 lb (9.1 kg)  
 Suspension seat ..... +10 lb (4.5 kg)

## SERVICE CAPACITIES

Fuel tank..... 22.0 gal (83.3 L)  
 Engine oil w/filter ..... 11 qt (10.4 L)  
 Engine oil w/o filter..... 10 qt (9.5 L)  
 Engine cooling system... 17.5 qt (16.6 L)  
 Hydraulic system  
   Reservoir..... 7.1 gal (32.4 L)  
   Total ..... 13.3 gal (50.2 L)  
 Chain tanks (per side)..... 6 qt (5.7 L)

## TIRE SELECTION

	Size	Ply Rating	Tread Depth	Tire Width	Width Over Tires	Tire Weight*	Max Travel Speed
Galaxy Mighty Slim Jim .....	33/10.00 x 16.5.....	10.....	0.81" ..... (21 mm)	10.2" ..... (259 mm)	59" ..... (1.50 m)	72 lb ..... (32.7 kg)	7.0 mph (11.3 km/h)
Solideal Hauler SKS.....	12.00 x 16.5.....	10.....	0.75" ..... (19 mm)	13.1" ..... (333 mm)	64" ..... (1.63 m)	51 lb ..... (23.1 kg)	7.0 mph (11.3 km/h)
Solideal Hauler SKS (offset wheel) .....	12.00 x 16.5.....	10.....	0.75" ..... (19 mm)	13.1" ..... (333 mm)	71" ..... (1.80 m)	51 lb ..... (23.1 kg)	7.0 mph (11.3 km/h)
Galaxy Beefy Baby II .....	12.00 x 16.5.....	10.....	0.81" ..... (21 mm)	12.4" ..... (315 mm)	64" ..... (1.63 m)	81 lb ..... (36.7 kg)	7.0 mph (11.3 km/h)
Galaxy Beefy Baby (offset wheel) II.....	12.00 x 16.5.....	10.....	0.81" ..... (21 mm)	12.4" ..... (315 mm)	71" ..... (1.80 m)	81 lb ..... (36.7 kg)	7.0 mph (11.3 km/h)
Galaxy Hippo.....	33/15.50 x 16.5.....	12.....	0.81" ..... (21 mm)	15.2" ..... (386 mm)	70" ..... (1.78 m)	96 lb ..... (43.6 kg)	7.0 mph (11.3 km/h)
Galaxy King Kong.....	12.00 x 16.5 .....	12.....	1.25" ..... (32 mm)	12.6" ..... (320 mm)	64" ..... (1.63 m)	96 lb ..... (43.6 kg)	7.0 mph (11.3 km/h)
Galaxy Hulk.....	12.00 x 16.5.....	12.....	1.37" ..... (35 mm)	12.0" ..... (304 mm)	64" ..... (1.63 m)	100 lb ..... (45.4 kg)	7.0 mph (11.3 km/h)
Galaxy Bulky Hulk.....	33/15.50 x 16.5.....	14.....	1.37" ..... (35 mm)	15.1" ..... (384 mm)	70" ..... (1.78 m)	124 lb ..... (56.2 kg)	7.0 mph (11.3 km/h)

NOTE: \*Tire weight does not include wheel weight.

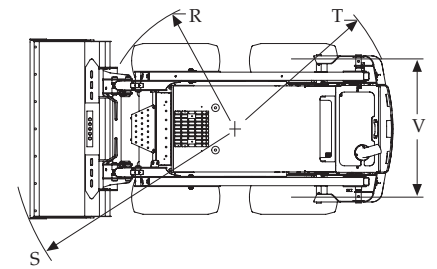
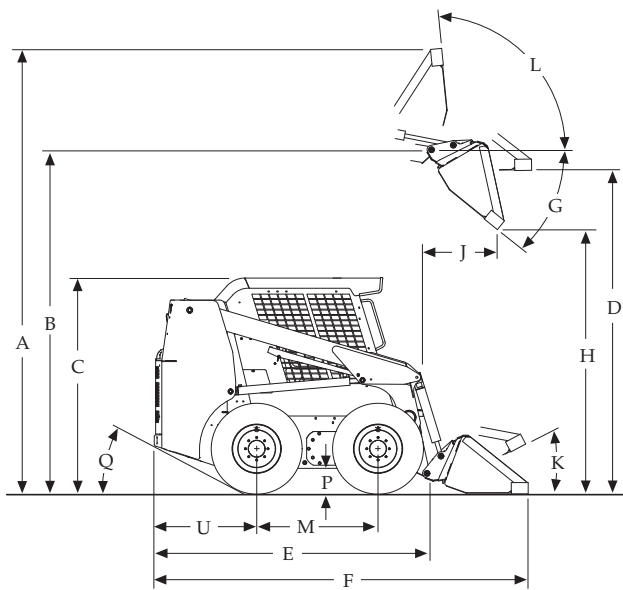

## DIMENSIONS

- A.** Overall operating height  
w/foundry/excavating bucket – short lip ..... 152.8" (3.88 m)  
w/low profile bucket – standard lip ..... 158.0" (4.01 m)  
w/low profile extended bucket – long lip ..... 163.0" (4.14 m)
- Height to\*
- B.** Bucket hinge pin ..... 121.5" (3.09 m)
- C.** Top of rollover protective structure ..... 76.7" (1.95 m)
- D.** Bottom of level bucket, loader arm fully raised ..... 114.2" (2.90 m)
- Overall length
- E.** w/o attachment w/coupler ..... 103.9" (2.64 m)
- F.** w/foundry/excavating bucket on ground ..... 127.2" (3.23 m)
- F.** w/low profile bucket on ground ..... 132.9" (3.38 m)
- F.** w/low profile extended bucket on ground ..... 137.9" (3.50 m)
- G.** Dump angle at maximum height ..... 39°
- H.** Dump height – loader arm fully raised  
w/foundry/excavating bucket ..... 96.6" (2.45 m)  
w/low profile bucket ..... 93.1" (2.37 m)  
w/low profile extended bucket ..... 90.0" (2.29 m)
- J.** Reach – loader arm fully raised  
w/foundry/excavating bucket ..... 21.3" (0.54 m)  
w/low profile bucket ..... 25.9" (0.66 m)  
w/low profile extended bucket ..... 29.7" (0.75 m)
- Maximum attachment rollback
- K.** Bucket on ground ..... 32°
- L.** Bucket at full height ..... 84°
- M.** Wheelbase ..... 43.1" (1.10 m)
- Ground clearance
- P.** Bottom of belly pan ..... 9" (229 mm)
- Q.** Angle of departure ..... 28°
- Clearance circle front
- R.** Less bucket ..... 50.3" (1.28 m)
- S.** w/66" (1.68 m) foundry/excavating bucket on ground ..... 76.7" (1.95 m)
- S.** w/66" (1.68 m) low profile bucket on ground ..... 81.9" (2.08 m)
- S.** w/66" (1.68 m) low profile extended bucket on ground ..... 83.1" (2.20 m)
- T.** Clearance circle rear ..... 59.1" (1.50 m)
- U.** Rear axle to bumper ..... 36.6" (0.93 m)
- V.** Tread width, centerline to centerline ..... 52.6" (1.34 m)

NOTE: \*Equipped with 12.00 x 16.5 Solideal Hauler SKS tires.

## PERFORMANCE SPECS

- Operating load ..... 1,800 lb (817 kg)  
Tipping load ..... 3,600 lb (1633 kg)  
Breakout force  
Lift cylinder ..... 4,431 lbf  
(19 710 N)  
Bucket cylinder ..... 5,054 lbf  
(22 482 N)
- Dig depth  
w/bucket flat ..... 0" (0 mm)
- Cycle time  
Raise ..... 4.1 seconds  
Lower ..... 3.2 seconds  
Dump ..... 2.1 seconds  
Rollback ..... 1.7 seconds

NOTE: SAE rated lift capacities. Breakout force and cycle time measured with rated load in D/F bucket.

## OPTIONAL BUCKETS

Type	Width inch (m)	Weight lb (kg)	Heaped
			Capacity ft <sup>3</sup> (m <sup>3</sup> )
<b>Foundry/ Excavating</b> ...	60	270	11.5
	(1.5)	(122)	(0.33)
	66	370	15.2
	(1.6)	(168)	(0.43)
	72	390	16.7
<b>Low Profile</b> ...	78	495	18.4
	(2.0)	(225)	(0.52)
	66	400	13.2
	(1.6)	(181)	(0.37)
<b>Low Profile Extended</b> .....	72	425	14.5
	(1.8)	(193)	(0.41)
	60	360	14.3
	(1.5)	(163)	(0.40)
<b>Utility/Light Material</b> .....	66	434	15.5
	(1.6)	(197)	(0.44)
	72	477	17.1
	(1.8)	(216)	(0.48)
	78	502	18.6
<b>Manure/ Slurry</b> .....	(2.0)	(228)	(0.53)
	60	350	19.7
	(1.5)	(159)	(0.56)
	72	434	23.7
	(1.8)	(197)	(0.67)
	84	497	27.9
	(2.1)	(225)	(0.79)
	60	340	16.7
	(1.5)	(154)	(0.47)
	72	465	19.1
	(1.8)	(211)	(0.54)

## STANDARD EQUIPMENT

### OPERATOR'S COMPARTMENT

ROPS/FOPS canopy w/side screens  
Tilt ROPS/FOPS  
Instrument panels  
Water-shedding vinyl seat  
2" (51 mm) retractable seat belt  
Hand throttle  
Ergonomic hand controls  
Seat bar w/integral armrests  
Loader control lockout system  
Floor cleanout panel

### LOADER

Radial loader arm design  
Mechanical attachment coupler

### ENGINE

Case 4-390 diesel  
Automatic fan belt tensioner  
Integral engine oil cooling  
Fuel filter w/water trap  
Dual element air cleaner  
65 amp alternator  
610 CCA 12-volt battery  
Heavy-duty radiator

### POWERTRAIN

Hydrostatic four wheel drive  
Servo controls  
ASA #100HS drive chain  
Parking brakes

### HYDRAULICS

Auxiliary hydraulics 3000 psi  
(207 bar) – 21.0 gpm (79.4 L/min)  
Hydraulic circuit pedal lock  
Loader arm-mounted ISO flat face  
connectors  
Loader function lockout system  
Loader lockout override  
2-spool loader control valve  
Loader arm float position

### OTHER

Integral bumper counterweight  
Lockable service access hood  
Single-point daily servicing  
Halogen lights, 2-front, 1-rear  
Rear tail lights

## OPTIONAL EQUIPMENT

### OPERATOR'S COMPARTMENT

Vinyl suspension seat w/2"  
(51 mm) retractable seat belt  
Vinyl suspension seat w/3"  
(76 mm) retractable seat belt  
Auxiliary front electric controls  
Chassis options harness  
Lexan® front door  
Glass front door w/wiper & washer  
Sliding side windows  
Heater (deluxe)  
Rear window w/emergency escape  
feature  
Top window  
Foot throttle  
Accessory power outlet

### LOADER

Ride control  
Hydraulic attachment coupler  
Hydraulic two-way self-leveling

### HYDRAULICS

High-flow auxiliary hydraulics  
3000 psi (207 bar)  
31.9 gpm (121 L/min)

### ENGINE

Coolant block heater  
Thermostart

### OTHER

Backup alarm  
Rotating beacon  
Lift hooks  
Horn  
Special paint  
Language decals  
Factory-installed tires – see page 2  
Buckets – see page 3  
Bolt-on spill guards  
Bolt-on bucket cutting edges  
42" (1.07 m) and 48" (1.22 m)  
pallet forks  
Model D125 backhoe  
Auxiliary front electric  
Ride control  
Remote jump start  
Battery disconnect switch  
Automatic engine shutdown system  
Steel tracks

### FIELD-INSTALLED OPTIONS

Floor heater  
Auto-engine shutdown

NOTE: All specifications are stated in accordance with SAE Standards or Recommended Practices, where applicable.

NOTE: All engines meet current EPA emissions requirements.

IMPORTANT: CNH America LLC reserves the right to change these specifications without notice and without incurring any obligation relating to such change. CNH America LLC does not warrant the safety or reliability of attachments from other manufacturers.

Case is a registered trademark of CNH America LLC. Any trademarks referred to herein, in association with goods and/or services of companies other than CNH America LLC, are the property of those respective companies.



[www.casece.com](http://www.casece.com)

 CASE IS A BRAND OF CNH, A GLOBAL LEADER FOR CONSTRUCTION EQUIPMENT, AGRICULTURAL EQUIPMENT AND FINANCIAL SERVICES.