



70XT Skid Steer

ENGINE

Model Case 4T-390 diesel
Type 4-stroke, turbocharged
Cylinders 4
Bore/Stroke 4.02" x 4.72"
(102 x 120 mm)
Displacement 239 in³ (3.9 L)
Fuel injection Direct
Fuel #2 Diesel
Fuel filter In-line strainer
Air intake Cross-flow
Cooling Liquid
Engine speeds (rpm)
High idle – no load 2400±50
Rated – full load 2200
Low idle 950
Horsepower per SAE J1349
Gross 85 (63.4 kW) @ 2200 rpm
Net 79 (59 kW) @ 2200 rpm
Peak torque
@ 1500 rpm 254 lb-ft (344 N·m)

ENGINE COOLING

Radiator
Core type Square wave
serpentine
Core size area 165.9 in² (.107 m²)
Rows of tubes 5
Cap pressure 14.9 psi (103 kPa)
Fan
Diameter 20.4" (518 mm)
Ratio 1.1:1
Water pump
Style Integral
Flow 45 gpm (170 L/min)
Engine lubrication
Pump Deep sump plate cooler
with pressurized
under-piston nozzles
Pump operating angle ratings
Side-to-side Rated 45°
Fore and aft Rated 45°
Oil filtration Replaceable,
full-flow cartridge

POWERTRAIN

Drive pump Tandem, axial piston
hydrostatic transmission
w/integral charge pump driven
directly off engine flywheel
Pump to engine ratio 1:1
Displacement ... 0 to 2.81 in³ (46 cc)
Pump flow @ rated rpm... 26.7 gpm
(101 L/min)
Flow Bi-directional
Charge pressure... 400 psi (27.6 bar)
System relief 5004 psi
(345 bar)
Controls Servo
Drive motors Fixed displacement
high torque, low-speed gerotor
motor with shuttle valve
Maximum displacement.... 30.7 in³
(503 cc)
Speed @ rated engine rpm
@ max displacement..... 183 rpm
Torque @ max displacement
and relief pressure..... 1,752 lb-ft
(2383 N·m)
Travel speed 7.0 mph
(11.3 km/h)
Final drive..... Single-reduction
chain drive
Drive chain
Size ASA #100HS
Tensile strength 30,000 lb
(133 447 N)
Axles..... One-piece, forged
induction-hardened
high carbon steel
Torque @ rated rpm 4,906 lb-ft
(6651 N·m)
Diameter 2.0" (51 mm)
Length 14.61" (371 mm)
Parking brakes Pin lock
Engagement Raise seat bar

HYDRAULIC SYSTEM

Standard equipment
Pump Gear pump
Displacement .. 2.32 in³/rev (38 cc)
Pump flow @ rated engine rpm
Total 21.0 gpm (79.4 L/min)
Loader control valve..... 2-spool
open-center series with
power beyond port
Relief pressure .. 3000 psi (207 bar)
Port relief pressures
#1A Lower 3800 psi (262 bar)
#1B Raise..... 3100 psi (214 bar)
#2A Rollback 3800 psi (262 bar)
#2B Dump..... 3100 psi (214 bar)
#3A & B Auxiliary None
Hydraulic lines
Tubing 37° JIC Flare
Loop hoses SAE 100 R12
Swing-out hydraulic oil cooler
Core type Four row in-line
Hydraulic filters 6-micron,
spin-on replaceable element
for the return line with
warning indicator
Filter capacity
Return line filter 0.2 oz (27 g)

INSTRUMENTATION

Digital hourmeter
 Fuel level LED bar graph
 Warning lights
 Fuel level
 Voltage
 Engine coolant temperature
 Engine oil pressure
 Air cleaner restriction
 Hydraulic filter restriction
 Hydraulic oil temperature
 Systems normal
 Seat belt reminder
 Warning alarms
 Engine coolant temperature
 Engine oil pressure
 Hydraulic oil temperature
 Seat belt reminder

ELECTRICAL SYSTEM

Alternator..... 65 amp
 Starter 2.5 kW
 Battery 12-volt low-maintenance
 610 cold-cranking amps
 @ 0° F (-18° C)

OPERATOR ENVIRONMENT

Tilt ROPS/FOPS canopy
 w/side screens
 Water-shedding vinyl seat
 Seat presence switch
 2" (51 mm) retractable seat belt
 Seat bar w/integral armrests
 Two servo-assist, adjustable,
 hands-only control levers
 Hand throttle
 Loader control lockout system
 Front and rear halogen floodlights
 Floor cleanout access

CYLINDERS

Lift cylinder
 Bore diameter..... 2.50" (63.5 mm)
 Rod diameter 1.50" (38.1 mm)
 Stroke 35.83" (2066 mm)
 Closed length ... 46.85" (1190 mm)
 Bucket cylinder
 Bore diameter..... 3.0" (76.2 mm)
 Rod diameter 1.5" (38.1 mm)
 Stroke 14.5" (369 mm)
 Closed length..... 26.9" (683 mm)

OPERATING WEIGHTS

Unit equipped with 12.00 x 16.5
 Solideal Hauler SKS tires, 66 "
 (1.6 m) short lip bucket,
 mechanical attachment coupler,
 full fuel and 165 lb (75 kg)
 operator 6,906 lb (3133 kg)
 Shipping weight... 6,238 lb (2830 kg)
 Add-on weights
 Side cab glass..... +70 lb (32 kg)
 Lexan® door..... +50 lb (22.6 kg)
 Glass door w/wiper.... +77 lb (35 kg)
 Floor heater +20 lb (9.1 kg)
 Suspension seat +10 lb (4.5 kg)

SERVICE CAPACITIES

Fuel tank..... 22.0 gal (83.3 L)
 Engine oil w/filter 11 qt (10.4 L)
 Engine oil w/o filter..... 10 qt (9.5 L)
 Engine cooling system... 17.5 qt (16.6 L)
 Hydraulic system
 Reservoir..... 7.1 gal (32.4 L)
 Total..... 13.3 gal (50.2 L)
 Chain tanks (per side) 6 qt (5.7 L)

TIRE SELECTION

	Size	Ply Rating	Tread Depth	Tire Width	Width Over Tires	Tire Weight*	Max Travel Speed
Galaxy Mighty Slim Jim	33/10.00 x 16.5	10	0.81" (21 mm)	10.2" (259 mm)	59" (1.50 m)	72 lb (32.7 kg)	7.0 mph (11.3 km/h)
Solideal Hauler SKS.....	12.00 x 16.5	10	0.75" (19 mm)	13.1" (333 mm)	64" (1.63 m)	51 lb (23.1 kg)	7.0 mph (11.3 km/h)
Solideal Hauler SKS (offset wheel)	12.00 x 16.5	10	0.75" (19 mm)	13.1" (333 mm)	71" (1.80 m)	51 lb (23.1 kg)	7.0 mph (11.3 km/h)
Galaxy Beefy Baby II	12.00 x 16.5	10	0.81" (21 mm)	12.4" (315 mm)	64" (1.63 m)	81 lb (36.7 kg)	7.0 mph (11.3 km/h)
Galaxy Beefy Baby (offset wheel) II.....	12.00 x 16.5	10	0.81" (21 mm)	12.4" (315 mm)	71" (1.80 m)	81 lb (36.7 kg)	7.0 mph (11.3 km/h)
Galaxy Hippo.....	33/15.50 x 16.5	12	0.81" (21 mm)	15.2" (386 mm)	70" (1.78 m)	96 lb (43.6 kg)	7.0 mph (11.3 km/h)
Galaxy King Kong.....	12.00 x 16.5	12	1.25" (32 mm)	12.6" (320 mm)	64" (1.63 m)	96 lb (43.6 kg)	7.0 mph (11.3 km/h)
Galaxy Hulk.....	12.00 x 16.5	12	1.37" (35 mm)	12.0" (304 mm)	64" (1.63 m)	100 lb (45.4 kg)	7.0 mph (11.3 km/h)
Galaxy Bulky Hulk.....	33/15.50 x 16.5	14	1.37" (35 mm)	15.1" (384 mm)	70" (1.78 m)	124 lb (56.2 kg)	7.0 mph (11.3 km/h)

NOTE: *Tire weight does not include wheel weight.

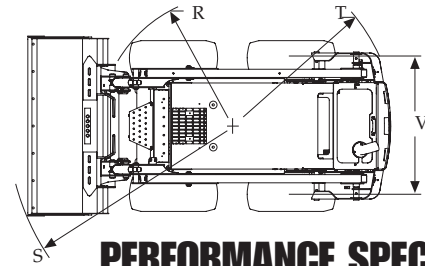
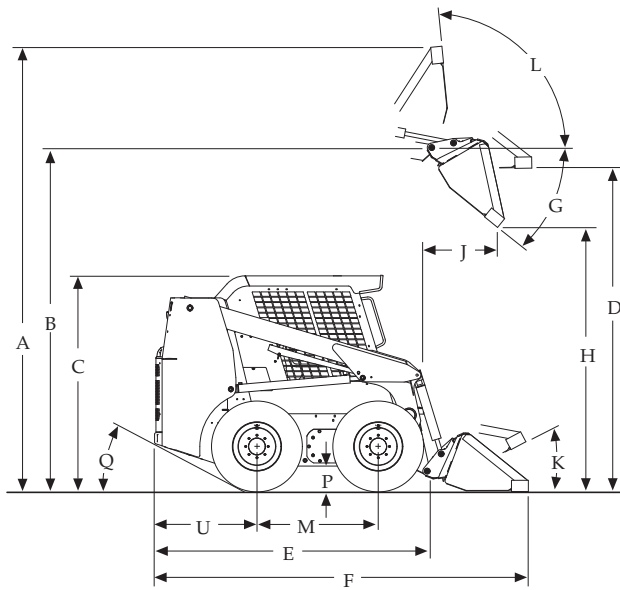

DIMENSIONS

- A. Overall operating height**
 w/foundry/excavating bucket – short lip 152.4" (3.87 m)
 w/low profile bucket – standard lip 158.0" (4.01 m)
 w/low profile extended bucket – long lip 163.0" (4.14 m)
- Height to*
- B. Bucket hinge pin** 121.5" (3.09 m)
- C. Top of rollover protective structure** 76.7" (1.95 m)
- D. Bottom of level bucket, loader arm fully raised** 114.2" (2.90 m)
- Overall length
- E. w/o attachment w/coupler** 103.9" (2.64 m)
- F. w/foundry/excavating bucket on ground** 127.2" (3.23 m)
- F. w/low profile bucket on ground** 132.9" (3.38 m)
- F. w/low profile extended bucket on ground** 137.9" (3.50 m)
- G. Dump angle at maximum height** 39°
- H. Dump height – loader arm fully raised**
 w/foundry/excavating bucket 96.6" (2.45 m)
 w/low profile bucket 93.1" (2.37 m)
 w/low profile extended bucket 90.0" (2.29 m)
- J. Reach – loader arm fully raised**
 w/foundry/excavating bucket 21.3" (0.54 m)
 w/low profile bucket 25.9" (0.66 m)
 w/low profile extended bucket 29.7" (0.75 m)
- Maximum attachment rollback
- K. Bucket on ground** 32°
- L. Bucket at full height** 84°
- M. Wheelbase** 43.1" (1.10 m)
- Ground clearance
- P. Bottom of belly pan** 9" (229 mm)
- Q. Angle of departure** 28°
- Clearance circle front
- R. less bucket** 50.3" (1.28 m)
- S. w/66" (1.68 m) foundry/excavating bucket on ground** 76.7" (1.95 m)
- S. w/66" (1.68 m) low profile bucket on ground** 81.9" (2.08 m)
- S. w/66" (1.68 m) low profile extended bucket on ground** 83.1" (2.20 m)
- T. Clearance circle rear** 59.1" (1.50 m)
- U. Rear axle to bumper** 36.6" (0.93 m)
- V. Tread width, centerline to centerline** 52.6" (1.34 m)

NOTE: *Equipped with 12.00 x 16.5 Solideal Hauler SKS tires.

PERFORMANCE SPECS

- Operating load 2,000 lb (908 kg)
 Tipping load 4,000 lb (1815 kg)
 Breakout force
 Lift cylinder 4,664 lbf
 (20 747 N)
 Bucket cylinder 5,885 lbf
 (26 178 N)
- Dig depth
 w/bucket flat 0" (0 mm)
- Cycle time
 Raise 4.1 seconds
 Lower 3.2 seconds
 Dump 2.4 seconds
 Rollback 1.9 seconds

NOTE: SAE rated lift capacities. Breakout force and cycle time measured with rated load in D/F bucket.

OPTIONAL BUCKETS

Type	Width inch (m)	Weight lb (kg)	Heaped
			Capacity ft ³ (m ³)
Foundry/			
Excavating ...	60	270	11.5
	(1.5)	(122)	(0.33)
	66	370	15.2
	(1.6)	(168)	(0.43)
	72	390	16.7
	(1.8)	(177)	(0.47)
	78	495	18.4
	(2.0)	(225)	(0.52)
Low Profile ...			
66	400	13.2	
(1.6)	(181)	(0.37)	
72	425	14.5	
(1.8)	(193)	(0.41)	
Low Profile			
Extended			
60	360	14.3	
(1.5)	(163)	(0.40)	
66	434	15.5	
(1.6)	(197)	(0.44)	
72	477	17.1	
(1.8)	(216)	(0.48)	
78	502	18.6	
(2.0)	(228)	(0.53)	
Utility/Light			
Material			
60	350	19.7	
(1.5)	(159)	(0.56)	
72	434	23.7	
(1.8)	(197)	(0.67)	
84	497	27.9	
(2.1)	(225)	(0.79)	
Manure/			
Slurry			
60	340	16.7	
(1.5)	(154)	(0.47)	
72	465	19.1	
(1.8)	(211)	(0.54)	

STANDARD EQUIPMENT

OPERATOR'S COMPARTMENT

ROPS/FOPS canopy w/side screens
Tilt ROPS/FOPS
Instrument panels
Water-shedding vinyl seat
2" (51 mm) retractable seat belt
Hand throttle
Ergonomic hand controls
Seat bar w/integral armrests
Loader control lockout system
Floor cleanout panel

LOADER

Radial loader arm design
Mechanical attachment coupler

ENGINE

Case 4T-390 diesel (turbo)
Automatic fan belt tensioner
Integral engine oil cooling
Fuel filter w/water trap
Dual element air cleaner
65 amp alternator
610 CCA 12-volt battery
Heavy-duty radiator

POWERTRAIN

Hydrostatic four wheel drive
Servo controls
ASA #100HS drive chain
Parking brakes

HYDRAULICS

Auxiliary hydraulics 3000 psi
(207 bar) – 21.0 gpm (79.4 L/min)
Hydraulic circuit pedal lock
Loader arm-mounted ISO flat face
connectors
Loader function lockout system
Loader lockout override
3-spool loader control valve
Heavy-duty swing-out oil cooler
Loader arm float position

OTHER

Integral bumper counterweight
Lockable service access hood
Single-point daily servicing
Halogen lights, 2-front, 1-rear
Rear tail lights

OPTIONAL EQUIPMENT

OPERATOR'S COMPARTMENT

Vinyl suspension seat w/2"
(51 mm) retractable seat belt
Vinyl suspension seat w/3"
(76 mm) retractable seat belt
Auxiliary front electric controls
Chassis options harness
Lexan® front door
Glass front door w/wiper & washer
Sliding side windows
Heater (deluxe)
Rear window w/emergency escape
feature
Top window
Foot throttle
Accessory power outlet

LOADER

Ride control
Hydraulic attachment coupler
Hydraulic two-way self-leveling

HYDRAULICS

High-flow auxiliary hydraulics
3000 psi (207 bar)
31.9 gpm (121 L/min)

ENGINE

Coolant block heater
Thermostart

OTHER

Backup alarm
Rotating beacon
Lift hooks
Horn
Special paint
Language decals
Factory-installed tires – see page 2
Buckets – see page 3
Bolt-on bucket cutting edges
42" (1.07 m) and
48" (1.22 m) pallet forks
Model D125 backhoe
Auxiliary front electric
Ride control
Remote jump start
Battery disconnect switch
Automatic engine shutdown system
Steel tracks

FIELD-INSTALLED OPTIONS

Floor heater
Auto-engine shutdown

NOTE: All specifications are stated in accordance with SAE Standards or Recommended Practices, where applicable.

NOTE: All engines meet current EPA emissions requirements.

IMPORTANT: CNH America LLC reserves the right to change these specifications without notice and without incurring any obligation relating to such change. CNH America LLC does not warrant the safety or reliability of attachments from other manufacturers.

Case is a registered trademark of CNH America LLC. Any trademarks referred to herein, in association with goods and/or services of companies other than CNH America LLC, are the property of those respective companies.



www.casece.com



CASE IS A BRAND OF CNH, A GLOBAL LEADER FOR CONSTRUCTION EQUIPMENT, AGRICULTURAL EQUIPMENT AND FINANCIAL SERVICES.