



HAY MACHINES PRODUCT SUPPORT KITS

DISC MOWERS • MOWER CONDITIONERS • WINDROWERS • SMALL SQUARE BALERS
LARGE SQUARE BALERS • ROUND BALERS • RAKE KITS • REMANUFACTURED PARTS
ACCESSORIES & MAINTENANCE



2014-15
EDITION



DISC MOWERS/MOWER CONDITIONERS/WINDROWERS



DISC MOWERS/MOWER CONDITIONERS/WINDROWERS

SECTIONS & GUARDS

Study the Fine Points of Case IH Cutting Parts' Quality

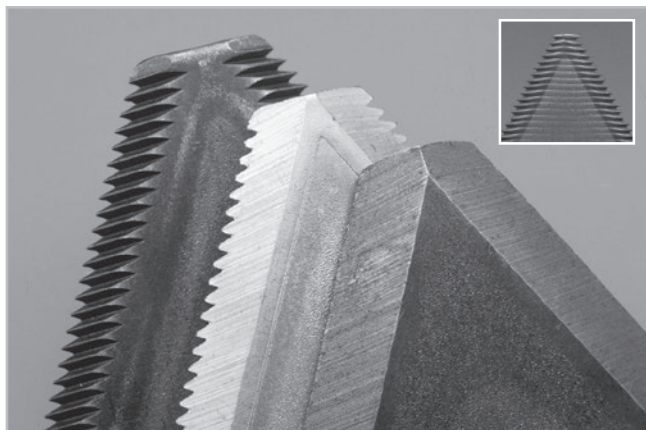

TOP-SERRATED, UNDER-SERRATED OR SMOOTH

Here, an evolution is taking place. The Case IH coined, top-serrated design controls the movement of abrasive material, creating visible wear lines from the serrations on one cutting edge to corresponding serrations on the opposite cutting edge (see inset). By diverting much of the wear from the points of the teeth to the bottoms of the "V", teeth retain shape and sharpness even though the section has worn farther than the depth of the original serrations. Under-serrated sections must be hand sharpened to retain their original profile. Smooth sections are the old standby for fine, grassy and wiry conditions.



BLACK OR ZINC PLATING

Black versus zinc plating — which is best? Both are good and Case IH will continue to offer both, but the performance gap between the two is growing smaller. Originally, superior durability gave the zinc plated section a marked advantage in abrasive soil, despite its higher price. Today, that advantage still exists, but the self-sharpening, reshaping action of the coined top-serrated design has added many hours and acres of useful life to the black section, making it the better value under a wider range of conditions.

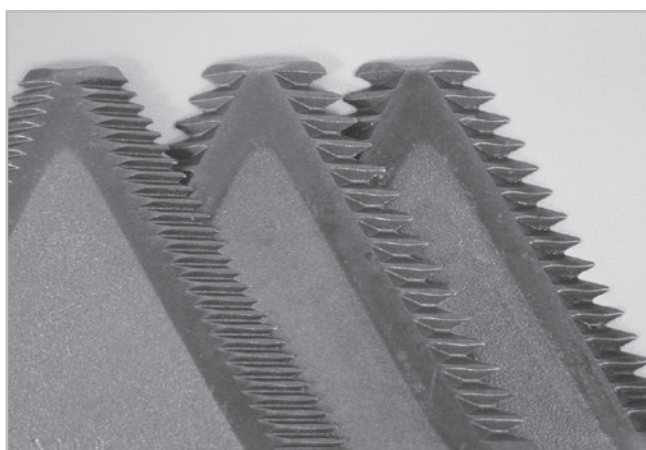

STANDARD, STA SHARP OR SUPER STA SHARP SERRATIONS

There's a place for each type. Case IH STA Sharp serrated sections have grown in popularity for particular field conditions. With 9- or 13-deep serrations per inch, instead of 14, STA Sharp serrated sections are especially efficient for harvesting coarse, dry-stemmed crops. However, the standard (14-per-inch serrations) sections are more versatile and the better choice for most conditions.

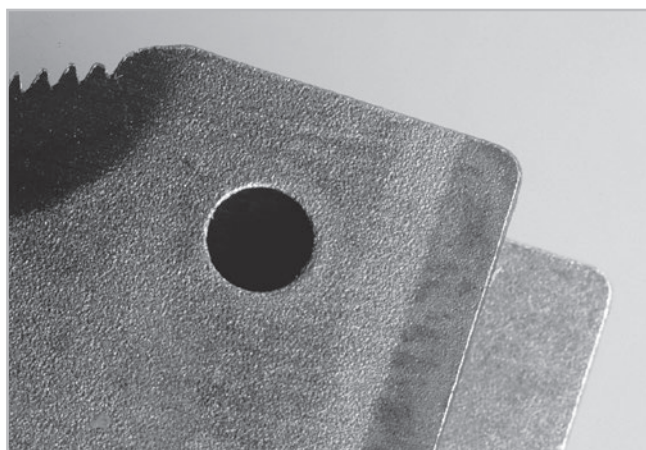

BACK-HARDENED SECTIONS

The back edge of all Case IH sickle sections is hardened to the same degree as the mating surface of the guard or wearplate. In addition to superior durability, this assures an even rate of wear between the two mating surfaces and eliminates the need for frequent adjustment.

DISC MOWERS/MOWER CONDITIONERS/WINDROWERS

SECTIONS & GUARDS

GUARDS

- Kits include guards, hold-down clamps, shims and hardware
- A knife is not included – knives are available Case IH with different type sections to best match cutting requirements
- OE component
- One box, one part number, one price

PART NUMBER	APPLICATION
87298413	SMX91
87298419	HDX142
87298420	HDX162
87298421	HDX182

- A** Case IH employs high industry standards using a special heat treatment on the back bar to reduce wear between the guard and the section.
- B** Case IH applies an additional induction-hardening process to the trash bar as well. This maintains a more durable surface for peak performance and long service life.
- C** Case IH applies an additional induction hardening process to the ledger areas to provide a longer wear-sharp surface for more efficient cutting. These ledger areas are also wider for additional service life.

Today's machines have increased cutting demands. Made for durability and longer service life, Case IH guards provide top performance in all harvest conditions.

GUARDS	SECTIONS	KNIVES
86615982 – Main Guard	86616527 – XH TS PL BK	86616061 – 6' LH
86615984 – End Guard	86615988 – XH TS BL BK	86616062 – 6' RH
858767 – Center guard	86616588 – XH BL BK	86616059 – 7' LH
	86616591 – XH PL BK	86616060 – 7' RH
	86616691 – XH BT BL BK	86616057 – 8' LH
	67631 – R TS BL BK	86616058 – 8' RH
	67630 – R US BL BK	86616055 – 9' LH
		86616056 – 9' RH

Section Terminology

BK = Backhardened	XH = Extra Heavy Thickness
PL = Zinc Plated	US = Underserrated
BL = Black Finish	TS = Top Serrated
R = Regular Thickness	BT = Big Tooth (10 serration/inch)

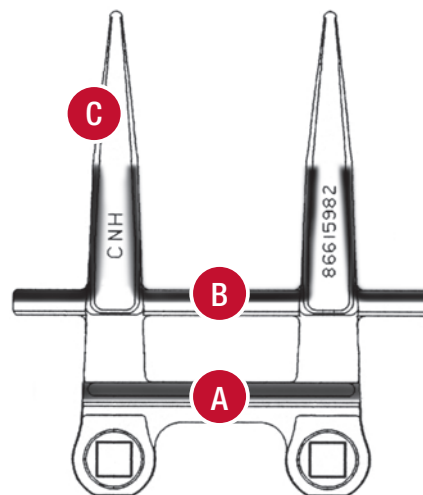

DISC MOWERS/MOWER CONDITIONERS/WINDROWERS

SECTIONS & GUARDS

STUB GUARD CONVERSION KIT

Application: HDX142, HDX162, HDX182

- Kit includes stub guards, plates, shims, adjustable hold-down clips and mounting hardware
- Includes OE components to convert from a standard guard system to a stub guard system

PART NUMBER	DESCRIPTION
87399670	14'
87399912	16' and 18'

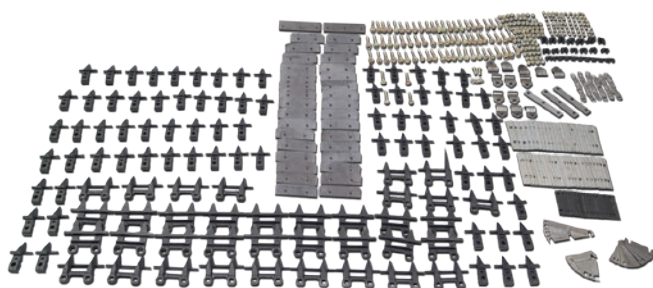

PART NO. 87399912

HARDWARE KITS

PART NUMBER	DESCRIPTION
86512289	1/2" Bolt and Nut Kit
86507778	7/8" Bolt and Nut Kit
86517390	3/4" Bolt and Nut Kit
86507779	1" Bolt and Nut Kit
86507777	Knife and Bolt Kit



PART NO. 86512289



PART NO. 86507777

KNIFE SECTION

- Case IH offers a complete selection of knife sections. This includes 3" and 1-1/2" chrome and plain sections with 7, 10 or 14 serrations per inch.

- For a complete selection ask your dealer

Part No. 86616527



OVERLAP KIT FOR TWIN SICKLE APPLICATIONS

- Kit includes sections and hardware to complete the overlap portion of the two knife assemblies
- OE components
- Handy service pack
- HDX Series

Part No. 86616634



(PACKAGED)

DISC MOWERS/MOWER CONDITIONERS/WINDROWERS

DISC MOWER KNIVES

We Own the Cutting Edge

Case IH Mower Knives are superb quality disc mower knives. They boast a number of design features that help them cut smoother, last longer and operate more safely than other knives. Furthermore, each and every production lot is subjected to a rigorous battery of tests to ensure performance standards are met. Each knife bears a stamped Traceable Sequential Lot Number, a unique number that permits tracing the knife back through all of its manufacturing processes.

Manufactured for Maximum Performance

From raw material specification to the last production process, extra care has been taken to assure optimum performance and durability.

- The cutting edge is milled, not rolled, for improved sharpness. The milled edge does not extend past the bolt holes, for increased strength.
- The new, radial-twist design improves lifting action for a smoother cut.
- Disc knives are austempered for better impact absorption.
- Knives are available in 3, 4 or 5 mm thicknesses with bevel-up, bevel-down or bevel-opposite knife styles.

Traceable Sequential Numbering System Confirms Our Commitment to Do It Right

Every production lot is tested against ISO specifications, then the manufacturing and testing processes are verified by stamping a traceable sequential number on each knife. In addition, tests are performed to satisfy standards set by Case IH – standards that exceed ISO requirements.

- Incoming material is inspected, then tagged for traceability.
- Bend tests are performed to guard against cracking.
- Impact tests are used to check structural integrity.
- Cross section analysis assures optimum metallurgical grain structure.



Our Disc Mower Knives are manufactured in three thicknesses for light, medium and heavy-duty applications.



The new radial-twist design extends down and across the central area of the blade for better lifting action. For more information on rotary disc mower knives, refer to PM-16524.



Cross sections are examined under a microscope for proper grain pattern.



Bend tests are performed on each production lot to determine if cracks are present.



Impact tests check the knives' ability to flex and absorb shock and not shatter into pieces should they hit obstructions.

DISC MOWERS/MOWER CONDITIONERS/WINDROWERS

ROTARY DISC MOWER BLADE SELECTION

DISC MOWER KNIFE WITH HARDWARE IN HANDY SERVICE PACKS

Application: Disc Mowers: DCX101, DCX131, DCX132, DCX161 with lifters; Windrower Heads: RDX161, RDX162, RDX181 with lifters

PART NUMBER	DESCRIPTION/TYPE PITCH/ROTATION
87298470	7° Twist CW
87298471	7° Twist CCW
87298469	14° Twist CCW
87298466	14° OS (Serrated) CW
87298472	"V" Rock Blade



PART NO. 87298472



DISC MOWERS/MOWER CONDITIONERS/WINDROWERS

ROTARY DISC MOWER BLADE SELECTION

7° TWIST KNIVES

The 7° twist knives are recommended for abrasive soil and rocky crop cutting conditions. These knives function well in a wide range of field and cutting conditions.



PART NUMBER	DESCRIPTION/TYPE PITCH/ROTATION
9847683	Knife – 7° Twist CW
9847684	Knife – 7° Twist CCW

18° KNIVES

The 18° twist knives are standard on RD163 and RD193 self-propelled windrower heads. The 18° twist provides for a close cut and high lift for superior material flow.



PART NO. 84271203

PART NUMBER	DESCRIPTION/TYPE PITCH/ROTATION
84271203	Knife – 18° Twist CW
84271205	Knife – 18° Twist CCW

14° TWIST KNIVES (STANDARD EQUIPMENT) & 14° TWIST SERRATED KNIVES

The 14° twist knives are recommended for most crop conditions. The greater twist angle enables the knife's cutting edge to cut closer to the ground and provide more lifting action to move the crop over the cutter bar into the conditioner, producing a cleaner cut. The greater twist angle in these knives makes them more susceptible to rock damage.



STANDARD



SERRATED

PART NUMBER	DESCRIPTION/TYPE PITCH/ROTATION
86621872	Knife – 14° Twist CW
86621873	Knife – 14° Twist CCW
87029587	Knife – 14° Twist OS CW
87029588	Knife – 14° Twist OS CCW

7°KNIVES

The 7° twist knives are available for the RD163 and RD193 self-propelled windrower heads. These knives function well in a variety of crop conditions and are less susceptible to rock damage.



PART NO. 84343225

PART NUMBER	DESCRIPTION/TYPE PITCH/ROTATION
84343225	Knife – 7° Twist CW
84343226	Knife – 7° Twist CCW

“V” ROCK BLADE KNIVES

The “V” knives are recommended for operation in rocky conditions where excessive knife bending is a concern. This style knife has greater resistance to bending when coming in contact with a foreign object. The cutting quality of this knife is not as good compared to the twisted knives.

Part No. 86532078



DISC MOWERS/MOWER CONDITIONERS/WINDROWERS

PRODUCT SUPPORT KITS/KNIFE KITS

COMPLETE KIT OF DISC MOWER KNIVES & HARDWARE

- Complete set of knives and attaching hardware
- OE knives and hardware
- 7°, 14°, 14° OS (serrated) and “V” Rock blade kits
- One box, one part number, one price

PART NUMBER	TWIST	ROTATION	NUMBER OF KNIVES
APPLICATION: DCX101			
87298597	7°	Both	8 CCW and 8 CW
87298593	14°	Both	8 CCW and 8 CW
87298601	“V” Rock Blade	–	16 “V” Blades
APPLICATION: DCX131, RDX131, RD132			
87298598	7°	Both	10 CCW and 10 CW
87298594	14°	Both	10 CCW and 10 CW
87298602	“V” Rock Blade	–	20 “V” Rock Knives
APPLICATION: DCX161, DCX162, RDX161, RD162			
87298599	7°	Both	12 CCW and 12 CW
87298595	14°	Both	12 CCW and 12 CW
87298605	14° OS (Serrated)	Both	12 CCW and 12 CW
87298603	“V” Rock Blade	–	24 “V” Rock Knives
APPLICATION: RDX181			
87298600	7°	Both	14 CCW and 14 CW
87298596	14°	Both	14 CCW and 14 CW
87298606	14° OS (Serrated)	Both	14 CCW and 14 CW
87298604	“V” Rock Blade	–	28 “V” Rock Blades

KNIFE KIT WITH LIFTERS

- Complete set of knives
- Forged lifters included
- OE knives, lifters and hardware
- 7°, 14°, 14° OS and “V” rock knife kits
- One box, one part number, one price

PART NUMBER	TWIST	ROTATION	NUMBER OF KNIVES
APPLICATION: DCX101			
87298621	7°	Both	8 CCW and 8 CW
87298611	14°	Both	8 CCW and 8 CW
87298615	“V” Rock Blade	–	16 “V” Rock Blade
APPLICATION: DCX131, RDX131, RD132			
87298622	7°	Both	10 CCW and 10 CW
87298612	14°	Both	10 CCW and 10 CW
87298616	“V” Rock Blade	–	20 “V” Rock Blade
APPLICATION: DCX161, DCX162, RDX161, RD162			
87298623	7°	Both	12 CCW and 12 CW
87298613	14°	Both	12 CCW and 12 CW
87298619	14° OS (Serrated)	Both	12 CCW and 12 CW
87298618	“V” Rock Blade	–	24 “V” Rock Blade
APPLICATION: RDX181			
87298624	7°	Both	14 CCW and 14 CW
87298614	14°	Both	14 CCW and 14 CW
87298620	14° OS (Serrated)	Both	14 CCW and 14 CW
87298617	“V” Rock Blade	–	20 “V” Rock Blade



PART NO. 87298611

DISC MOWERS/MOWER CONDITIONERS/WINDROWERS

LIFTER KITS

CROP LIFTER KITS

Application: DCX101, DCX131, DCX161, RDX161, RDX181, DC101, DC102, DC132, DC162, RD162, RD182

- Heavy-duty forged lifters
- OE components
- Two lifters and hardware included
- Standard packaging
- Lifters are designed to lift the crop into the conditioning rolls
- Current kit available from Case IH depots

PART NUMBER	ROTATION
87528245	CW
87528249	CCW



DEALER INSTALLED ACCESSORIES

WIDE THIN FIN KIT

Application: DC102, DC132, DC162 Disc Mower Conditioners

- The wide, thin fin kit allows the crop windrow to be spread 90% to 100% of the cutting width. This speeds the crop dry-down, decreasing the risk of rain damage to the crop. Also, fast dry-down reduces energy consumption by respiration, thus improving feed value.

Part No. 84267895



AKCELA[®]

LUBRICANTS

NEW

HY-TRAN ULTRACTION[™] TRANSMISSION OIL WITH ADDED GRUNT

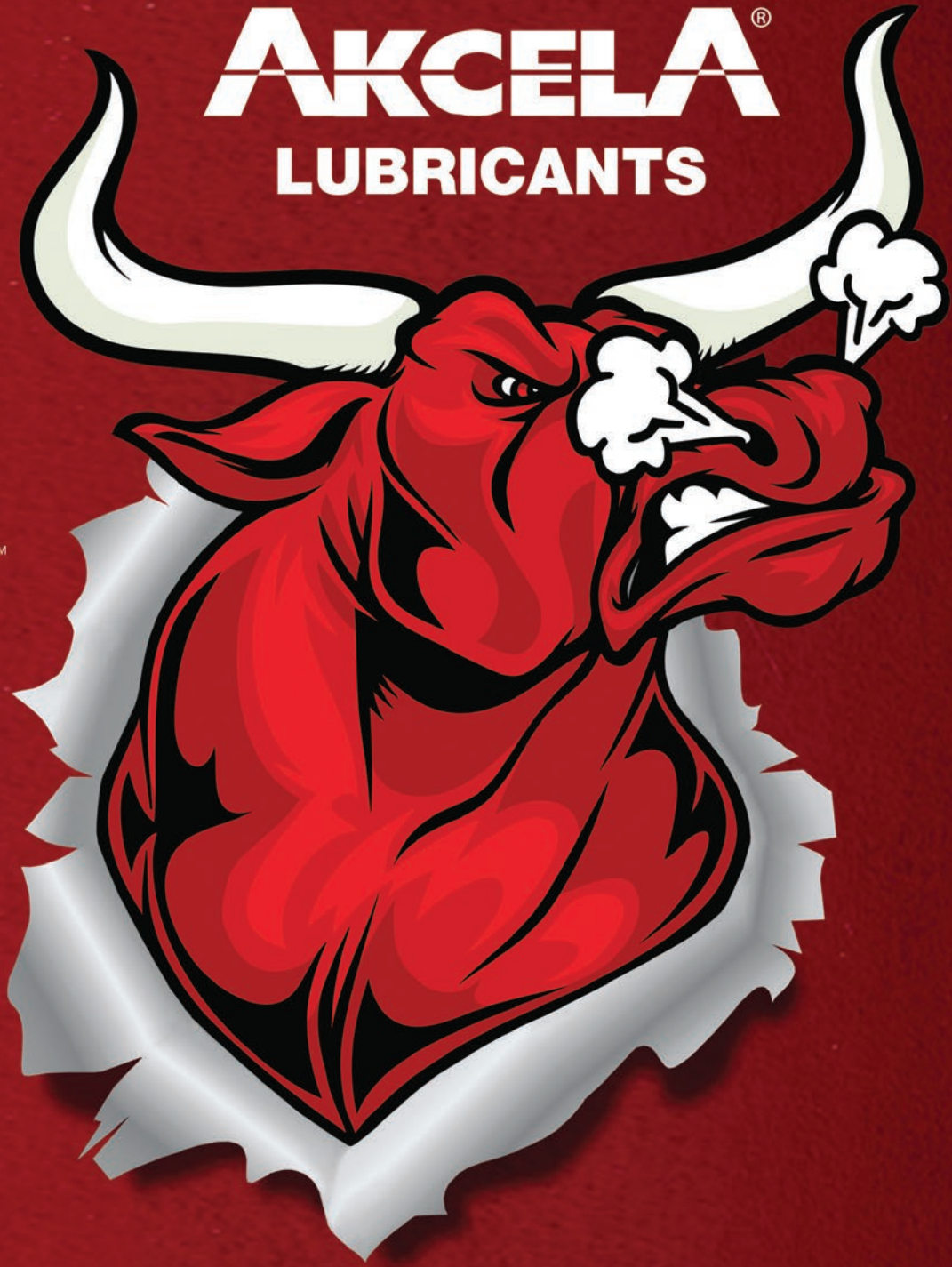

New Hy-Tran Ultrauction[™] is the only transmission lubrication with added grunt to handle the high temperatures and heavy workload of today's modern machinery. Its unique formula has been beefed up to give your equipment ultra protection and even longer life.



caseihparts.com.au

DISC MOWERS/MOWER CONDITIONERS/WINDROWERS

SKID SHOE KITS/DISC MOWER ROCK GUARD KITS

SKID SHOE KITS

Application: DCX101, DCX131, DCX132, DCX161, RD132, RD162, RDX131, RDX161, RDX181, DC162, DC101, DC102, DC132, DC162

- Kits include skid shoes and hardware
- OE parts
- Painted, ready to install
- Available as a pair, five-pack, six-pack, seven-pack and eight-pack. Combine packs to completely update the skid shoes on a Case IH disc mower.

PART NUMBER	PACK QUANTITY
87297018	2-Pack
87297979	5-Pack
87298983	6-Pack
87298984	7-Pack
87298985	8-Pack



EXTENDED-WEAR SKID SHOE

Application: All DCX, DC, RDX and RD Series disc mower, disc mower conditioner and windrower heads. **(except RD163 & RD193)**

This heat treated, extended-wear skid shoe is available for use in abrasive soil conditions. Tests show this skid shoe wears up to 2.5 times longer than the standard skid shoe.

Part No. 84141953



DISC MOWER ROCK GUARD KITS

Application: DCX101, DCX131, DCX161, DCX162, RD162, RDX161, RDX181

- Kit includes rock guards and mounting hardware
- Heavy-duty cast guard designed to protect the module on the mower
- OE components
- Available as a pair, five-pack, six-pack, seven-pack and eight-pack. Packs completely update the rock guards on Case IH disc mowers and mower conditioners.

PART NUMBER	PACK QUANTITY
87297019	2-Pack
87298975	5-Pack
87298976	6-Pack
87298981	7-Pack
87298982	8-Pack



THE COST OF A FILTER GOES BEYOND WHAT YOU PAY FOR IT

A filter's purpose is to extend the life of your equipment by protecting it from harmful contaminants. Lower-quality filters may save you some money at the counter, but their inferior protection can cost you greatly in the long run.

The smallest particles are often the most damaging. Many will-fitters miss these fine particles, which results in gradual damage that often goes unnoticed – until it's too late.

Case IH filters offer advanced design and durable construction that is rigorously tested by CNH Engineering to ensure you get the best heavy-duty protection for your equipment.



THE HEAVY DUTY DIFFERENCE:

1. SUPERIOR MEDIA

Synthetic, multi-layer, gradient density media outperforms competitive cellulose and paper media 2-to-1.

2. TWO-STAGE DESIGN

Additional stacked-disc section removes the finest contaminant particles that can cause the most engine wear.

3. HOT MELT

This high-quality adhesive keeps filter media from bunching and rupturing under the intense pressure common with off-road equipment.

4. HEAVY-DUTY RETAINER

Unlike spacers used by will-fitters, a leak-stopping spring resists vibrations to keep filter elements in place.

5. METAL END CAPS AND CENTRE TUBES

Cardboard components used by many competitive manufacturers are susceptible to breakdown from moisture.

6. RUBBER SEALS

Unlike cardboard seals that can deteriorate and leak, our rubber seals provide a tight, even seal that prevents unfiltered oil from re-entering your system.

7. RUGGED CONSTRUCTION

Case IH filters are routinely tested to meet rigorous quality standards.

DISC MOWERS/MOWER CONDITIONERS/WINDROWERS

BEARING & BUSHINGS KITS

WHEEL BEARING KIT

Application: DCX131, DCX161, DC132, DC162, SCX100 Mower Conditioner

- Kit includes bearing cups, cones, cap and hardware
- Handy service pack
- OE components

Part No. 87298567



WHEEL BEARING KIT

Application: DC102 Disc Mower Conditioners

- Kit includes bearing cups, cones and hardware
- OE components
- Handy service pack

Part No. 87298555



REEL BEARING KIT

Application: HDX141, HDX161, HDX181, HDX142, HDX162, HDX182 Headers, SMX91 Mower Conditioners

- Kit includes bearing and hardware
- Handy service kit
- OE components

Part No. 87298556



BUSHING KIT – CUTTERBAR

Application: DCX101, DCX131, DCX161, DCX162, RD132, RD162, RD182, RDX161, RDX181, DC101

- Handy service pack for shop or tool box

Part No. 87298425



REEL BUSHING KIT

Application: SMX91 Mower Conditioners

- Kit includes housing, bushing and hardware
- Handy service kit
- OE components

Part No. 87298558



BUSHING KIT – UPPER CONDITIONING ROLLS

Application: DCX101, DCX131, DCX161, RD162, RDX161, RDX181, DC102, DC132, DC162, HDX121, HDX141, HDX161, HDX181, HDX142, HDX162, HD182, RD182

- Kit includes bearing, flanges and hardware
- OE components
- Handy service pack

Part No. 87298430



DISC MOWERS/MOWER CONDITIONERS/WINDROWERS

COMPLETE DISC ASSEMBLIES

COMPLETE DISC ASSEMBLIES WITH LIFTERS

Application: DCX101, DCX131, DCX161, RD132, RD162, RD182, RDX131, RDX161, RDX181, DC102, DC132, DC132F, DC162, DC92, DC132, DC162, DC182, TD102, MD72, MD82, MD92, MDX71, MDX81, MDX91

- Complete disc assemblies
- Knives and lifters installed
- Ready to install on disc mower gear boxes
- Painted and boxed
- One complete disc assembly per part number

PART NUMBER	TWIST	ROTATION
87298442	7°	CCW
87298443	7°	CW
87298440	14°	CCW
87298441	14°	CW
87298438	14° OS (Serrated)	CCW
87298439	14° OS (Serrated)	CW
87298444	"V" Rock Blade	CW



PART NO. 87298441

COMPLETE DISC ASSEMBLIES

Application: MDX71, MDX81, MDX91, MD72, MD82, MD92

- Complete disc assemblies
- Knives installed
- Ready to install on disc mower gear boxes
- Painted and boxed
- One complete disc assembly per part number

PART NUMBER	TWIST	ROTATION
87298434	7°	CW
87298435	7°	CCW
87298436	14°	CW
87298437	14°	CCW

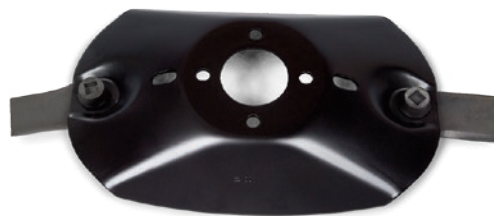

PART NO. 87298434

COMPLETE DISC MODULE KITS

Application: MDX71, MDX81, MDX91, DCX101, DCX131, RD132, RD162, RDX131, RDX161, RDX181, Machines 2008 and since, except RD163 and RD193

- Complete module kit
- Includes control module (gear box) top cap kit and hub
- OE parts and components
- One module per part number
- Ready to install



Kits with Shock Protection System (Includes top cover)

PART NUMBER	ROTATION
87299155	CW
87299156	CCW

DISC MOWERS/MOWER CONDITIONERS/WINDROWERS

SHOCK PROTECTION SYSTEM HUB KITS

Reduce Downtime and Lower Repair Costs with the New Shock Protection System Hub Kits

- The Shock Protection System Hub Kits are designed to provide shock protection to the individual cutter bar modules should the knives contact larger obstacles.
- The shock hub reduces the number of splines, which will shear off before failing of cutter bar gear teeth. It also provides protection for the top cap assembly.
- Retro fit kit includes a hub seal which prevents metal fines from entering module components and damaging them.
- Clamp loading on the shock hub drives the disc after shearing to prevent domino effect failures by allowing disc to partially re-time.
- Shock Protection System Hub Retro Fit Kits can be quickly and easily installed. Components and installation instructions are included in the retro fit kit, Part No. 87602273.
- Shock Protection System Hubs can be quickly and easily repaired. Components and installation instructions are included in the repair kit, Part No. 87580643.

SHOCK PROTECTION SYSTEM HUB RETRO FIT KIT

Includes components for two (2) modules.

Part No. 87602273



SHOCK PROTECTION SYSTEM HUB REPAIR KIT

Includes component to repair one Shock Protection System module.



PART NO. 87580643
EXCEPT MODELS RD163, RD193
PART NO. 84393813 (MODELS RD163, RD193)

ROTARY DISC MOWER DISPLAY

- A cut-a-way displaying major kits and components is available for the Case IH disc mower module
- Cut-a-way includes the New Shock Protection Kit components
- Graphics and signage are included

Part No. 87298690A

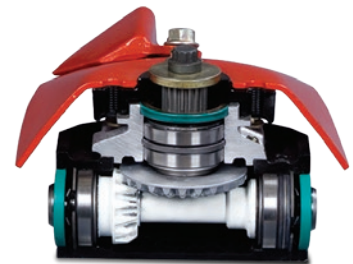

SHOCK PROTECTION SYSTEM HUB KITS

REFERENCE	PART NUMBER	DESCRIPTION
1	87581143	Top Cover
2	86589278	Conical Washer
3	574245	Hardened Washer
4	87376405	Splined Washer
5	NSS*	Shock Hub
6	87376403	Seal Hub

*Not serviced separately

Part No. 87602273 Shock Protection System Retro Fit Kit contains two (2) each of reference items 1 through 7 above.

Part No. 87580643 Shock Protection System Repair Kit contains one (1) each ONLY of reference items 2, 3, 4 and 6 above.

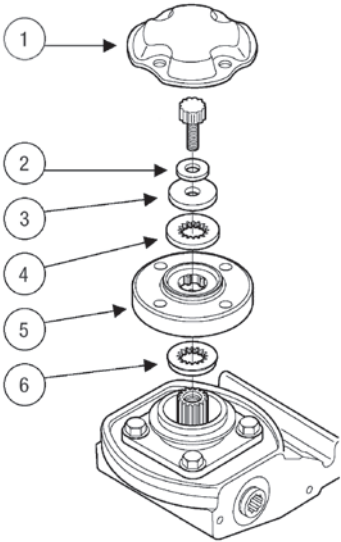

SKID SHOE KIT

Application: SMX91 Mower Conditioner

- Boxed maintenance kit
- Kit includes shoes and mounting hardware
- OE components

The performance and durability is in the superior double heat treatment of critical wear surfaces.

Part No. 87298551



Application/Shock Protection Hub Retro Fit Chart

MODEL	NUMBER OF MODULES TO SHOCK PROTECT (LESS DRIVERS)	NUMBER OF RETRO FIT KITS NEEDED (COMPONENTS TO RETRO FIT TWO MODELS)
DCX101	7	4
DCX131	8	4
DCX161	10	5
RDX161	10	5
RDX181	12	6

IMPORTANT: Driven modules do not use Shock Protection System hubs.

DISC MOWERS/MOWER CONDITIONERS/WINDROWERS

MAINTENANCE KITS

CUTTER BAR SHIM KIT

Application: DCX and DC Series Disc Mower Conditioners

- The purpose of this kit is to straighten cutter bars that are bowed
- The shims are installed between the modules and spacers when securing the module
- Kit includes ten (10) shims

Part No. 87056499



3/4" ROLL GAP BOLTS

Application: DCX101, DCX131, DCX161

- Kit includes rod and nut to upgrade from 5/8" roll gap bolt to 3/4" roll gap bolt
- Bolts increase reliability

Part No. 87042133



FRICTION REPAIR KIT

Application: DCX, DC Series Disc Mower Conditioners

- Kit includes two (2) friction discs and hardware

Part No. 86601404



REPAIR KIT – OVER-RUNNING CLUTCH

Application: DCX101, DCX161, DCX, DC Series Disc Mower Conditioners

- Kit includes leaf spring, wave spring hardware and instruction sheet

Part No. 86572966



DISC MOWERS/MOWER CONDITIONERS/WINDROWERS

MAINTENANCE KITS

SPARE KNIFE HOLDER

Application: SMX91

- Holds spare knife
- Convenience kit
- Includes holder and hardware

Part No. 201725

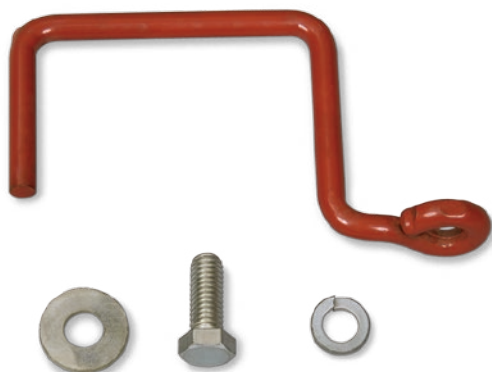

WEAR PLATE KIT

Application: HDX Series Headers

- Wear plate for conditioner roll throat openers
- OE components



PART NO. 86540464 – LH (SHOWN)
PART NO. 86540465 – RH

LEFT HAND REEL SPIDER TIP REPAIR KIT

Application: HDX122, HDX142, HDX162, HDX182

- Holds spare knife
- Convenience kit
- Includes holder and hardware

Part No. 87010400



COMPLETE WOBBLE BOX

Application: HDX142, HDX162, HDX182

- Kit includes a factory assembled and tested wobble box with mounting hardware
- Reduces downtime



PART NO. 87024139
(REMAN) 87024139R

DISC MOWERS/MOWER CONDITIONERS/WINDROWERS

MAINTENANCE KITS

HEADER PUSH BAR EXTENSION KIT

Application: HDX142, HDX162, HDX182

- Kit includes push bar extension brackets and hardware

Part No. 86637579



WOBBLE BOX TOOL KIT

Application: HDX142, HDX162, HDX182

- Kit is designed specifically for the short wobble box assemblies
- Kit makes the disassembly and re-assembly of the wobble assembly faster and easier

Part No. 87039356



DISC MOWERS/MOWER CONDITIONERS/WINDROWERS

MAINTENANCE KITS & ASSEMBLIES

MODULE GEAR BOX

Application: DC, DCX, RD, RDX and Mower Conditioners (except RD163, RD193)

- Module gear box assembly includes the gear box housing and pinion kit
- Factory assembly ensures maximum performance
- OE components

PART NUMBER	ROTATION
84220789	CW
84220790	CCW

Application: RD163, RD193

PART NUMBER	ROTATION
84389131	CW
84389133	CCW



PART NO. 84220789 (SHOWN)

GEAR BOX PINION KIT

Application: DC, DCX, RD, RDX and Disc Mower Conditioners (except RD163, RD193)

- OE components
- Kit includes bearings, pinion, seals, hardware and snap rings
- OE components
- For both CW and CCW modules

Part No. 84220791



KNIFE KIT

Application: Mower Conditioners

- OE components
- Impact tested and approved
- Knives made in USA
- Kit includes both CW and CCW knives

PART NUMBER	DESCRIPTION	TWIST
87037027	16 each/87029587, 87029588	14° (Serrated)
86624751	10 each 86621872, 86621873	14° (Plain)
86624752	16 each 86621872, 86621873	14° (Plain)

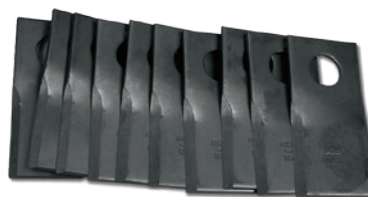

PART NO. 86624751 (SHOWN)

TOP CAP KIT

Application: DCX131, RD132, RD161, RDX131, RDX162, RDX181

- Kit consists of bevel gear, bearing set, hub seal, housing pre assembled for easy replacement and hardware
- OE components
- Non-Shock protection only

Part No. 87753841



SMALL SQUARE BALERS



PRODUCT SUPPORT KITS

BALER PICKUP TINE KIT

Application: SBX540

- Kit includes (six) 6 tines (86551419) and hardware
- Box kit with OE components

Part No. 87012136



PLUNGER KNIFE KIT WITH HARDWARE & SHIMS

Application: SBX540, SB541

- Kit includes plunger knife (625972) and hardware
- Boxed kit with OE components

Part No. 87012132



BEARING KIT/MAINTENANCE KITS

BALE COUNTER

- Kit includes counter, spring and two (2) #5 nuts
- For small square balers

Part No. 86608973



METER WHEEL KIT

- Kit includes meter wheel, supports, bushings and hardware
- Supports the bale counter
- For SBX Series small square balers

Part No. 86979308



KNIFE KIT – TWINE

- Kit includes knife and mounting hardware
- For small square balers

Part No. 84204817





CASE IH POWER IN THE PALM OF YOUR HAND

There are a lot of things our heavy equipment does well. For everything else, there's Case IH Hand Tools. They're built to the very tough standards you've come to expect from us. From Needle Nose Pliers to Air Impact Wrenches, we've got every tool for every job.



For more information contact
your Case IH dealer today or
go to www.caseihparts.com.au



PRESSURE WASHERS | WATER PUMPS | GENERATORS | COMPRESSORS | HEATERS



CASE IH POWER. WHERE YOU NEED IT. WHEN YOU NEED IT.

Power Equipment that maximises your productivity day in and day out.



CASE IH
AGRICULTURE

For more information contact your Case IH dealer today or go to www.caseihparts.com.au

LARGE SQUARE BALERS



GET READY TO ROLL WITH CASE IH NET & TWINE



Case IH is pleased to bring you the new range of Baler Twines and Netwrap, made with world class Cotesi technology.

The affordable option for high performance, ease of use, consistency and strength.

- Large Square Twine 2200m
- Small Square Twine 3000m
- Round Bale Twine 6800m
- Pro-Net Netwrap 1.23m x 3300m

Speak to your Case IH dealer today about our new range of Net and Twine, and be ready to roll this hay season.



LARGE SQUARE BALERS

PRODUCT SUPPORT KITS/KNIFE KITS

TWINE BILL HOOK ASSEMBLY

Application: LBX332, LBX432, LB333, LB433

- Kit includes complete twine bill hook assembly
- OE components
- Handy service pack

Part No. 87645121



TWINE BILL HOOK

PART NUMBER	QUANTITY	DESCRIPTION
9838790	4	Pin
9838791	4	Bill hook tongue



Components available individually
- Not sold as a kit

PICKUP GUARD KIT

Application: LBX322, LBX332, LBX432, LB333, LB433

- Kit includes ten (10) guards (84801614) and hardware
- OE components

Part No. 87298496



TINE KIT

Application: LBX322, LBX332, LBX432, LB333, LB433

- Kit includes twenty-five (25) tines (84074264) and attaching hardware
- OE components

Part No. 87298488



ROTOR-CUTTER KNIVES (INDIVIDUALS)

- Manufactured from high strength steel
- Heat-treated for maximum strength and wear life
- Regular duty or hard surfaced for extended wear life



PART NO. 84056505



PART NO. 84058219

PART NO.	DESCRIPTION
84056505	Regular Duty
84058219	Hard-Surfaced Extended-Wear

ROTOR-CUTTER HARD-SURFACED KNIFE KITS

PART NO.	DESCRIPTION
84110677	33-Knife Kit
84110678	23-Knife Kit



PART NO. 84110678

IF IT'S GENUINE THE QUALITY IS GUARANTEED

When time is of the essence, you can't afford to risk using non-genuine parts. Only Case IH parts are designed for your machine, and are backed by our 12 month warranty.

★ ★ ★
GENUINE PARTS
GENUINE PEOPLE
★ ★ ★

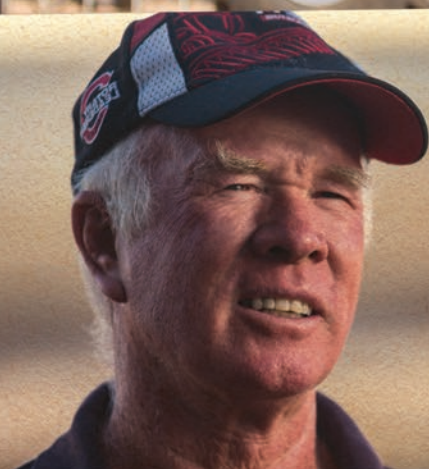

“ Hilton Patterson, Carnamah, WA

Our local Case IH dealers have the parts when we need them, and they're the right parts – it reduces potential problems.



To see more genuine stories, scan the QR code or visit: caseihparts.com.au/genuine



ROUND BALERS



BELTING & ACCESSORIES

Standards a Cut Above the Competition



New Lower Profile 3-Ply
Continuous Chevron Design



Regular Profile 3-Ply
Continuous Chevron Design

Case IH RB and RBX Series Round Balers: New Lower 3-Ply Continuous Chevron Baler Belt Design

- Provides the perfect combination of positive yet gentle grip between crop and belts
- Exclusive lower profile Continuous Chevron design moves crop quickly to the baling chamber for fast and efficient bale starts
- Low profile textured surface releases crop during bale formation for minimal leaf loss
- Features a self-cleaning design for constant performance in the most difficult conditions
- High strength polyester/nylon construction provides the ideal combination of working tension, elongation (under load), and faster retention
- 3-Ply Low Profile Continuous Chevron Endless belts are also available for most RBX and RB Series models. Case IH belts are truly endless with the highest tension rating in the industry.



ROUND BALERS

BELTING & ACCESSORIES

Case IH Round Baler Belt Assemblies and Belt Accessories, Case IH RBX Series Round Balers, New Lower-Profile 3-Ply Continuous Chevron Baler Belt Design

CASE IH MODEL	DEPOT #	DESCRIPTION	DIRECT SHIP #
RBX 443	87056534	7" × 272.5" 3-Ply Low-Profile Chevron/Clipper	ZAH7700271
RB454	87056534	7" × 343" 3-Ply Low-Profile Chevron/Clipper	ZAH7700342
	87042211	7" × 343" 3-Ply Low-Profile Chevron/Rivet	ZAH7700345
		7" × 343" 3-Ply Low-Profile Chevron/Endless	ZAH7700344
RB464	87056535	7" × 420.5" 3-Ply Low-Profile Chevron/Clipper	ZAH7700419
	87042209	7" × 420.5" 3-Ply Low-Profile Chevron/Rivet	ZAH7700422
		7" × 420.5" 3-Ply Low-Profile Chevron/Endless	ZAH7700421

Technical Notes: The newer Low-Profile Continuous Chevron Belts are original equipment for all RBX "3 Series" Balers. This belt style is slightly less aggressive than the standard (taller) profile Continuous Chevron design belts installed on the older RBX Series balers. It is highly recommended that Low-Profile Continuous Chevron belts be installed on RBX "3 Series" balers.

CASE IH MODEL	DEPOT #	DESCRIPTION	DIRECT SHIP #
8420	700700802	4.8" × 364" 3-Ply Mini Rough/Clipper	ZAH4480364
	700720942	4.8" × 364" 3-Ply Mini Rough/Rivet	ZAH4480365
8430	700709185	7" × 366" 3-Ply Cont. Chevron/Clipper	ZAH7700366
	700713890	7" × 366" 3-Ply Cont. Chevron/Titan	ZAH7703661
	700725099	7" × 366" 3-Ply Cont. Chevron/Rivet	ZAH7703662
	700720945	7" × 366" 3-Ply MRT .26 with Titan (late models)	ZAH4700366
		7" × 366" 3-Ply MRT .26 with Rivet (late models)	ZAH4700367
8440	700702917	4" × 452" 3-Ply Chevron/Clipper	ZAH6400452
		4" × 452" 3-Ply Cont. Chevron/Clipper	ZAH7400452
8450/8460	700707162	7" × 570" 3-Ply Cont. Chevron/Clipper	ZAH7700570
	700708740	6.5" × 572.5" 3-Ply Cont. Chevron/Clipper	ZAH7650572
	700713630	7" × 570" 3-Ply Cont. Chevron with Titan	ZAH7705701
		6.5" × 572.5" 3-Ply Cont. Chevron with Titan	ZAH7650573
		7" × 570" 3-Ply Cont. Chevron with Rivet	ZAH7700571
		6.5" × 572.5" 3-Ply Cont. Chevron with Rivet	ZAH7650574
8450/8455	700711998	3.5" × 46.22" 3-Ply MRT Starter Flaps with holes punched	ZAH4350046
8455/8465	700709999	7" × 562.5" 3-Ply Cont. Chevron/Clipper	ZAH7705625
	700713617	7" × 562.5" 3-Ply Cont. Chevron/Titan	ZAH7705621
	700718617	7" × 562.5" 3-Ply Cont. Chevron/Rivet	ZAH7705622
		7" × 562.5" 3-Ply MRT .285/Titan (late models)	ZAH4700562
			ZAH4700563
8460/8465	700711997	3.5" × 61.18" 3-Ply MRT Starter Flaps with holes punched	ZAH4350061

BELTING & ACCESSORIES

CASE IH MODEL	DEPOT #	DESCRIPTION	DIRECT SHIP #
RS451/551	700716049	7" × 475" 3-Ply Cont. Chevron/Titan 7" × 475" 3-Ply MRT/Titan	ZAH7700475 ZAH4700475
RS451	700716010	3.5" × 43.31" 3-Ply MRT Starter Flaps with holes punched	ZAH4350043
RS561	700717717	7" × 547" 3-Ply Cont. Chevron/Titan	ZAH7700547
	700728088	7" × 547" 3-Ply MRT/Titan (late model)	ZAH4700547
RS551/RS561	700717714	3.5" × 58.5" 3-Ply MRT Starter Flap with holes punched	ZAH4350058

CASE IH	DEPOT #	DESCRIPTION	DIRECT SHIP #
IHC241/2400		4" × 430" 2-Ply Smooth/Clipper	ZAH2400430
Bottom Belt		60" × 120" Bottom Belt/No V-Guide	ZAH3600120

Fixed Chamber Balers with Endless Belts

CASE IH	DEPOT #	DESCRIPTION	DIRECT SHIP #
3440 – 8480 Top	700709544	11" × 73.25" 2 MRT/Endless with trash bars	ZAH2110734
3640/3650/8480 Bottom	700709542	11" × 121" 2 MRT/Endless with trash bars	ZAH2111214
3440/3450 Bottom	225969A1	11" × 103.5" 2 MRT/Endless with trash bars	ZAH2111034

Popular Belting Accessories

CASE IH	DIRECT SHIP #	CASE IH	DIRECT SHIP #
CLIPPER HOOK BELT FASTENERS		20 Smart Lock Package Splice Protectors	ZAH9000200
4-1/2" – 4-1/2" Rectangular High Tensile 7" Cards/ten (10) cards per box (Original Equipment Hook for virtually all Balers with 7" wide belts)	ZAH9000202	20 Smart Locks with 5' Duralink Cable	ZAH9000199
4-1/2" – 3" Rectangular High Tensile 7" Cards/eleven (11) cards per box (A shorter piercing point for thinner gauge baler belts)	ZAH9000102	22" Pre-Cut #13 Blue Nylon Steel Rigid Pin/ten (10) per package/Pickup belts	ZAH9002024
#2 Short Point Galvanized 12" Cards/twelve (12) cards per box	ZAH9000010	2' Leader Wire (Rigid) with 15' #332 Cable/Pickup belts	ZAH9000239
#U3 – 2 Unibar Coated Steel 24" Sticks/ten (10) Sticks per box (Both sizes are popular for thinner gauge combine pickup belts)	ZAH9000112	FLEXCO ALLIGATOR RIVET FASTENER	
BELT LACER FOR CLIPPER HOOKS		7" Repair Kit (Repairs 2-7" Belts)	ZAH9000237
R-7 7" Vise Lacer	ZAH9000021	14" Repair Kit (Repairs 2-14" Belts)	ZAH9000239
R-10 10" Vise Lacer	ZAH9000022	Technical Notes: Textured Belt Surface should be skived to a gauge between .180 – .220.	
24" Roller Lacer	ZAH9000026	7" Corrugated Steel Lacing Pins eight (8) Pins per package	ZAH9000257
36" Roller Lacer	ZAH9000027	14" Corrugated Steel Lacing Pins four (4) Pins per package	ZAH9000265
10" Baler Belt Lacer	ZAH9615003	7" Application Rivet Lacing Tool	ZAH9000240
14" Belt Cutter	ZAH9000225	14" Application Rivet Lacing Tool	ZAH9000245
POINT-OF-PURCHASE ACCESSORIES – CABLE & PINS FOR USE WITH CLIPPER HOOKS		TITAN HEAVY-DUTY HINGE PLATE FASTENER	
7" Pre-cut #12 Nylon Covered Rigid Pins/ten (10) per package	ZAH9002012	Titan Belt Lacing 7" Cards/twelve (12) Cards per box	ZAH9000220
7" Pre-cut #332 Nylon Covered Cable/ten (10) per package	ZAH9002007	7" Pre-cut #18 Nylon Covered HD Cable/ten (10) per package	ZAH9002018
20' Spool #332 Nylon Covered Cable/Sold per spool	ZAH9000201	Retaining Washers for #18 Cable/keeps cable in place/fifty (50) per package	ZAH9000076
100' Spool #332 Nylon Covered Cable/Sold per spool	ZAH9000034	50' Spool #18 Nylon Covered Cable	ZAH9000083
100' Box #12 Duralink Cable (High Performance Cable)	ZAH9660000	7" Titan Vise Tool	ZAH9000217

ROUND BALERS

HANDY SERVICE PACKS

Application: RB454-RB464

- Kits include major components and attaching hardware • OE components • Handy service packs for shop or toolbox

RUBBER LATCH KIT

Part No. 87298971



APRON & CLUTCH DRIVE IDLER SPROCKET KIT (2-PACK)

Part No. 87298547



TRANSPORT WHEEL-BEARING KIT – STANDARD DUTY

PART NUMBER	QTY	DESCRIPTION
86900188	1	Cap
67526	1	Bearing Cup
87020635	1	Washer
67527	1	Bearing Cone
245856	1	Oil Seal
87398	1	Cotter Pin
199955	1	Bearing Cup
199954	1	Bearing Cone
603373	1	Nut



Components available individually
- Not sold as a kit

CAM FOLLOWER – 2MM PICKUP CURVED FINGER

PART NUMBER	QTY	DESCRIPTION
703960	16	Washer
86536275	8	Cam Follower
88130	8	Nut



Components available individually
- Not sold as a kit

CARRIER BEARING KIT – REEL BAR

PART NUMBER	QTY	DESCRIPTION
54695	6	Carrier
54770	6	Bearing



Components available individually
- Not sold as a kit

TWINE KNIFE KIT

PART NUMBER	QTY	DESCRIPTION
322357	4	Washer
617945	2	Knife Section
86512439	4	Bolt
9804278	4	Nut



Components available individually
- Not sold as a kit

BEARING KIT – NET WRAP ROLLER

PART NUMBER	QTY	DESCRIPTION
87017557	4	Flange
9804276	6	Nut
66006	2	Bearing
322357	6	Washer



Components available individually
- Not sold as a kit

KEEP THE UNEXPECTED FROM IMPACTING YOUR PRODUCTION.

Run your operation longer and stronger with a Shock Protection System Hub Kit. When your mower's blades come into contact with rocks, branches or other obstacles, the stress can damage your mower modules. These easy-to-install shock hubs minimize spline shear and eliminate cutter bar gear teeth failure if an obstacle is encountered. This cutting and baling season, Be Ready for the unexpected.



SHOCK PROTECTION SYSTEM HUB RETROFIT KIT

Part No. 87602273

The Shock Protection System Hub Retrofit Kit allows you to retrofit older-model mower conditioners. It includes a hub seal which prevents metal fines from entering module components and damaging them. Components and installation instructions are included for two modules.

Application: DCX91, DCX101, DCX131, DCX161, MDX71, MDX81, MDX91, RDX131, RDX161, RDX181



SHOCK PROTECTION SYSTEM HUB REPAIR KIT

Part No. 87580643

The Shock Protection System Hub Repair Kit makes in-field repairs fast and easy. Components and installation instructions are included for one module.

Application: All models except RD163, RD193

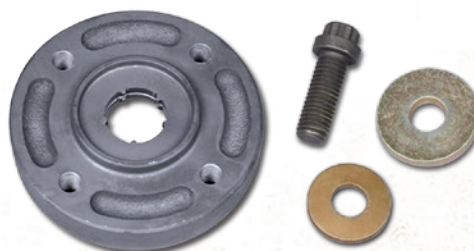

ROUND BALERS

HANDY SERVICE PACKS/MAINTENANCE KITS

DIMPLE ROLL TO SLEDGE KIT (RH)

PART NUMBER	QUANTITY	DESCRIPTION
47471	1	Key, woodruff
80353711	1	Key
86610109	1	Sprocket
86621149	1	Chain
87017555	1	Sprocket
140045	2	Washer

Components available individually - Not sold as a kit



STARTER ROLL DRIVE KIT

PART NUMBER	QUANTITY	DESCRIPTION
66614	1	Sprocket - 13T
9804061	1	Chain
140046	1	Washer
694478	1	Washer
86613346	1	Sprocket, Double

Components available individually - Not sold as a kit

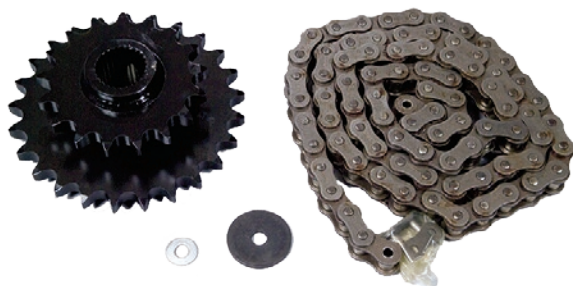

IDLER SPROCKET KIT

Application: RB454, RB464
Part No. 87298552



BEARING KIT – ROLLER TAILGATE NOSE (2-PACK)

Application: RB454, RB464
Part No. 87298538



BEARING KIT – TOP TAILGATE ROLLER (2-PACK)

Application: RB454, RB464
Part No. 87298539





OVERHAUL THE OLD BEAST

Case IH tractors are built to last, but appreciate a little TLC now and then – just like us. Introducing new **Case IH Engine Overhaul Kits**.

- High quality components, competitively priced
- Ready to assemble, pre-built parts
- Comprehensive range of kits available

Breathe new life into your classic Case IH combine or tractor with genuine Case IH parts.

Visit your Case IH dealer or go to www.caseihparts.com.au today.

CASE IH
AGRICULTURE

ACCESSORIES & MAINTENANCE

CASE IH WAECO ICEBOXES

GET YOUR HANDS ON AN AUTHENTIC CASE IH BRANDED ICEBOX

Features include:

- Thick polyurethane refrigeration grade foam insulation
- Lightweight, Hygienic and Easy to clean
- Extremely low heat absorption
- Integrated tie-down points
- Strong, ergonomic polyethylene handles



WCI-22CASE
22 litre icebox



WCI-55CASE
55 litre icebox



WCI-70CASE
68 litre icebox

BATTERIES

EXTENSIVE RANGE OF BATTERIES, BUILT TOUGH FOR THE HEAVIEST APPLICATIONS

Case IH gives you access to a wide range of different battery technologies and storage solutions that are designed to fit your needs.

- Perfect for: camping, caravanning, motor homes, plant and equipment and marine
- High performance starting power
- High reserve capacity
- Maintenance accessible easy fill vents



FILTERS

THE SUPERIOR PROTECTION OF CASE IH FILTERS

A filter's purpose is to extend the life of your equipment by protecting it from harmful contaminants.

Lower-quality filters may save you some money at the counter, but their inferior protection can cost you greatly in the long run.

Case IH filters offer advanced design and durable construction that is rigorously tested by CNH Engineering the best heavy-duty protection for your equipment.

- Oil Filters
- Fuel Filters
- Hydraulic Filters
- Air Filters



A young boy in a white polo shirt is driving a red Case IH tractor in a park. Two other children are nearby, one on a swing and another on a different tractor. The background shows trees and a brick wall.

HOURS OF FUN FOR ALL THE KIDS

Case IH Toys, Ride-ons and Replicas - Collect or Play

A variety of Case IH toys and replicas are displayed on a brick wall. The collection includes several red tractors of different sizes, a yellow tractor, a red dump truck, a red semi-truck, and a white truck. A yellow bucket is also visible.

CASE IH
AGRICULTURE

For more information contact your Case IH dealer today or go to www.caseihparts.com.au

TIME TO GET THINGS PUMPING

Discover the benefits of Case IH Irrigation Engines:

- Transportable: Take the engine wherever it's needed
- Easy Install: No infrastructure, approvals, electricians or backup power required
- Versatile: Customisable with silencers, weather protection and more
- Reliable: No interruption in blackouts - our engines keep powering on



We've got an engine to suit your irrigation needs:

- 4-cylinder or 6-cylinder
- 85 hp (66 kW) @ 2200 rpm through 240 hp (175 kW)
- Warranty 2 years / 2000 hours (whichever occurs first)

See your local Case IH dealer, or visit caseihparts.com.au for more info.

