

ML23

SMALL ARTICULATED LOADER



OPERATING WEIGHT	
Open cab	5,181 lb. (2350 kg)

OVERALL DIMENSIONS	
Overall height	90.6 in. (2300 mm)
Overall length:	
Without bucket	123.8 in. (3145 mm)
Machine width	48.4 in. (1230 mm)

LOADER PERFORMANCE SPECS	
Lifting height	96.5 in. (2450 mm)
Tipping load (ISO) – Straight	4,982 lb. (2260 kg)
Lifting capacity	4,850 lb. (2200 kg)

ELECTRICAL	
System voltage	12 volts
Alternator	60 amp
Battery	52 AHR 520 cold-cranking amps

ENGINE	
Model	Kubota V1505
Emissions certification	Tier 4 Final Certified
Cylinders	4
Displacement	91.4 in. ³ (1,498 L)
Fuel	Diesel
Exhaust aftertreatment	—
Engine speeds	RPM
Rated – full load	2,300
Horsepower @ 2,300 RPM – SAE J1349:	
Gross	26 hp (19.4 kW)
Peak torque @ 2,200 RPM	68.3 lb-ft (92.6 N·m)

DRIVETRAIN	
Transmission type	Hydrostatic
Differential type	Limited slip
Parking brake:	
Type	Drum
Max. travel speed	12.4 mph (20 kph)

— Not available.

HYDRAULICS	
Control valve type	Open center
Pump type	Fixed gear
Driving hydraulics:	
Flow rate	17.2 gpm (65 L/min)
Operating pressure	5,200 psi (360 bar)
Working Hydraulics:	
Total flow rate	8.5 gpm (32 L/min)
Operating pressure	3,000 psi (210 bar)
Auxiliary 1:	
Max. flow rate	8.5 gpm (32 L/min)
Pressure	3,000 psi (210 bar)
Auxiliary 2 — optional:	
Max. flow rate	8.5 gpm (32 L/min)
Pressure	3,000 psi (210 bar)
Continuous flow — optional:	
Max. flow rate	10.0 gpm (38 L/min)
Pressure	3,000 psi (210 bar)

SERVICE CAPACITIES	
Fuel tank	9.8 gal. (37 L)
Engine oil w/ filter	5.4 qt. (5.1 L)
Hydraulic system	14.8 gal. (56 L)
Engine coolant	1.1 gal. (4.4 L)

Standard Equipment

Operator Environment

- ROPS/FOPS safety roof
- Safety entry bar
- Key start
- Mechanical suspension vinyl seat
- Armrests
- Retractable seat belt
- Exterior mirrors

Engine

- Glow plug starting aid
- Engine block heater
- Locking fuel cap
- Cyclone air filter

Drivetrain

- Hydrostatic 4-wheel drive
- FNR control on joystick
- Limited slip axles
- Drum brakes

Hydraulics

- 3-spool main control valve
- 1x dual acting auxiliary hydraulics
- Attachment case drain return
- Loader arm float
- Oil cooler

Loader

- Standard lift path
- Mechanical self leveling
- Loader lift arm support strut
- SSL compatible attachment coupler
- Additional counterweights

Electrical

- 12 volt system
- 52 AHR, 520 CCA battery
- 60 A alternator
- 2 front cab work lights
- Remote jumpstart provision
- Battery disconnect switch

Other Standard Features

- Tow coupling
- Backup alarm
- Horn

Warranty

- Base warranty coverage: 2-Year/1,000-Hour Full Machine Limited Warranty

Optional Equipment

Operator Environment

- Fold-able open ROPS
- Enclosed cab with heat
- Air suspension seat

Engine

- Hand throttle

Drivetrain

- Hand inching creep control

Hydraulics

- 2x dual acting auxiliary hydraulics
- Auxiliary hydraulic hold function
- Continuous flow auxiliary hydraulics
- Hydraulic boom suspension (ride control)

Electrical

- 1 boom worklight
- 2 cab rear work lights
- 3-pin electrical auxiliary connection
- Rotating beacon light
- Strobe light

Other

- English, Spanish, or French operator manual

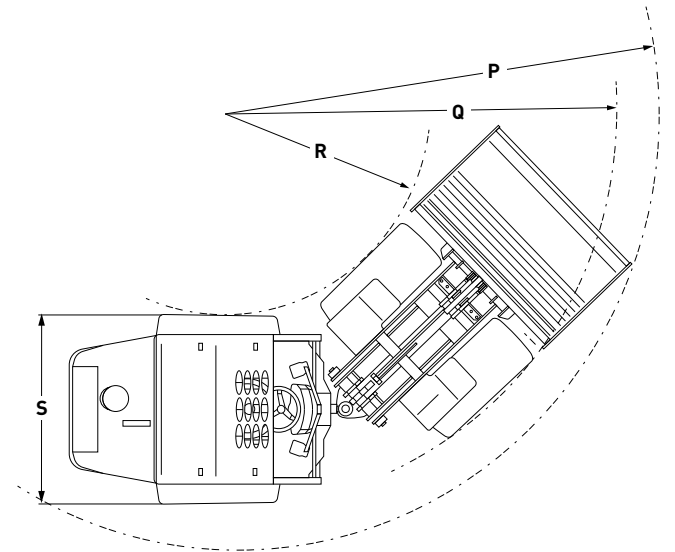
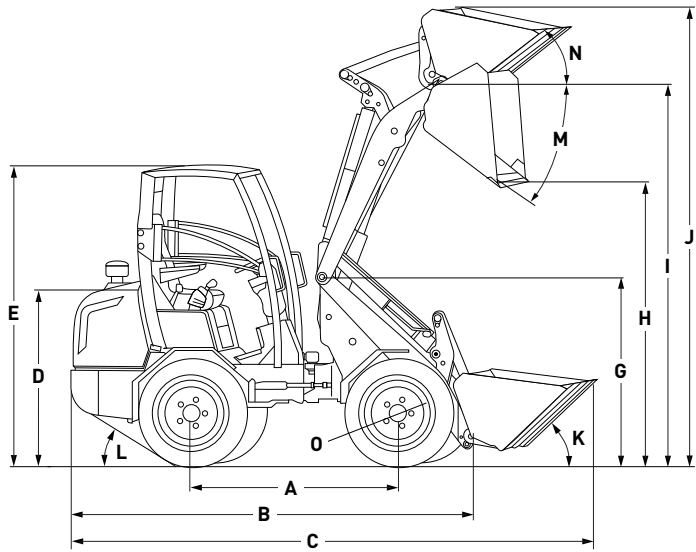

DIMENSIONS

A	Wheelbase	62.2 in. (1580 mm)
B	Total length	123.8 in. (3145 mm)
C	Length with bucket	150.8 in. (3830 mm)
D	Seat height	49.4 in. (1256 mm)
E	Max. height with safety roof	90.6 in. (2300 mm)
F	Max. height with cabin	89.9 in. (2284 mm)
G	Height front frame	49.2 in. (1250 mm)
H	Max. dumping height	66.1 in. (1680 mm)
I	Lifting height	96.5 in. (2450 mm)
J	Height with bucket	119.7 in. (3040 mm)
K	Rollback angle on the ground	41°
L	Rollback angle at max. lift height	46°
M	Max. dumping angle	37°
N	Max. loading angle	29°
O	Outer size of tires	29.9 in. (760 mm)
P	Maximum radius external	42.5 in. (1080 mm)
Q	Turning radius on outer edge	104.3 in. (2650 mm)
R	Inner turning radius	92.2 in. (2342 mm)
S	Width on standard tires	48.4 in. (1230 mm)

TIPPING LOADS

T	4,980 lb. (2260 kg)
U	3,840 lb. (1740 kg)
V	2,770 lb. (1255 kg)
W	2,060 lb. (935 kg)
X	6,490 lb. (2945 kg)
Y	3,860 lb. (1750 kg)
Z	2,710 lb. (1230 kg)

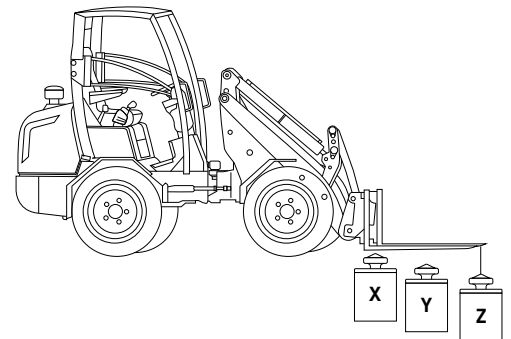
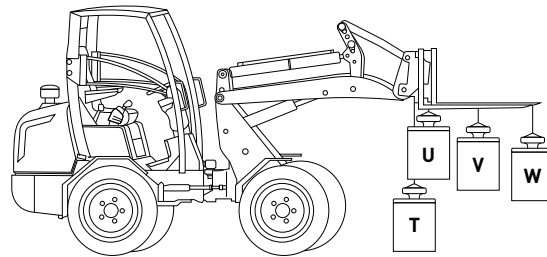

Line drawings are for illustrative purpose only and may not be exact representation of unit.



New Holland Construction
500 Diller Ave.
New Holland, PA 17557

Learn more at www.newholland.com



Design, materials and/or specifications are subject to change without notice and without liability therefor. Specifications are applicable to units sold in Canada, the United States, its territories and possessions, and may vary outside these areas.

© 2023 CNH Industrial America LLC. All rights reserved. New Holland is a trademark registered in the United States and many other countries, owned by or licensed to CNH Industrial N.V., its subsidiaries or affiliates. Any trademarks referred to herein, in association with goods and/or services of companies, other than owned by or licensed to CNH Industrial N.V., its subsidiaries or affiliates, are the property of those respective companies.



Safety begins with a thorough understanding of the equipment. Always make sure you and your operators read the Operator's Manual before using the equipment. Pay close attention to all safety and operating decals and never operate machinery without all shields, protective devices and structures in place.

NHC7130238305 • 0923 • OTP • PRINTED IN U.S.A.